

# Tillable Soils Map

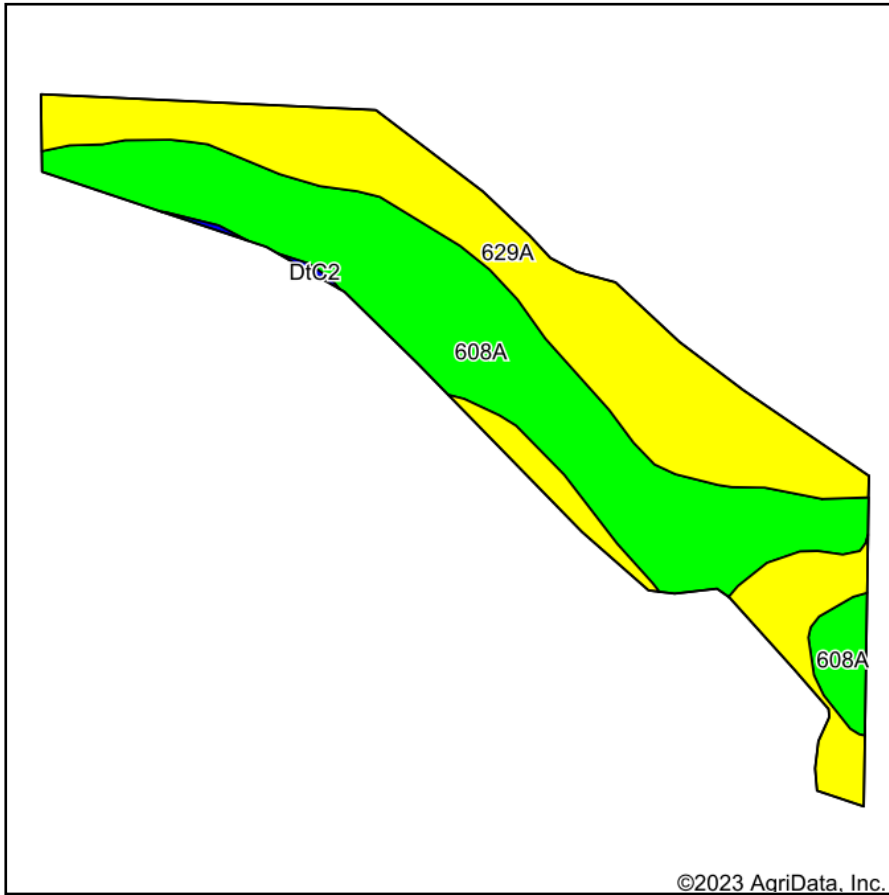

Soils data provided by USDA and NRCS.

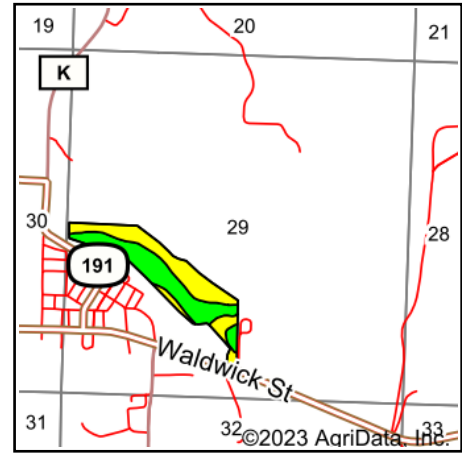

State: **Wisconsin**  
 County: **Iowa**  
 Location: **29-5N-5E**  
 Township: **Hollandale**  
 Acres: **38.84**  
 Date: **1/17/2023**



Maps Provided By:



© AgriData, Inc. 2021

www.AgriDataInc.com



Area Symbol: WI049, Soil Area Version: 17

Code	Soil Description	Acres	Percent of field	NCCPI Overall Legend	Non-Irr Class	*n NCCPI Overall
608A	Lawson silt loam, 0 to 3 percent slopes, occasionally flooded	19.61	50.5%		IIIw	87
629A	Ettrick silt loam, 0 to 2 percent slopes, frequently flooded	19.11	49.2%		Vlw	52
DtC2	Palsgrove silt loam, 6 to 12 percent slopes, moderately eroded	0.12	0.3%		IIIe	74
<b>Weighted Average</b>					<b>4.48</b>	<b>*n 69.7</b>

\*n: The aggregation method is "Weighted Average using all components"  
 Soils data provided by USDA and NRCS.