

Soils Map - Total Acres

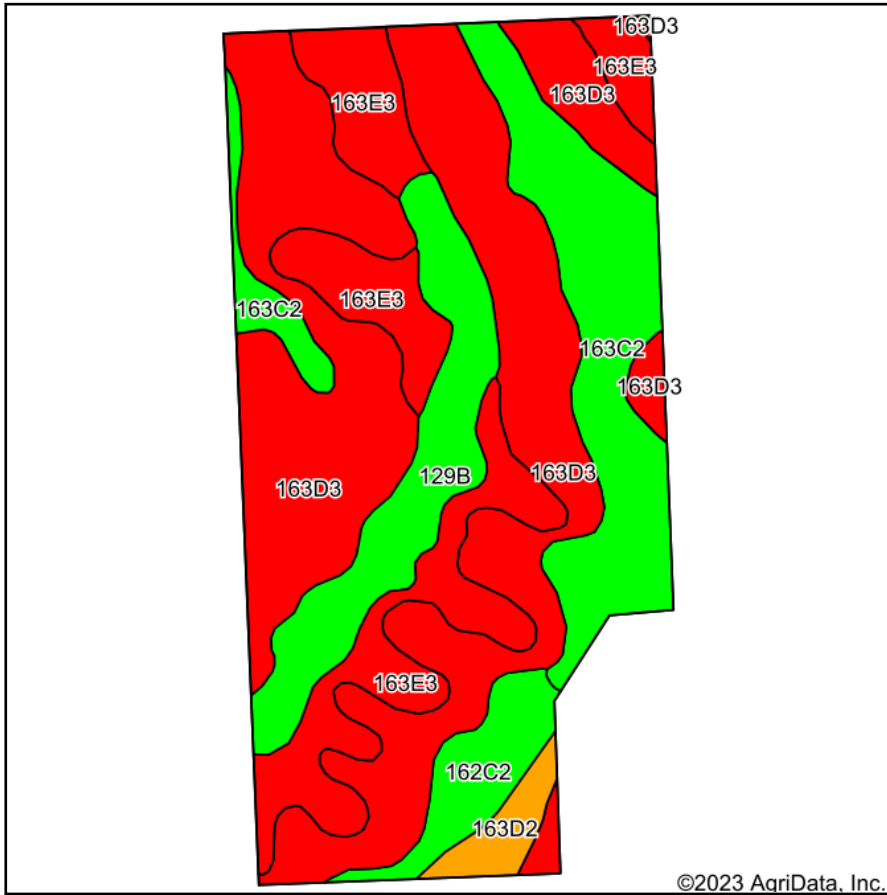

Soils data provided by USDA and NRCS.

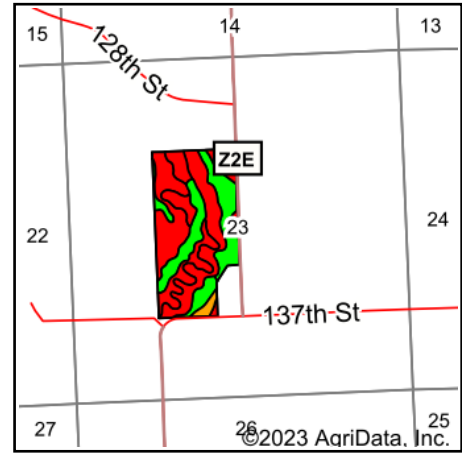

State: **Iowa**
 County: **Clinton**
 Location: **23-83N-4E**
 Township: **Waterford**
 Acres: **72**
 Date: **3/6/2023**



Maps Provided By:



Area Symbol: IA045, Soil Area Version: 28

Code	Soil Description	Acres	Percent of field	CSR2 Legend	Non-Irr Class *c	*i Corn Bu	*i Alfalfa Tons	*i Soybeans Bu	CSR2**	*n NCCPI Overall	
163D3	Fayette silty clay loam, 9 to 14 percent slopes, severely eroded	33.00	45.8%		IVe	153.6	4.3	44.5	40	73	
163E3	Fayette silty clay loam, 14 to 18 percent slopes, severely eroded	13.59	18.9%		VIe	129.6	3.6	37.6	29	70	
163C2	Fayette silt loam, 5 to 9 percent slopes, moderately eroded	12.55	17.4%		IIIe	193.6	5.4	56.1	72	81	
129B	Arenzville-Chaseburg complex, 1 to 5 percent slopes	7.69	10.7%		IIw	0.0	0.0	0.0	73	85	
162C2	Downs silt loam, 5 to 9 percent slopes, moderately eroded	3.25	4.5%		IIIe	198.4	5.6	57.5	80	85	
163D2	Fayette silt loam, 9 to 14 percent slopes, moderately eroded	1.51	2.1%		IIIe	164.8	4.6	47.8	46	78	
163E2	Fayette silt loam, 14 to 18 percent slopes, moderately eroded	0.41	0.6%		IVe	140.8	3.9	40.8	35	74	
Weighted Average						3.92	141.8	4	41.1	48.9	*n 75.8

**IA has updated the CSR values for each county to CSR2.

*i Yield data provided by the ISPAID Database version 8.1.1 developed by IA State University.

*n: The aggregation method is "Weighted Average using all components"

*c: Using Capabilities Class Dominant Condition Aggregation Method

Soils data provided by USDA and NRCS.