

Soils Map - Total Acres

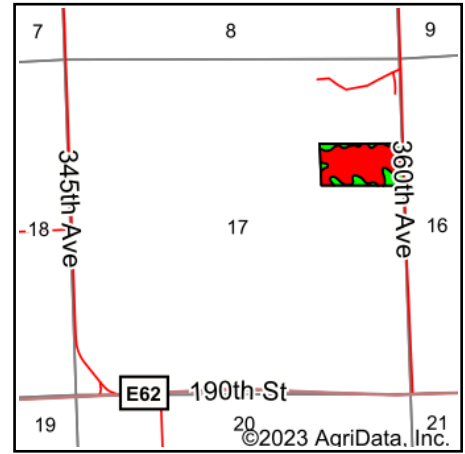

State: **Iowa**
 County: **Clinton**
 Location: **17-82N-5E**
 Township: **Center**
 Acres: **20**
 Date: **3/31/2023**

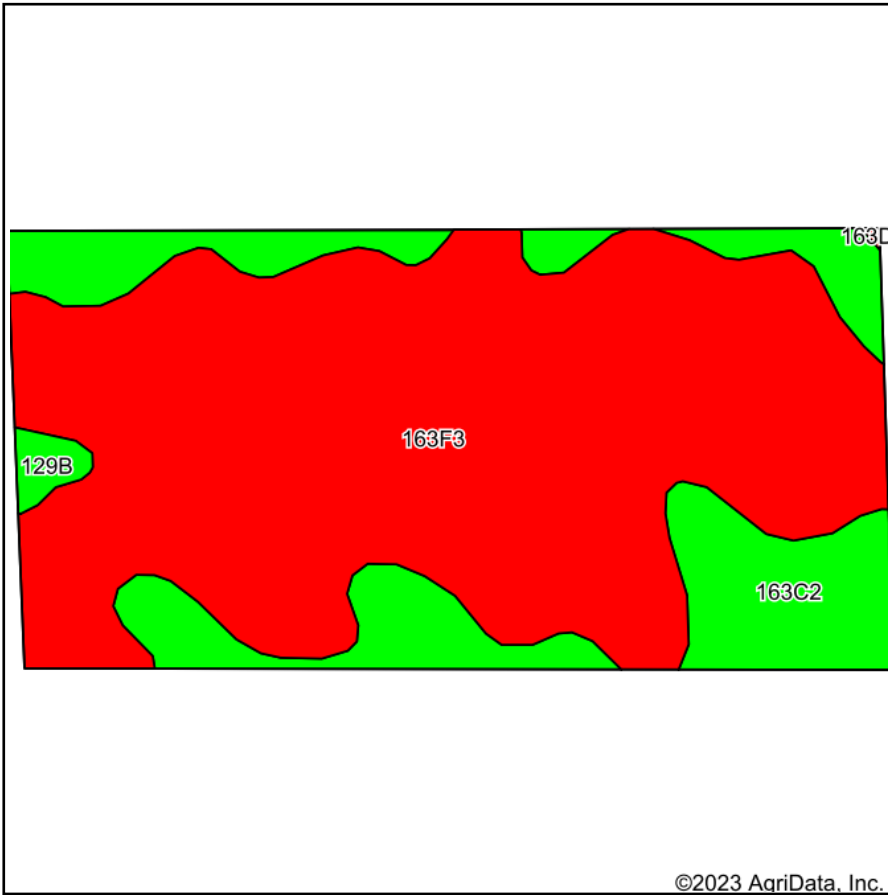

Maps Provided By:



© AgriData, Inc. 2023

www.AgriDataInc.com



Soils data provided by USDA and NRCS.

©2023 AgriData, Inc.

Area Symbol: IA045, Soil Area Version: 28

Code	Soil Description	Acres	Percent of field	CSR2 Legend	Non-Irr Class *c	*i Corn Bu	*i Alfalfa Tons	*i Soybeans Bu	CSR2**	*n NCCPI Overall
163F3	Fayette silty clay loam, 18 to 25 percent slopes, severely eroded	15.18	75.9%		Vllc	105.6	3.0	30.6	12	56
163C2	Fayette silt loam, 5 to 9 percent slopes, moderately eroded	4.60	23.0%		lllc	193.6	5.4	56.1	72	81
129B	Arenzville-Chaseburg complex, 1 to 5 percent slopes	0.22	1.1%		llw	0.0	0.0	0.0	73	85
Weighted Average						6.02	124.7	3.5	26.5	*n 62.1

**IA has updated the CSR values for each county to CSR2.

*i Yield data provided by the ISPAID Database version 8.1.1 developed by IA State University.

*n: The aggregation method is "Weighted Average using all components"

*c: Using Capabilities Class Dominant Condition Aggregation Method

Soils data provided by USDA and NRCS.