

Total Soils Map

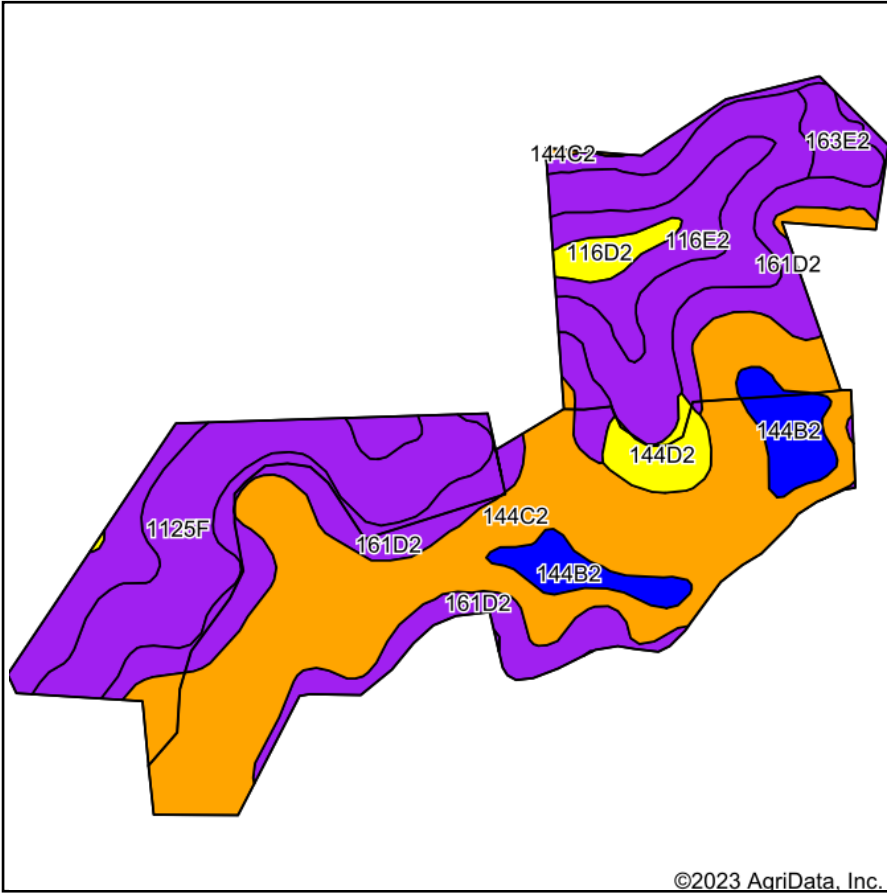

Soils data provided by USDA and NRCS.

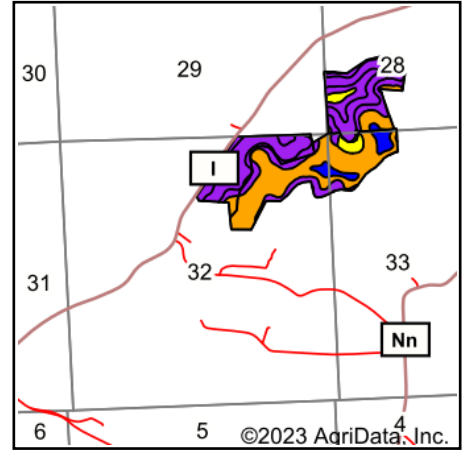

State: **Wisconsin**
 County: **Richland**
 Location: **32-12N-2E**
 Township: **Westford**
 Acres: **137.75**
 Date: **5/4/2023**



Maps Provided By:



© AgriData, Inc. 2023

www.AgriDataInc.com



Area Symbol: WI103, Soil Area Version: 18

Code	Soil Description	Acres	Percent of field	Non-Irr Class Legend	Non-Irr Class *c	*n NCCPI Overall
144C2	Newglarus silt loam, deep, 6 to 12 percent slopes, moderately eroded	49.70	36.1%		IIIe	67
1125F	Dorerton, very stony-Elbaville complex, 30 to 60 percent slopes	33.79	24.5%		VIIe	13
161D2	Fivepoints silt loam, 12 to 20 percent slopes, moderately eroded	26.08	18.9%		VIe	51
116E2	Churchtown silt loam, 20 to 30 percent slopes, moderately eroded	13.37	9.7%		VIe	20
144B2	Newglarus silt loam, deep, 2 to 6 percent slopes, moderately eroded	6.96	5.1%		IIe	68
144D2	Newglarus silt loam, deep, 12 to 20 percent slopes, moderately eroded	3.11	2.3%		IVe	61
163E2	Elbaville silt loam, 20 to 30 percent slopes, moderately eroded	2.63	1.9%		VIe	17
116D2	Churchtown silt loam, 12 to 20 percent slopes, moderately eroded	2.11	1.5%		IVe	75
Weighted Average					4.89	*n 45.2

*n: The aggregation method is "Weighted Average using all components"

*c: Using Capabilities Class Dominant Condition Aggregation Method

Soils data provided by USDA and NRCS.