

Soils Map

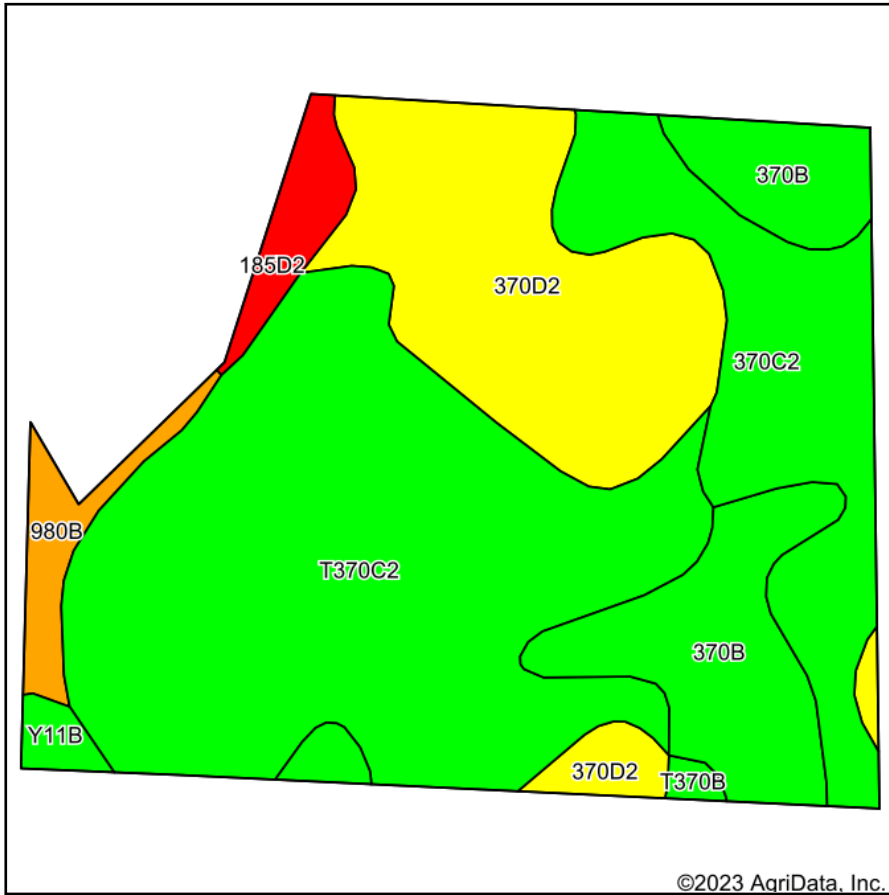

Soils data provided by USDA and NRCS.

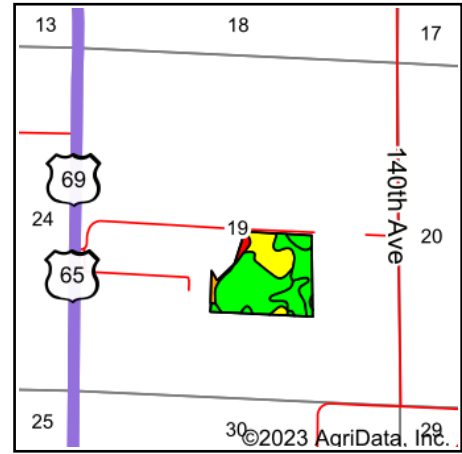

State: **Iowa**
 County: **Warren**
 Location: **19-77N-23W**
 Township: **Allen**
 Acres: **40.06**
 Date: **5/23/2023**



Maps Provided By:



© AgriData, Inc. 2023

www.AgriDataInc.com



Area Symbol: IA181, Soil Area Version: 28

Code	Soil Description	Acres	Percent of field	CSR2 Legend	Non-Irr Class *c	*i Corn Bu	*i Soybeans Bu	CSR2**	CSR	*n NCCPI Overall	*n NCCPI Corn	*n NCCPI Soybeans
T370C2	Sharpsburg silty clay loam, terrace, 5 to 9 percent slopes, eroded	17.04	42.5%		IIIe	80.0	23.2	79	67	81	81	65
370D2	Sharpsburg silty clay loam, 9 to 14 percent slopes, eroded	8.36	20.9%		IIIe	176.0	51.0	54	57	77	77	60
370C2	Sharpsburg silty clay loam, 5 to 9 percent slopes, eroded	6.35	15.9%		IIIe	204.8	59.4	80	67	82	82	65
370B	Sharpsburg silty clay loam, 2 to 5 percent slopes	5.34	13.3%		Ile	225.6	65.4	91	87	92	92	79
980B	Gullied land-Ely-Colo, occasionally flooded, complex, 2 to 5 percent slopes	1.09	2.7%		VIle	88.0	25.5	42	25	10	10	9
185D2	Bauer silt loam, 9 to 14 percent slopes, moderately eroded	1.03	2.6%		VIe	124.8	36.2	15	20	45	45	24
Y11B	Colo, occasionally flooded-Ely silty clay loams, dissected till plain, 2 to 5 percent slopes	0.69	1.7%		IIw	0.0	0.0	80		87	86	81
T370B	Sharpsburg silty clay loam, terrace, 2 to 5 percent slopes	0.16	0.4%		Ile	225.6	65.4	91	87	90	90	77
Weighted Average					3.03	139.8	40.5	73	*	*n 79.1	*n 79.1	*n 63.6

**IA has updated the CSR values for each county to CSR2.

*- CSR weighted average cannot be calculated on the current soils data, use prior data version for csr values.

*i Yield data provided by the ISPAID Database version 8.1.1 developed by IA State University.

*c: Using Capabilities Class Dominant Condition Aggregation Method

*n: The aggregation method is "Weighted Average using all components"

Soils data provided by USDA and NRCS.