

# Soils Map - Tillable Acres

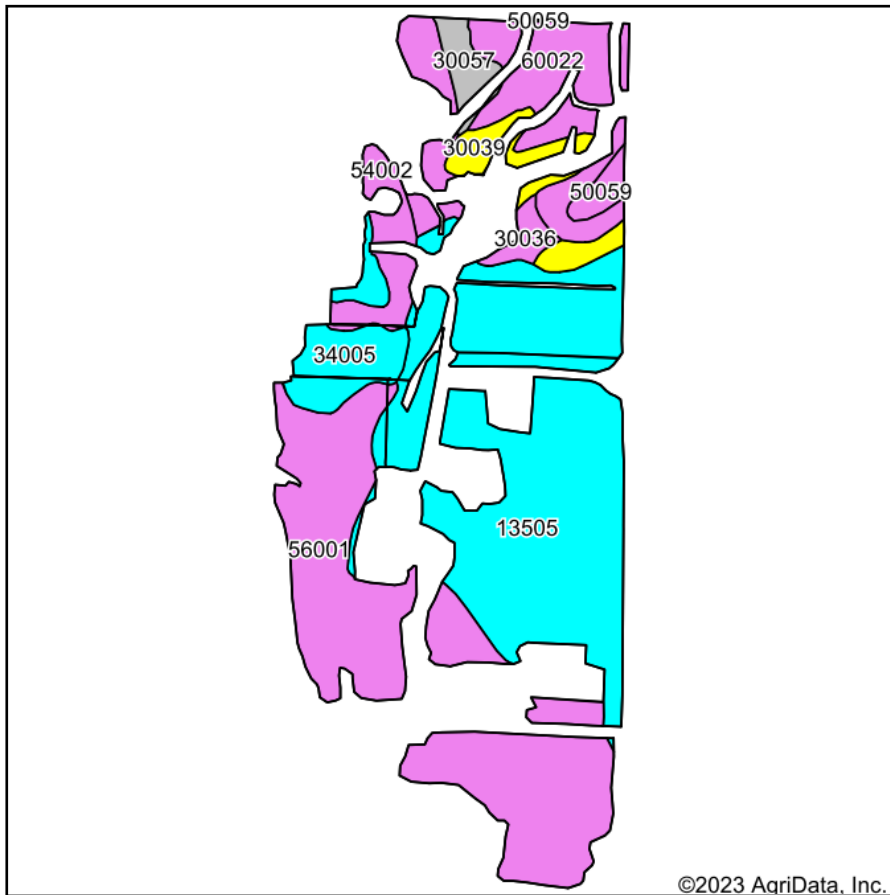

Soils data provided by USDA and NRCS.

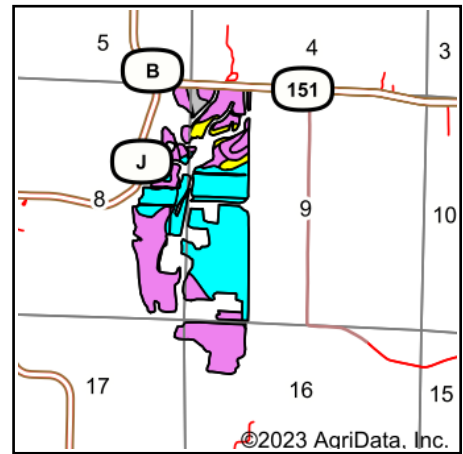

State: **Missouri**  
 County: **Monroe**  
 Location: **9-55N-12W**  
 Township: **Woodlawn**  
 Acres: **222.12**  
 Date: **5/31/2023**



Maps Provided By:



Area Symbol: MO137, Soil Area Version: 23

Code	Soil Description	Acres	Percent of field	Non-Irr Class Legend	Non-Irr Class *c	*n NCCPI Overall
13505	Blackoar silt loam, 0 to 2 percent slopes, occasionally flooded	86.65	39.0%		IIw	77
56001	Piopolis silty clay loam, 0 to 2 percent slopes, occasionally flooded	76.46	34.4%		IIIw	77
60022	Leonard silt loam, 1 to 6 percent slopes, eroded	21.08	9.5%		IIIe	61
34005	Gifford silt loam, 2 to 5 percent slopes, rarely flooded	12.17	5.5%		Ile	75
54002	Gifford silt loam, 5 to 9 percent slopes, rarely flooded	8.14	3.7%		IIIe	74
30039	Armstrong loam, 9 to 14 percent slopes, eroded	8.07	3.6%		IVe	64
30057	Gara loam, 14 to 18 percent slopes	4.06	1.8%		VIe	68
30036	Armstrong loam, 5 to 9 percent slopes	2.82	1.3%		IIIe	55
50059	Mexico silt loam, 1 to 4 percent slopes, eroded	2.67	1.2%		IIIe	71
<b>Weighted Average</b>					<b>2.65</b>	<b>*n 74.3</b>

\*n: The aggregation method is "Weighted Average using all components"

\*c: Using Capabilities Class Dominant Condition Aggregation Method

Soils data provided by USDA and NRCS.