

Total Soils Map

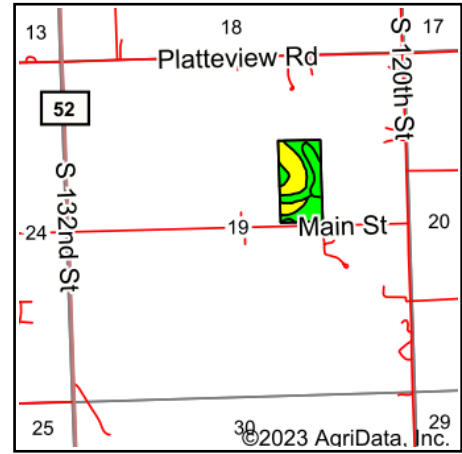

State: **Nebraska**
 County: **Sarpy**
 Location: **19-13N-12E**
 Township: **Platford-Springfield I**
 Acres: **19.2**
 Date: **6/6/2023**

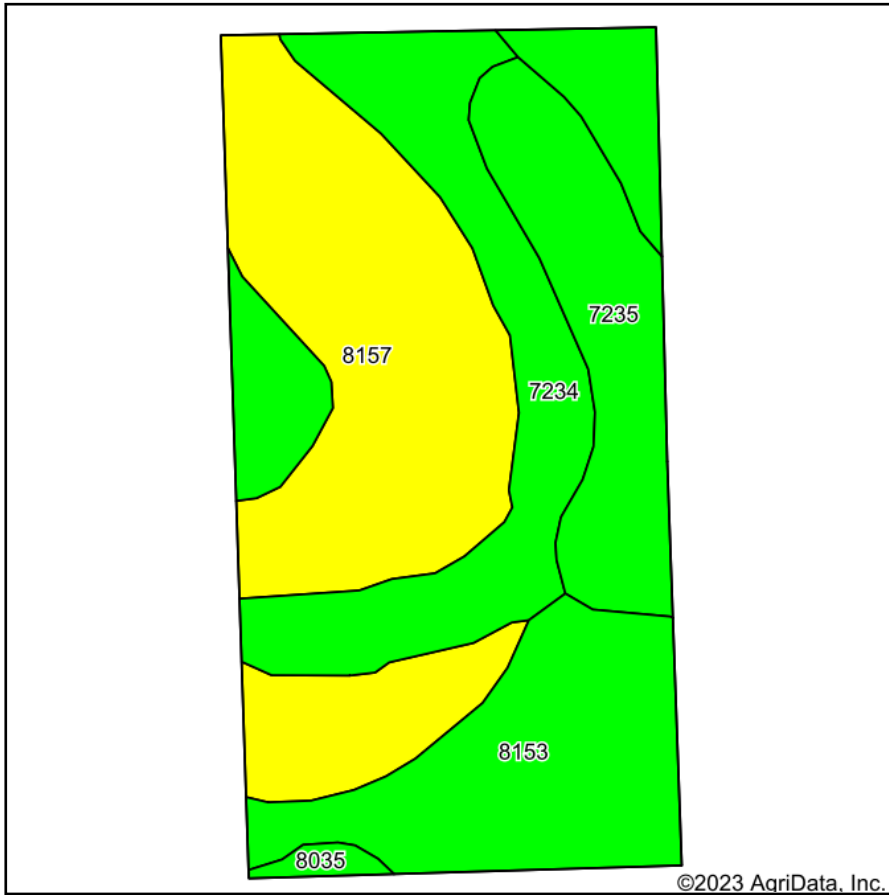

Maps Provided By:



Area Symbol: NE153, Soil Area Version: 16

Code	Soil Description	Acres	Percent of field	Non-Irr Class Legend	Non-Irr Class *c	Irr Class *c	SRPG	*n NCCPI Overall	
8157	Contrary-Monona-Ida complex, 6 to 17 percent slopes	7.17	37.3%			IVe	59	79	
8153	Contrary-Marshall silty clay loams, 6 to 11 percent slopes	5.26	27.4%			IIIe	67	88	
7234	Judson silty clay loam, 2 to 6 percent slopes	3.72	19.4%			IIe	73	95	
7235	Judson-Nodaway channeled-Contrary complex, 0 to 12 percent slopes	2.88	15.0%			IIe	56	62	
8035	Marshall-Contrary silty clay loams, 2 to 7 percent slopes	0.17	0.9%			IIe	73	92	
Weighted Average						3.02	*-	63.6	*n 82.1

*n: The aggregation method is "Weighted Average using all components"

*c: Using Capabilities Class Dominant Condition Aggregation Method

*- Irr Class weighted average cannot be calculated on the current soils data due to missing data.

Soils data provided by USDA and NRCS.