

Soils Map

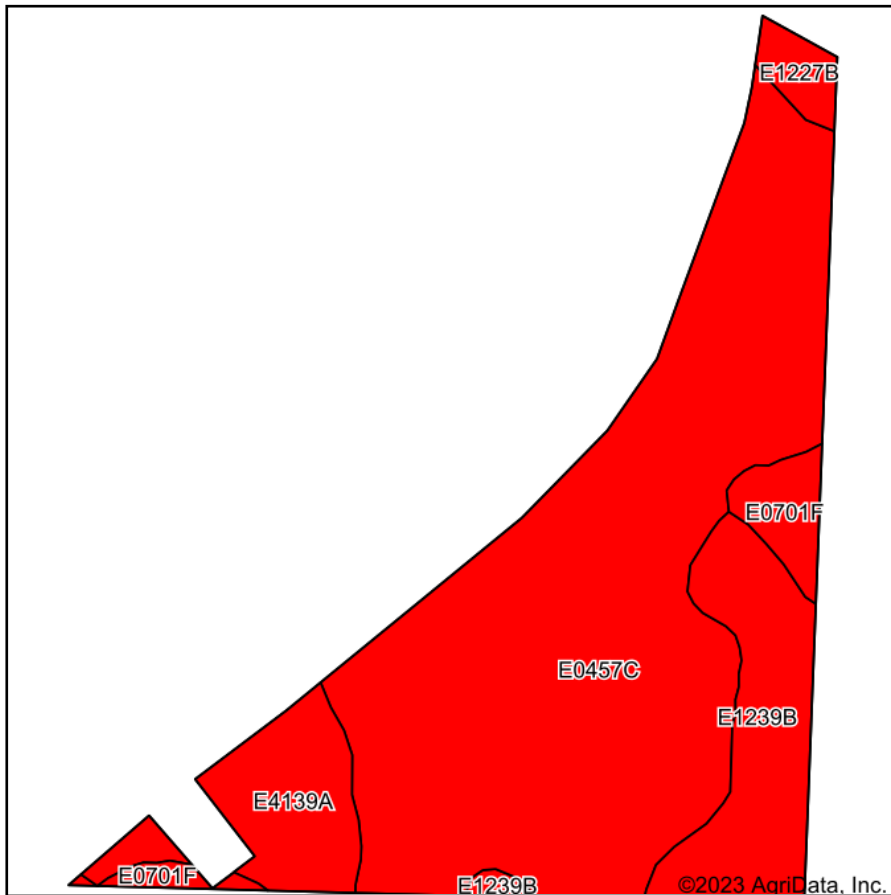

Soils data provided by USDA and NRCS.

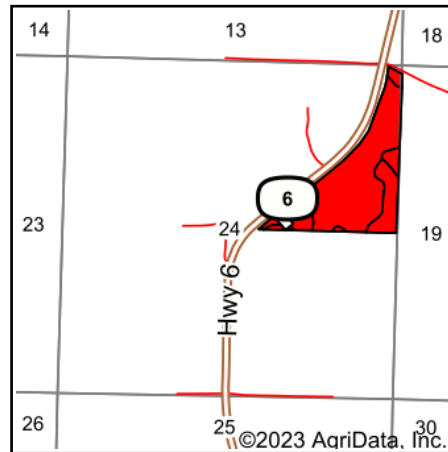

State: **North Dakota**
 County: **Morton**
 Location: **24-134N-82W**
 Township: **East Morton**
 Acres: **53.47**
 Date: **5/23/2023**



Maps Provided By:



Area Symbol: ND059, Soil Area Version: 25

Code	Soil Description	Acres	Percent of field	PI Legend	Non-Irr Class *c	Range Production (lbs/acre/yr)	Productivity Index	*n NCCPI Overall	*n NCCPI Corn	*n NCCPI Small Grains	*n NCCPI Soybeans	
E0457C	Rhoades-Daglum-Ekalaka fine sandy loams, 0 to 9 percent slopes	37.55	70.2%		VIs	1493	31	19	8	14	19	
E1239B	Ekalaka-Lakota fine sandy loams, 0 to 6 percent slopes	7.57	14.2%		IVs	1707	34	21	9	16	21	
E4139A	Korchea-Fluvaquents complex, channeled, 0 to 2 percent slopes, frequently flooded	5.00	9.4%		VIw	2852	43	14	6	7	14	
E0701F	Dogtooth-Janesburg-Cabba complex, 6 to 35 percent slopes	2.24	4.2%		VIIIs	1345	16	9	4	7	9	
E1227B	Desart-Ekalaka-Telfer complex, 0 to 6 percent slopes	1.11	2.1%		IVs	2290	46	23	10	17	23	
Weighted Average						5.72	1660.7	32.2	*n 18.5	*n 7.8	*n 13.4	*n 18.5

*n: The aggregation method is "Weighted Average using all components"

*c: Using Capabilities Class Dominant Condition Aggregation Method

Soils data provided by USDA and NRCS.