

Tillable Soils Map

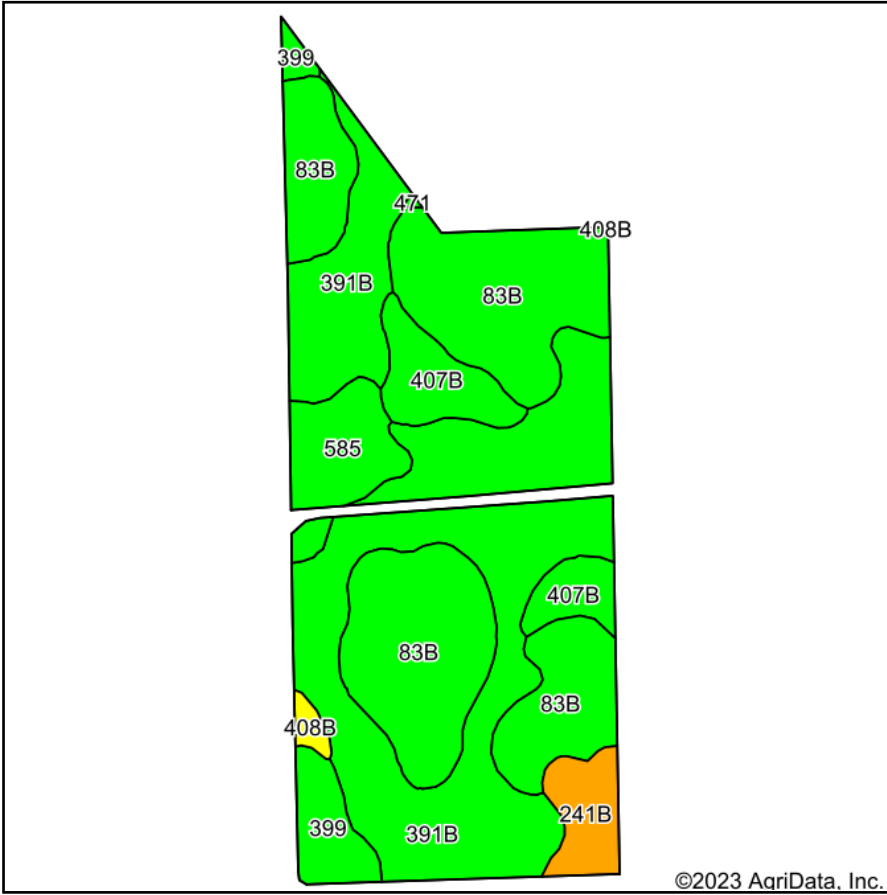

Soils data provided by USDA and NRCS.

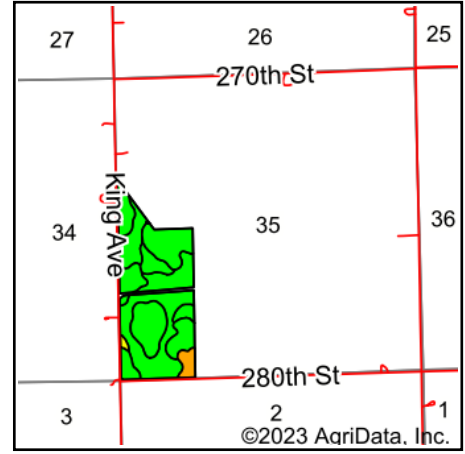

State: **Iowa**
 County: **Buchanan**
 Location: **35-88N-9W**
 Township: **Sumner**
 Acres: **82.85**
 Date: **4/5/2023**



Maps Provided By:



© AgriData, Inc. 2023

www.AgriDataInc.com



Area Symbol: IA019, Soil Area Version: 28

Code	Soil Description	Acres	Percent of field	CSR2 Legend	Non-Irr Class *c	CSR2**
391B	Clyde-Floyd complex, 1 to 4 percent slopes	35.23	42.5%		IIw	87
83B	Kenyon loam, 2 to 5 percent slopes	30.38	36.7%		IIe	90
407B	Schley loam, 1 to 4 percent slopes	5.63	6.8%		IIw	81
585	Coland-Spillville complex, 0 to 2 percent slopes, occasionally flooded	4.74	5.7%		IIw	70
399	Readlyn silt loam, 1 to 3 percent slopes	3.33	4.0%		Iw	91
241B	Burkhardt-Saude complex, 2 to 5 percent slopes	2.97	3.6%		IVe	33
408B	Olin sandy loam, 2 to 5 percent slopes	0.57	0.7%		IIe	64
Weighted Average					2.03	84.8

**IA has updated the CSR values for each county to CSR2.

*c: Using Capabilities Class Dominant Condition Aggregation Method

Soils data provided by USDA and NRCS.