

Total Soils Map

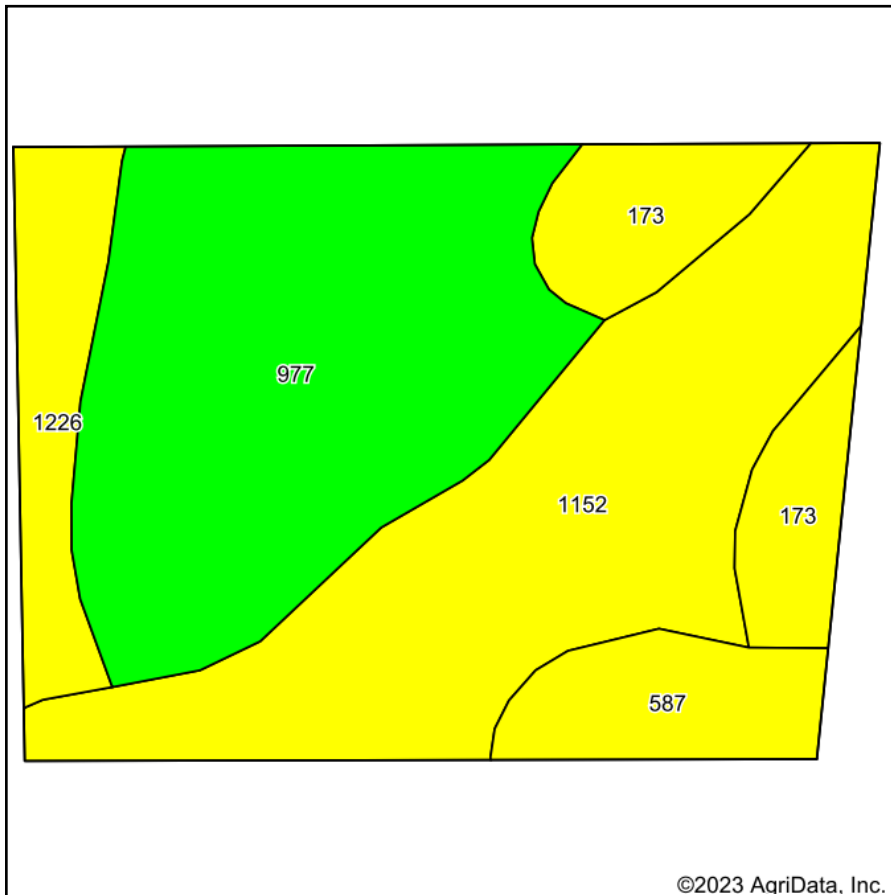

Soils data provided by USDA and NRCS.

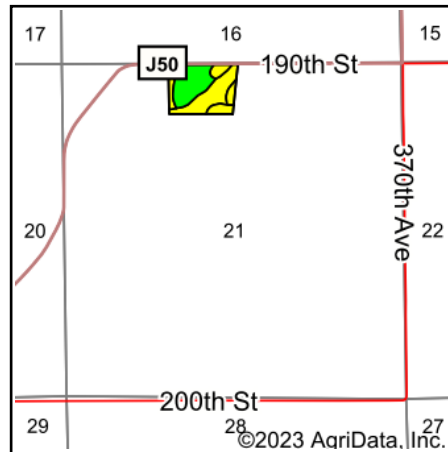

State: **Iowa**
 County: **Lee**
 Location: **21-68N-3W**
 Township: **Green Bay**
 Acres: **18.63**
 Date: **2/14/2023**



Maps Provided By:



Area Symbol: IA111, Soil Area Version: 31

Code	Soil Description	Acres	Percent of field	CSR2 Legend	CSR2**	CSR
977	Richwood silt loam, 0 to 2 percent slopes	7.23	38.8%		100	95
1152	Marshan clay loam, 0 to 2 percent slopes, rarely flooded	6.60	35.4%		54	72
173	Hoopeston sandy loam, 0 to 2 percent slopes	2.00	10.7%		61	60
1226	Lawler loam, 0 to 2 percent slopes, rarely flooded	1.49	8.0%		59	78
587	Chequest silty clay loam, 0 to 2 percent slopes	1.31	7.0%		66	65
Weighted Average					73.8	79.6

**IA has updated the CSR values for each county to CSR2.
 Soils data provided by USDA and NRCS.