

Tillable Soils Map

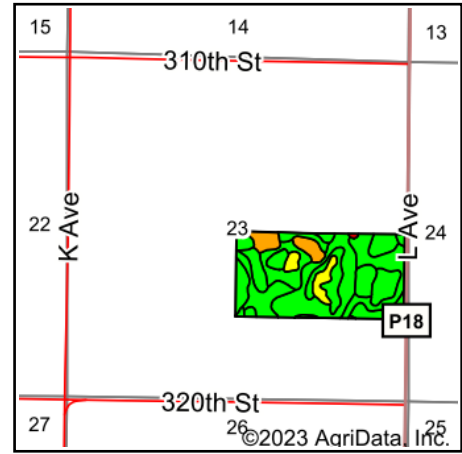

State: **Iowa**
 County: **Greene**
 Location: **23-82N-31W**
 Township: **Greenbrier**
 Acres: **78.3**
 Date: **6/1/2023**

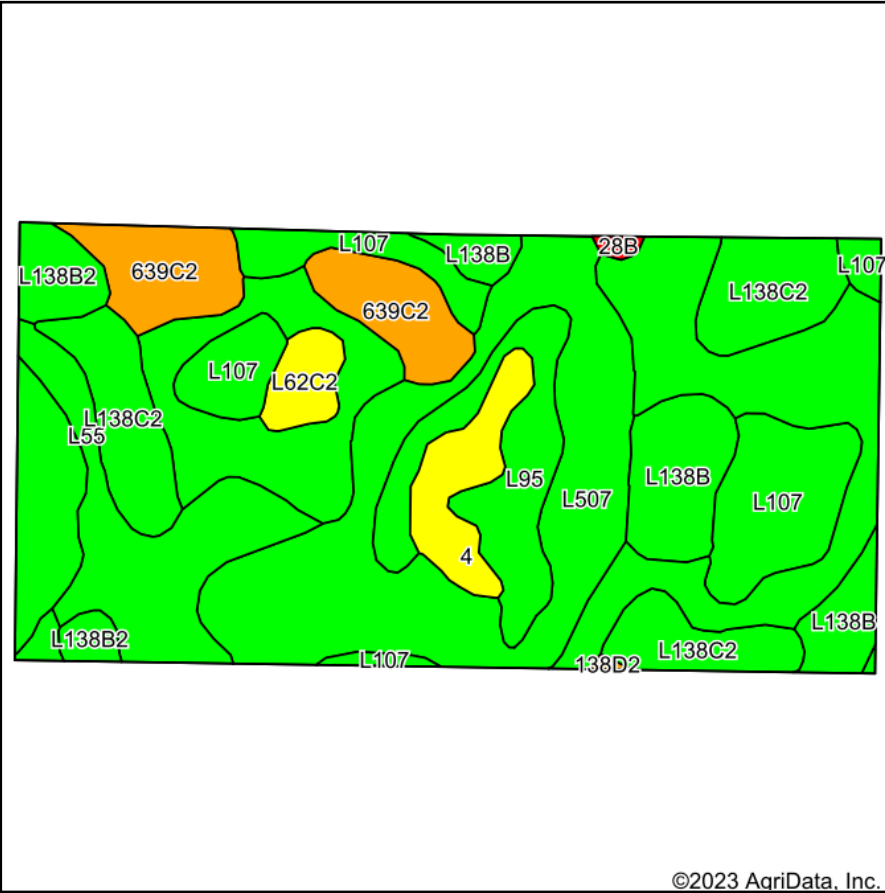

Soils data provided by USDA and NRCS.

©2023 AgriData, Inc.

Area Symbol: IA073, Soil Area Version: 28

Code	Soil Description	Acres	Percent of field	CSR2 Legend	Non-Irr Class *c	*i Corn Bu	*i Soybeans Bu	CSR2**	CSR	*n NCCPI Overall	
L507	Canisteo clay loam, Bemis moraine, 0 to 2 percent slopes	17.80	22.7%		llw	0.0	0.0	87		81	
L55	Nicollet loam, 1 to 3 percent slopes	16.03	20.5%		le	0.0	0.0	91		84	
L138B	Clarion loam, Bemis moraine, 2 to 6 percent slopes	11.06	14.1%		lle	220.8	64.0	88		79	
L107	Webster clay loam, Bemis moraine, 0 to 2 percent slopes	8.54	10.9%		llw	0.0	0.0	88		84	
L138C2	Clarion loam, Bemis moraine, 6 to 10 percent slopes, moderately eroded	8.09	10.3%		llle	0.0	0.0	83		65	
639C2	Salida-Storden complex, 5 to 9 percent slopes, moderately erode	5.40	6.9%		llle	80.0	23.2	46	24	49	
L95	Harps clay loam, Bemis moraine, 0 to 2 percent slopes	5.11	6.5%		llw	0.0	0.0	75		80	
4	Knoke silty clay loam, 0 to 1 percent slopes	2.68	3.4%		lllw	177.6	51.5	56	58	75	
L138B2	Clarion loam, Bemis moraine, 2 to 6 percent slopes, moderately eroded	2.03	2.6%		lle	0.0	0.0	85		70	
L62C2	Storden loam, Bemis moraine, 6 to 10 percent slopes, moderately eroded	1.30	1.7%		llle	0.0	0.0	64		66	
28B	Dickman sandy loam, 2 to 6 percent slopes	0.19	0.2%		llle	80.0	23.2	20	37	52	
138D2	Clarion loam, 9 to 14 percent slopes, moderately eroded	0.07	0.1%		llle	176.0	51.0	50	56	68	
Weighted Average						2.02	43.1	12.5	82.4	*-	*n 76.9

**IA has updated the CSR values for each county to CSR2.

*- CSR weighted average cannot be calculated on the current soils data, use prior data version for csr values.

*i Yield data provided by the ISPAID Database version 8.1.1 developed by IA State University.

*n: The aggregation method is "Weighted Average using all components"

*c: Using Capabilities Class Dominant Condition Aggregation Method

Soils data provided by USDA and NRCS.