

Total Soils Map

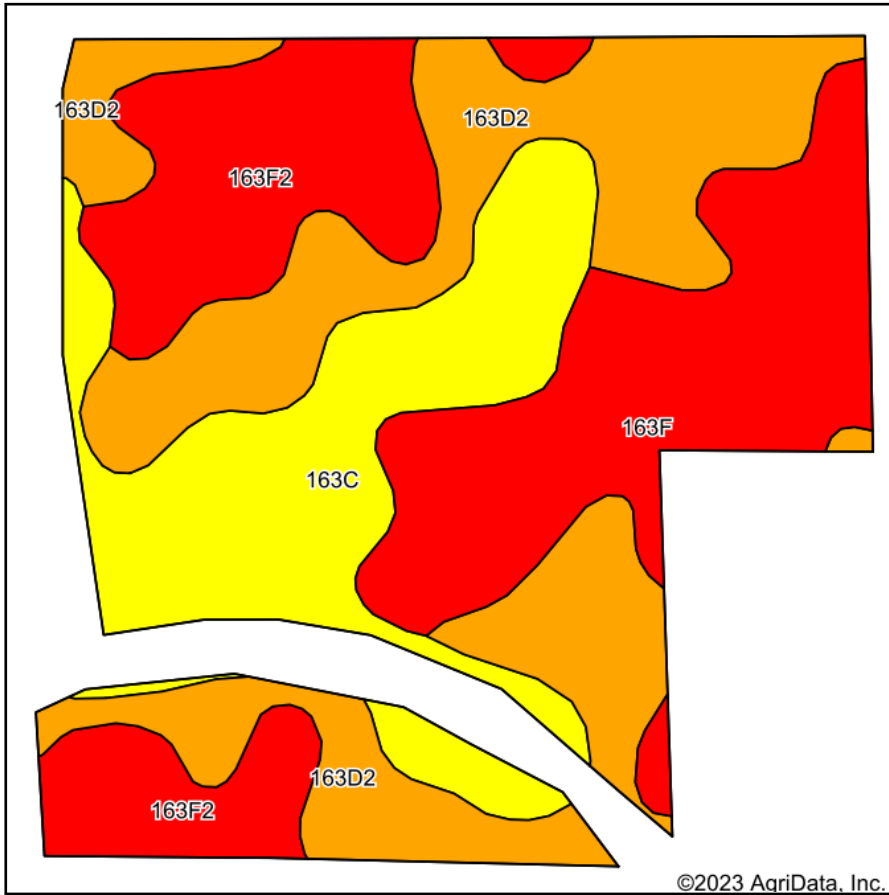

Soils data provided by USDA and NRCS.

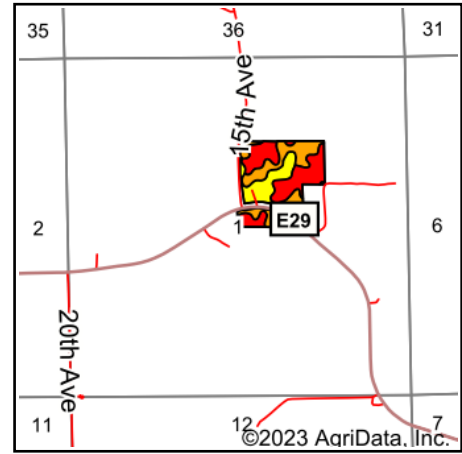

State: **Iowa**
 County: **Jones**
 Location: **1-84N-1W**
 Township: **Wyoming**
 Acres: **32.77**
 Date: **6/23/2023**



Maps Provided By:



Area Symbol: IA105, Soil Area Version: 27

Code	Soil Description	Acres	Percent of field	CSR2 Legend	Non-Irr Class *c	CSR2**	*n NCCPI Overall
163D2	Fayette silt loam, 9 to 14 percent slopes, moderately eroded	11.46	35.0%			IIIe	46
163C	Fayette silt loam, 5 to 9 percent slopes	7.52	22.9%			IIIe	75
163F	Fayette silt loam, 18 to 25 percent slopes	7.35	22.4%			VIe	21
163F2	Fayette silt loam, 18 to 25 percent slopes, moderately eroded	6.44	19.7%			VIe	18
Weighted Average						4.26	41.5
							*n 72.5

**IA has updated the CSR values for each county to CSR2.

*n: The aggregation method is "Weighted Average using all components"

*c: Using Capabilities Class Dominant Condition Aggregation Method

Soils data provided by USDA and NRCS.