

# FSA Tillable Soils Map

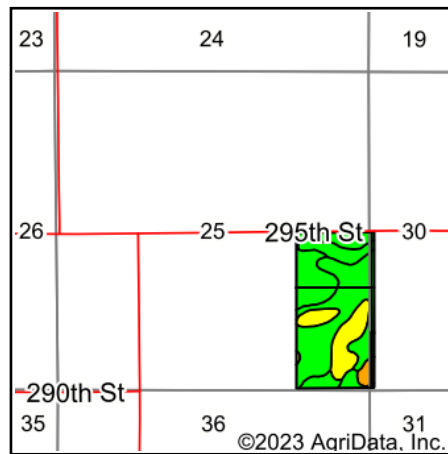

State: **Iowa**  
 County: **Cerro Gordo**  
 Location: **25-97N-19W**  
 Township: **Falls**  
 Acres: **77.4**  
 Date: **7/7/2023**

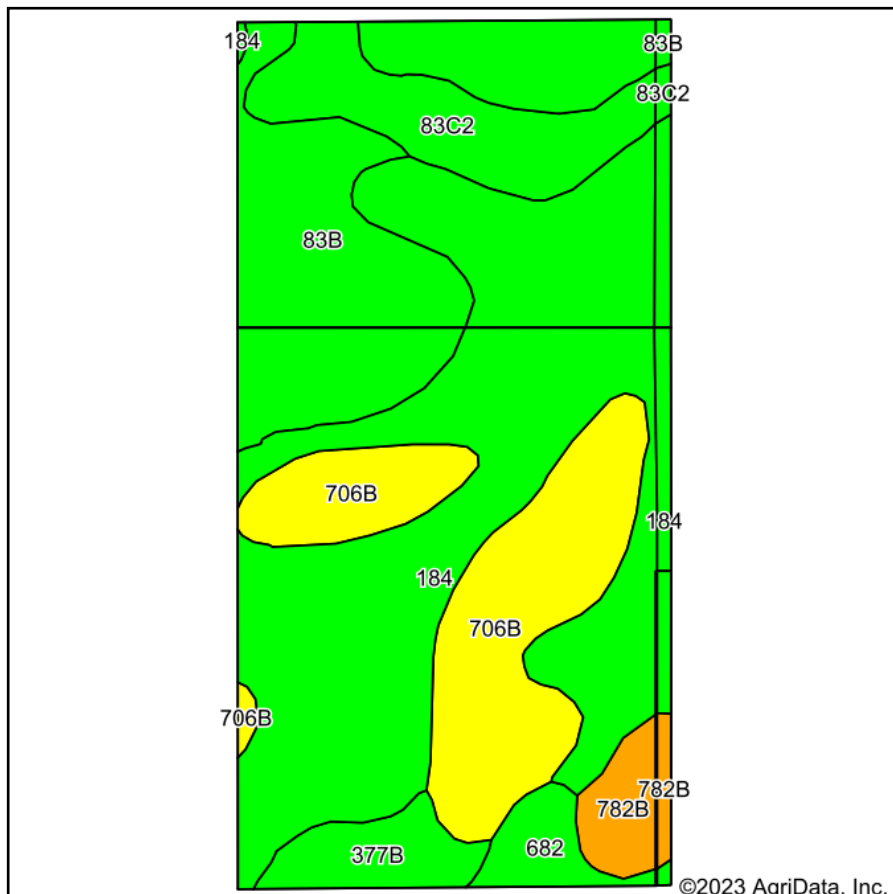

Soils data provided by USDA and NRCS.

Area Symbol: IA033, Soil Area Version: 26  
 Area Symbol: IA067, Soil Area Version: 28

Code	Soil Description	Acres	Percent of field	CSR2 Legend	Non-Irr Class *c	*i Corn Bu	*i Soybeans Bu	CSR2**	CSR	*n NCCPI Overall
184	Klinger silty clay loam, 1 to 4 percent slopes	31.34	40.5%		Iw	240.0	69.6	95	93	88
83B	Kenyon loam, 2 to 5 percent slopes	16.17	20.9%		Ile	225.6	65.4	90	83	87
706B	Cerlin silt loam, 2 to 5 percent slopes	13.98	18.1%		Ile	80.0	23.2	64	58	72
83C2	Kenyon loam, 5 to 9 percent slopes, eroded	6.57	8.5%		IIle	204.8	59.4	84	66	77
377B	Dinsdale silty clay loam, 2 to 5 percent slopes	2.81	3.6%		Ile	232.0	67.3	94	88	87
782B	Donnan loam, 2 to 5 percent slopes	1.96	2.5%		Ile	80.0	23.2	43		70
682	Maxfield silt loam, 0 to 2 percent slopes	1.91	2.5%		IIw			83		78
184	Klinger silty clay loam, 1 to 4 percent slopes	1.85	2.4%		Iw	240.0	69.6	95	95	88
782B	Donnan loam, 2 to 5 percent slopes	0.43	0.6%		Ile	80.0	23.2	43	50	70
83C2	Kenyon loam, 5 to 9 percent slopes, eroded	0.17	0.2%		IIle	204.8	59.4	84	67	77
83B	Kenyon loam, 2 to 5 percent slopes	0.15	0.2%		Ile	225.6	65.4	90	84	87
682	Maxfield silt loam, 0 to 2 percent slopes	0.06	0.1%		IIw			83		78
<b>Weighted Average</b>						<b>1.66</b>	<b>193.7</b>	<b>56.2</b>	<b>85.4</b>	<b>*- *n 83.1</b>

\*\*IA has updated the CSR values for each county to CSR2.

\*- CSR weighted average cannot be calculated on the current soils data, use prior data version for csr values.

\*i Yield data provided by the ISPAID Database version 8.1.1 developed by IA State University.

\*c: Using Capabilities Class Dominant Condition Aggregation Method

\*n: The aggregation method is "Weighted Average using all components"

Soils data provided by USDA and NRCS.