

# CRP Soils Map

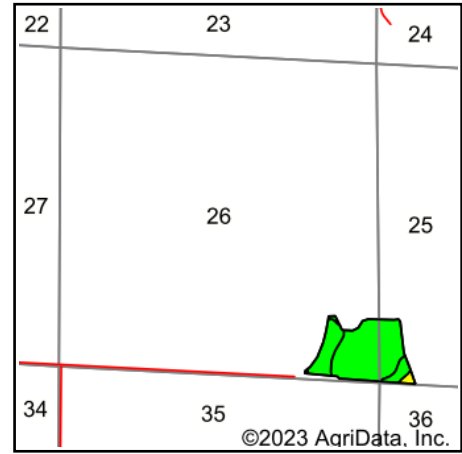

State: **Iowa**  
 County: **Polk**  
 Location: **36-78N-23W**  
 Township: **Allen**  
 Acres: **31.59**  
 Date: **7/19/2023**

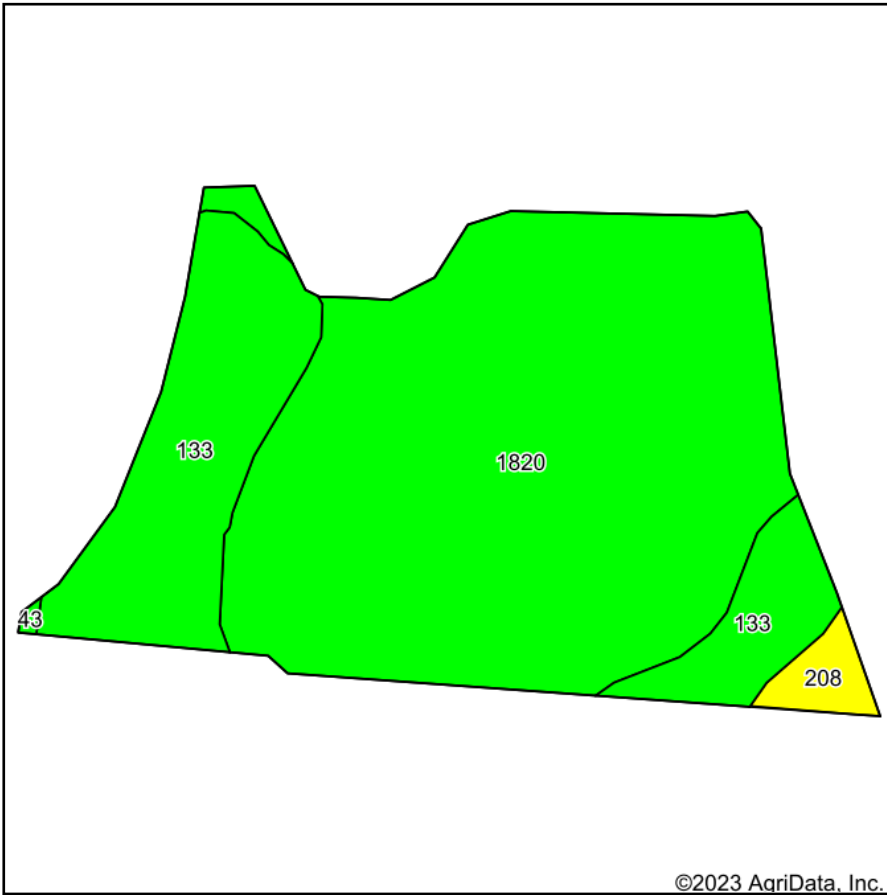

Soils data provided by USDA and NRCS.

©2023 AgriData, Inc.

Area Symbol: IA153, Soil Area Version: 25

Code	Soil Description	Acres	Percent of field	CSR2 Legend	Non-Irr Class *c	CSR2**	CSR	*n NCCPI Overall	*n NCCPI Corn	*n NCCPI Small Grains	*n NCCPI Soybeans
1820	Dockery-Quiver silt loams, 0 to 2 percent slopes, occasionally flooded	22.99	72.8%		IIw	87		93	85	49	92
133	Colo silty clay loam, deep loess, 0 to 2 percent slopes, occasionally flooded	7.88	24.9%		IIw	78	80	81	75	34	80
208	Klum fine sandy loam, 0 to 2 percent slopes, occasionally flooded	0.72	2.3%		IIs	70	55	85	84	53	68
<b>Weighted Average</b>						<b>2.00</b>	<b>84.4</b>	<b>*n 89.8</b>	<b>*n 82.5</b>	<b>*n 45.3</b>	<b>*n 88.5</b>

\*\*IA has updated the CSR values for each county to CSR2.

\*- CSR weighted average cannot be calculated on the current soils data, use prior data version for csr values.

\*n: The aggregation method is "Weighted Average using all components"

\*c: Using Capabilities Class Dominant Condition Aggregation Method

Soils data provided by USDA and NRCS.