

LOCATION MAP

For use in North Dakota only

This form approved by the Fargo-Moorhead Association of REALTORS® which disclaims any liability arising out of the use or misuse of this form.

1 Address: 4288 93rd Ave NE Cray, ND

2 Use the space below to sketch the property lines of the real property and indicate the location of any buildings as well
3 as the approximate location of any of the following:

4 (Check all that apply) Subsurface Sewage Treatment System Well Methamphetamine Production Area

5 Also give approximate distances between landmarks, buildings and property lines as precisely as
6 possible.

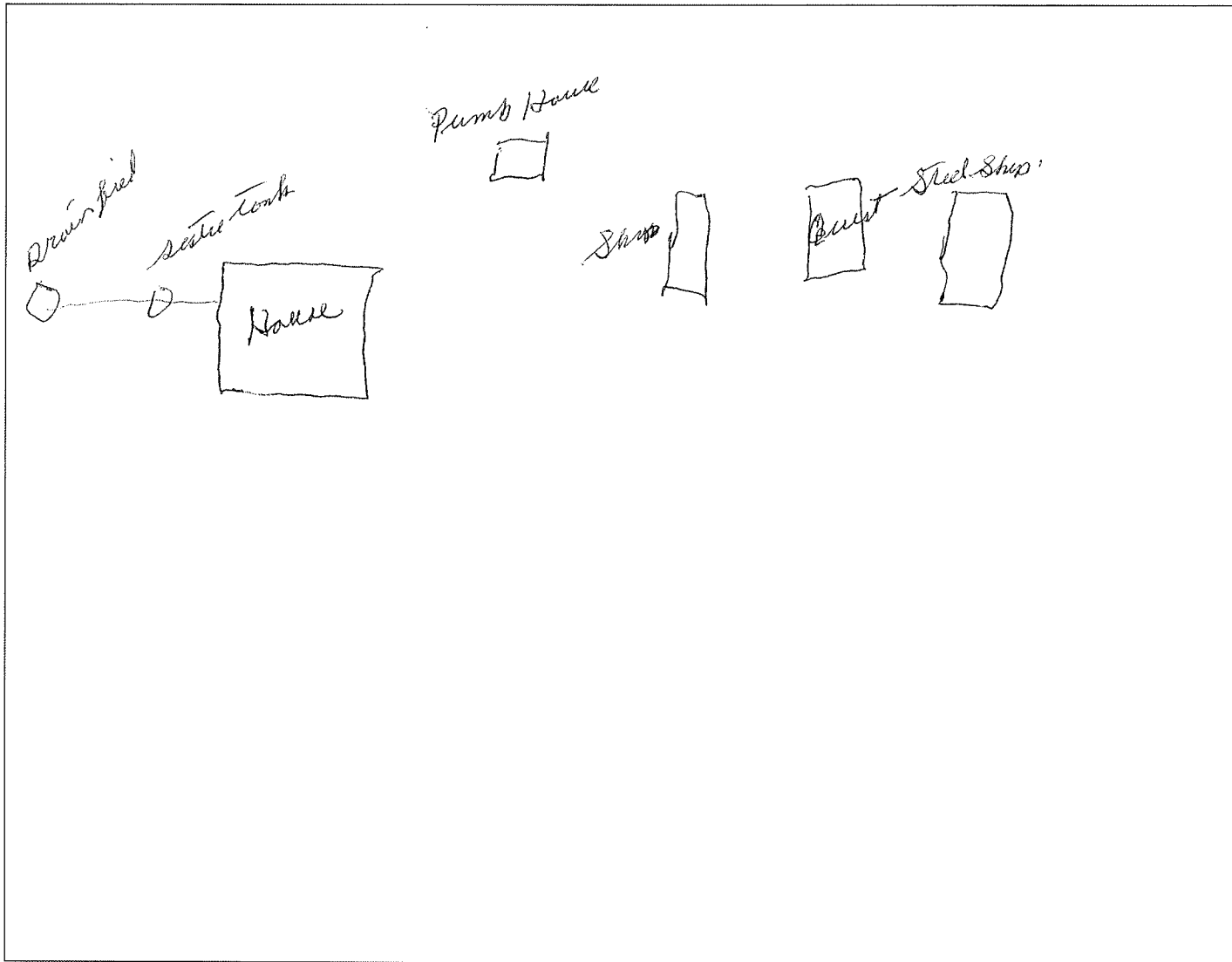

7 Rodney J Brown 7-17-2023
8 Seller Signature Date

Buyer Signature Date

9
10 Seller Signature Date

Buyer Signature Date