

# Current Tillable Soils Map

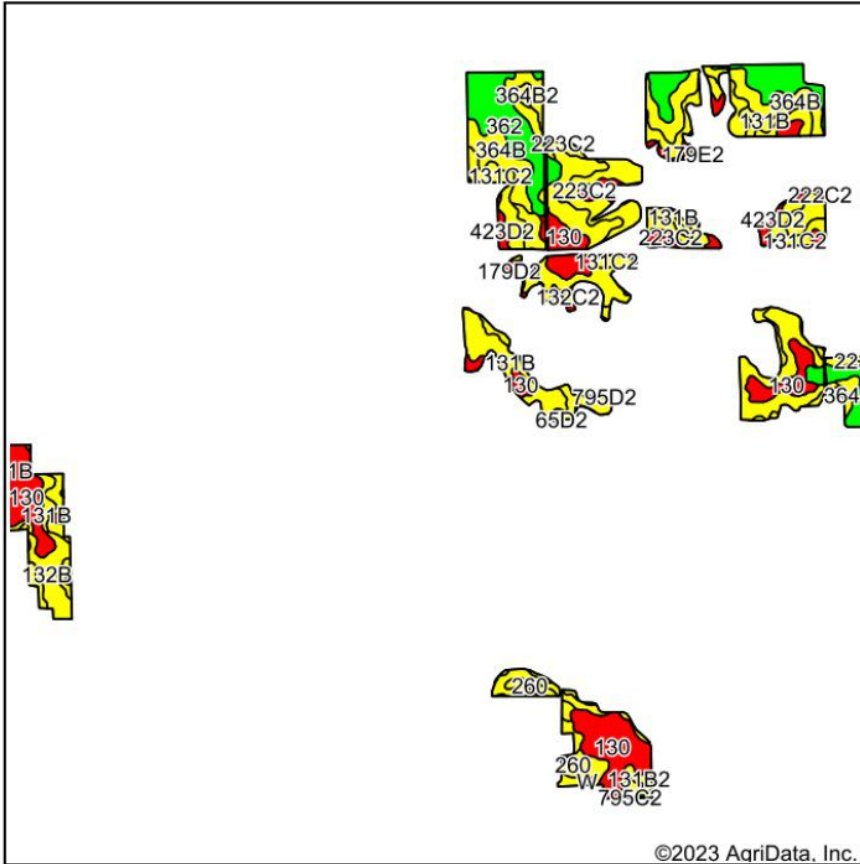

Soils data provided by USDA and NRCS.

©2023 AgriData, Inc.

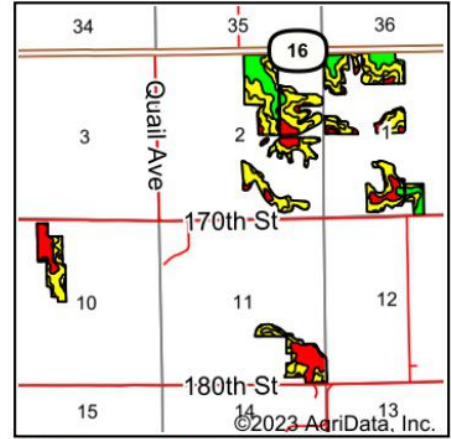

State: Iowa  
 County: Van Buren  
 Location: 2-69N-9W  
 Township: Washington  
 Acres: 316.56  
 Date: 7/13/2023

**PEOPLES COMPANY**  
 INTEGRATED LAND SOLUTIONS

Maps Provided By:



© AgriData, Inc. 2023

www.AgrIDataInc.com



Area Symbol: IA177, Soil Area Version: 30

Code	Soil Description	Acres	Percent of field	CSR2 Legend	CSR2**	CSR
131B	Pershing silt loam, 2 to 5 percent slopes	62.62	19.8%		70	67
131C2	Pershing silty clay loam, 5 to 9 percent slopes, moderately eroded	55.27	17.5%		62	45
130	Belinda silt loam, 0 to 2 percent slopes	49.68	15.7%		47	63
362	Haig silt loam, 0 to 2 percent slopes	44.52	14.1%		83	70
364B	Grundy silty clay loam, 2 to 5 percent slopes	36.91	11.7%		72	75
132B	Weller silt loam, 2 to 5 percent slopes	21.25	6.7%		67	60
132C2	Weller silty clay loam, 5 to 9 percent slopes, moderately eroded	13.40	4.2%		59	40
423D2	Bucknell silty clay loam, 9 to 14 percent slopes, moderately eroded	8.95	2.8%		6	13
223C2	Rinda silty clay loam, 5 to 9 percent slopes, moderately eroded	7.16	2.3%		45	22
364B2	Grundy silty clay loam, 2 to 5 percent slopes, moderately eroded	6.37	2.0%		70	70
260	Beckwith silt loam, 0 to 2 percent slopes	4.87	1.5%		51	57
131B2	Pershing silty clay loam, 2 to 5 percent slopes, moderately eroded	2.01	0.6%		68	63
795D2	Ashgrove silty clay loam, 9 to 14 percent slopes, moderately eroded	1.31	0.4%		7	8
23C2	Arispe silty clay loam, 5 to 9 percent slopes, moderately eroded	1.10	0.3%		62	50
W	Water	0.36	0.1%		0	0
222C2	Clarinda silty clay loam, 5 to 9 percent slopes, moderately eroded	0.26	0.1%		28	25
425D2	Keswick clay loam, 9 to 14 percent slopes, moderately eroded	0.19	0.1%		8	12
132C	Weller silt loam, 5 to 9 percent slopes	0.17	0.1%		59	44
179E2	Gara clay loam, 14 to 18 percent slopes, moderately eroded	0.16	0.1%		23	33
<b>Weighted Average</b>					<b>63.2</b>	<b>59.1</b>

\*\*IA has updated the CSR values for each county to CSR2.

Soils data provided by USDA and NRCS.