

# Current Tillable Soils Map

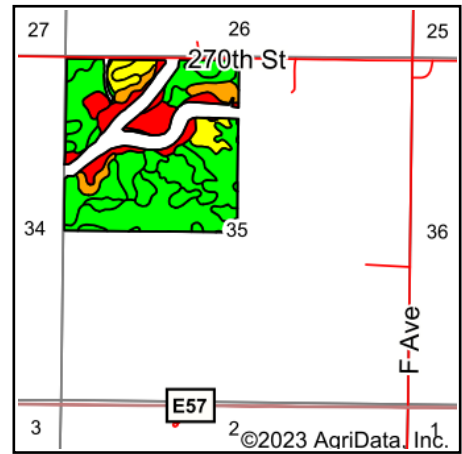

State: **Iowa**  
 County: **Boone**  
 Location: **35-83N-28W**  
 Township: **Beaver**  
 Acres: **134.55**  
 Date: **8/3/2023**

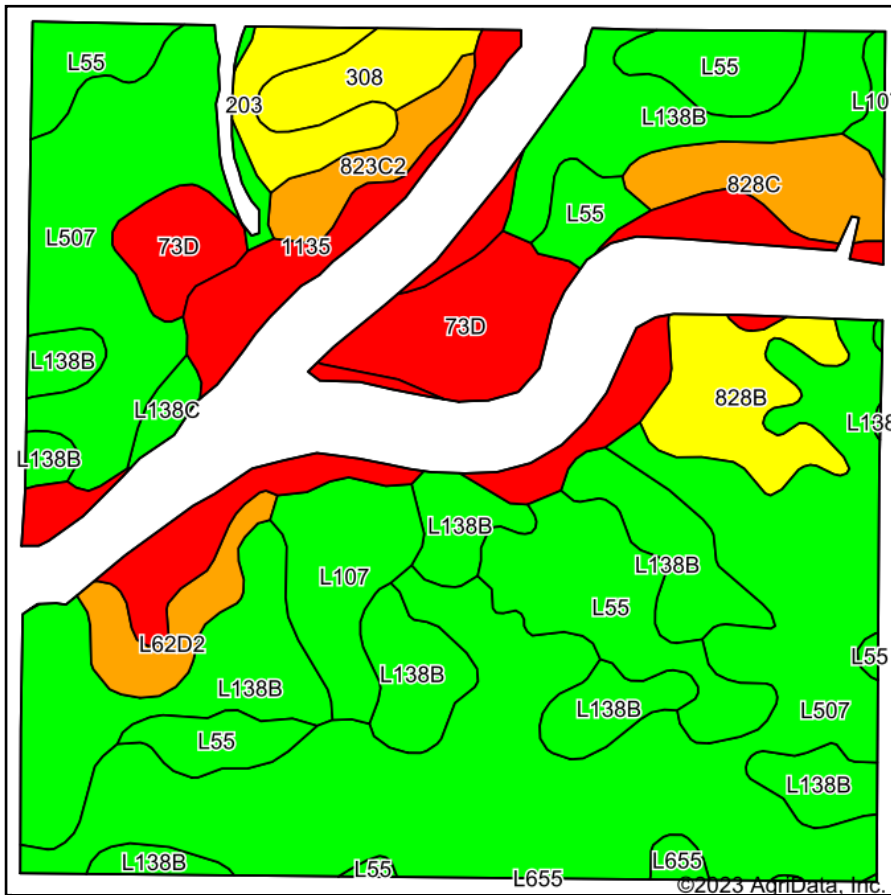

Maps Provided By:



Soils data provided by USDA and NRCS.

Area Symbol: IA015, Soil Area Version: 30

Code	Soil Description	Acres	Percent of field	CSR2 Legend	Non-Irr Class *c	CSR2**	CSR	*n NCCPI Overall	*n NCCPI Corn	*n NCCPI Soybeans	
L507	Canisteo clay loam, Bemis moraine, 0 to 2 percent slopes	46.71	34.7%		llw	87		81	70	81	
L138B	Clarion loam, Bemis moraine, 2 to 6 percent slopes	27.35	20.3%		lle	88		79	75	79	
L55	Nicollet loam, 1 to 3 percent slopes	14.35	10.7%		le	91		84	77	84	
1135	Coland clay loam, 0 to 2 percent slopes, frequently flooded	12.40	9.2%		Vw	13	25	37	25	17	
73D	Hawick gravelly sandy loam, 6 to 12 percent slopes	7.69	5.7%		IVs	31	5	34	34	21	
L107	Webster clay loam, Bemis moraine, 0 to 2 percent slopes	5.35	4.0%		llw	88		84	77	83	
828B	Zenor sandy loam, 2 to 5 percent slopes	4.84	3.6%		llle	52	46	51	51	42	
828C	Zenor sandy loam, 5 to 9 percent slopes	3.87	2.9%		llle	47	31	50	50	41	
308	Wadena loam, 0 to 2 percent slopes	2.82	2.1%		lls	56	73	62	62	53	
203	Cylinder loam, 0 to 2 percent slopes	2.79	2.1%		lls	58	80	72	72	65	
L62D2	Storden loam, Bemis moraine, 10 to 16 percent slopes, moderately eroded	2.77	2.1%		IVe	41		63	60	63	
823C2	Ridgeport sandy loam, 5 to 9 percent slopes, moderately eroded	2.39	1.8%		llle	43	13	47	47	28	
L138C	Clarion loam, Bemis moraine, 6 to 10 percent slopes	0.76	0.6%		llle	84		75	71	75	
L655	Crippin loam, Bemis moraine, 1 to 3 percent slopes	0.46	0.3%		le	91		84	71	84	
<b>Weighted Average</b>						<b>2.41</b>	<b>72.3</b>	<b>*</b>	<b>*n 70.7</b>	<b>*n 63.8</b>	<b>*n 66.9</b>

\*\*IA has updated the CSR values for each county to CSR2.

\*n: The aggregation method is "Weighted Average using all components"

\*c: Using Capabilities Class Dominant Condition Aggregation Method

\*- CSR weighted average cannot be calculated on the current soils data, use prior data version for csr values.

Soils data provided by USDA and NRCS.