

Total Soils Map

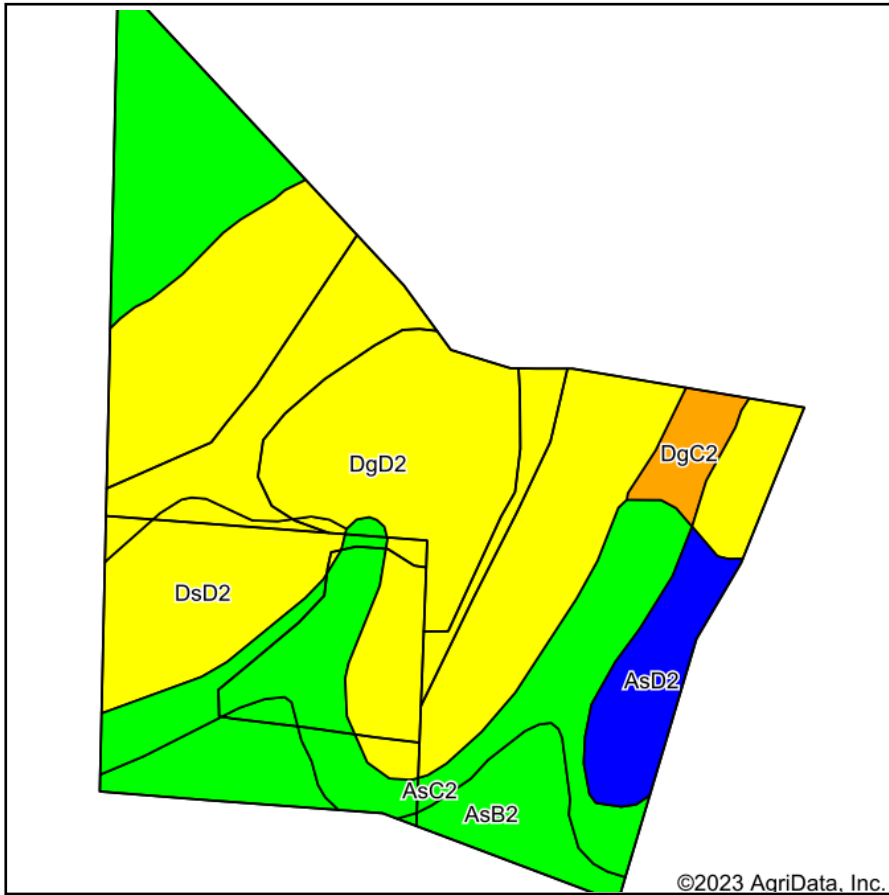

Soils data provided by USDA and NRCS.

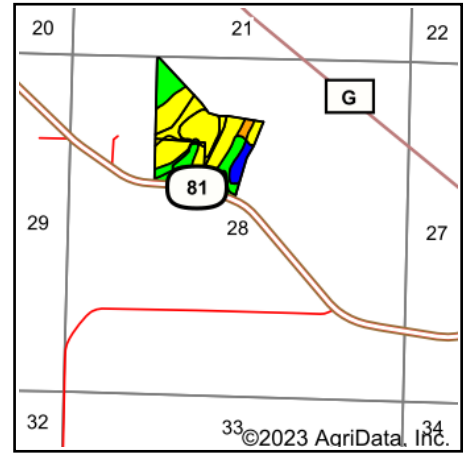

State: **Wisconsin**
 County: **Lafayette**
 Location: **28-3N-5E**
 Township: **Argyle**
 Acres: **47.62**
 Date: **8/24/2023**



Maps Provided By:



© AgriData, Inc. 2023

www.AgriDataInc.com



Area Symbol: WI065, Soil Area Version: 19

Code	Soil Description	Acres	Percent of field	NCCPI Overall Legend	Non-Irr Class *c	*n NCCPI Overall
DgD2	Dodgeville silt loam, 12 to 20 percent slopes, moderately eroded	23.59	49.5%		IVe	57
AsC2	Ashdale silt loam, 6 to 12 percent slopes, moderately eroded	12.04	25.3%		IIIe	83
DsD2	Newglarus silt loam, moderately deep, 12 to 20 percent slopes, moderately eroded	4.32	9.1%		IVe	50
AsB2	Ashdale silt loam, 2 to 6 percent slopes, moderately eroded	4.17	8.8%		Ile	85
AsD2	Ashdale silt loam, 12 to 20 percent slopes, moderately eroded	2.44	5.1%		IVe	77
DgC2	Dodgeville silt loam, 6 to 12 percent slopes, moderately eroded	1.06	2.2%		IIIe	62
Weighted Average					3.55	*n 66.5

*n: The aggregation method is "Weighted Average using all components"

*c: Using Capabilities Class Dominant Condition Aggregation Method

Soils data provided by USDA and NRCS.