

# Total Soils Map

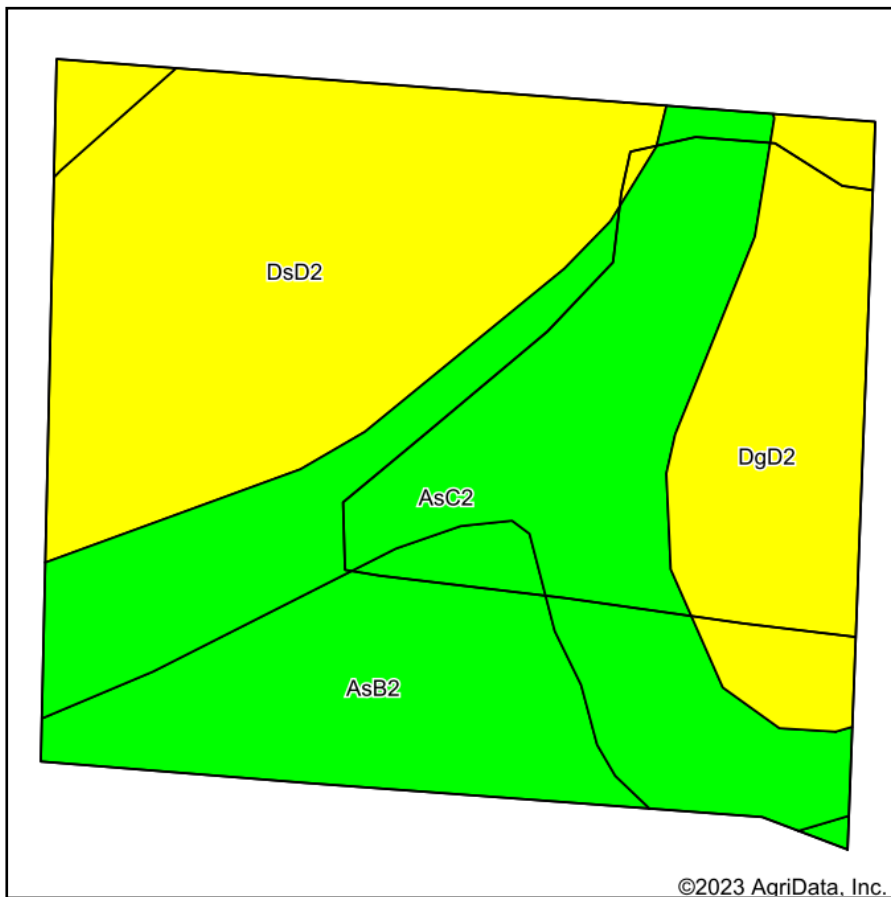

Soils data provided by USDA and NRCS.

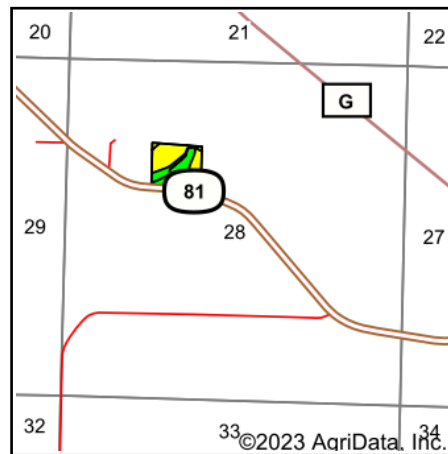

State: **Wisconsin**  
 County: **Lafayette**  
 Location: **28-3N-5E**  
 Township: **Argyle**  
 Acres: **11.92**  
 Date: **8/24/2023**



Maps Provided By:



© AgriData, Inc. 2023

www.AgriDataInc.com



Area Symbol: WI065, Soil Area Version: 19

Code	Soil Description	Acres	Percent of field	NCCPI Overall Legend	Non-Irr Class *c	*n NCCPI Overall
DsD2	Newglarus silt loam, moderately deep, 12 to 20 percent slopes, moderately eroded	3.96	33.2%		IVe	50
AsC2	Ashdale silt loam, 6 to 12 percent slopes, moderately eroded	3.88	32.6%		IIIe	83
DgD2	Dodgeville silt loam, 12 to 20 percent slopes, moderately eroded	2.06	17.3%		IVe	57
AsB2	Ashdale silt loam, 2 to 6 percent slopes, moderately eroded	2.02	16.9%		Ile	85
<b>Weighted Average</b>					<b>3.34</b>	<b>*n 67.9</b>

\*n: The aggregation method is "Weighted Average using all components"

\*c: Using Capabilities Class Dominant Condition Aggregation Method

Soils data provided by USDA and NRCS.