

# Soils Map

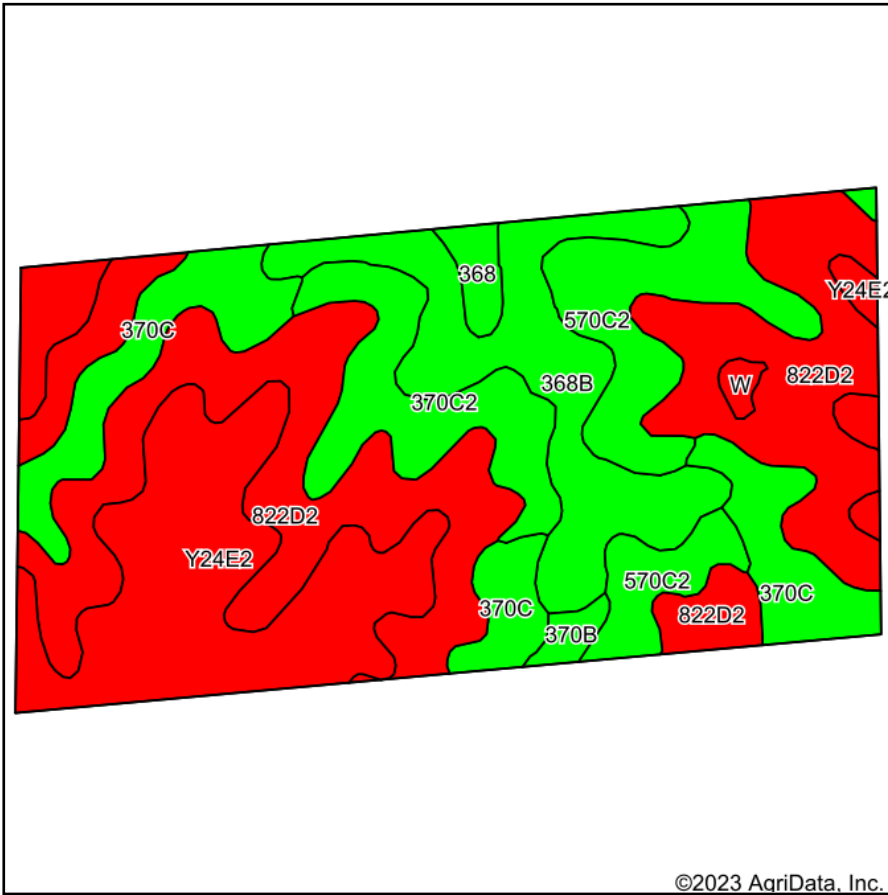

©2023 AgriData, Inc.

Soils data provided by USDA and NRCS.

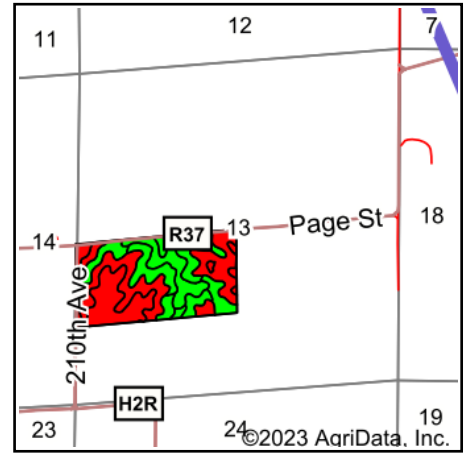

State: **Iowa**  
 County: **Clarke**  
 Location: **13-73N-26W**  
 Township: **Washington**  
 Acres: **80**  
 Date: **8/31/2023**



Maps Provided By:



© AgriData, Inc. 2023

www.AgriDataInc.com



Area Symbol: IA039, Soil Area Version: 28

Code	Soil Description	Acres	Percent of field	CSR2 Legend	Non-Irr Class *c	CSR2**	CSR	*n NCCPI Overall	*n NCCPI Corn	*n NCCPI Small Grains	*n NCCPI Soybeans	
822D2	Lamoni clay loam, 9 to 14 percent slopes, moderately eroded	26.76	33.4%		IVe	11	15	63	63	59	44	
Y24E2	Shelby clay loam, dissected till plain, 14 to 18 percent slopes, eroded	16.76	21.0%		IVe	35		67	67	50	47	
368B	Macksburg silty clay loam, 2 to 5 percent slopes	10.24	12.8%		Ile	89	90	87	87	79	78	
370C	Sharpsburg silty clay loam, 5 to 9 percent slopes	9.62	12.0%		IIle	81	72	89	89	76	75	
570C2	Nira silty clay loam, dissected till plain, 5 to 9 percent slopes, eroded	8.62	10.8%		IIle	81	64	84	84	69	69	
370C2	Sharpsburg silty clay loam, 5 to 9 percent slopes, eroded	6.01	7.5%		IIle	80	67	82	82	68	65	
368	Macksburg silty clay loam, 0 to 2 percent slopes	0.97	1.2%		Iw	93	95	87	87	78	78	
370B	Sharpsburg silty clay loam, 2 to 5 percent slopes	0.63	0.8%		Ile	91	87	92	92	77	79	
W	Water	0.39	0.5%			0	0					
<b>Weighted Average</b>						*-	<b>48.7</b>	*-	<b>*n 73.9</b>	<b>*n 73.9</b>	<b>*n 63.6</b>	<b>*n 57.5</b>

\*\*IA has updated the CSR values for each county to CSR2.

\*- CSR weighted average cannot be calculated on the current soils data, use prior data version for csr values.

\*n: The aggregation method is "Weighted Average using all components"

\*c: Using Capabilities Class Dominant Condition Aggregation Method

\*- Non Irr Class weighted average cannot be calculated on the current soils data due to missing data.

Soils data provided by USDA and NRCS.