

# Tillable Soils Map

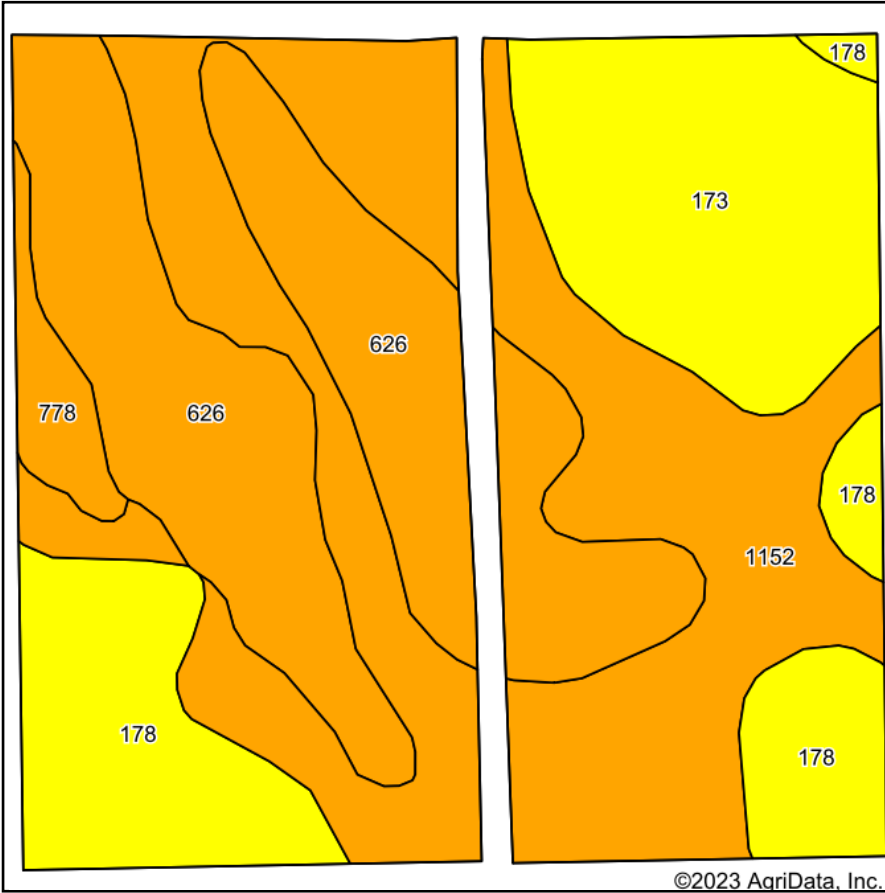

Soils data provided by USDA and NRCS.

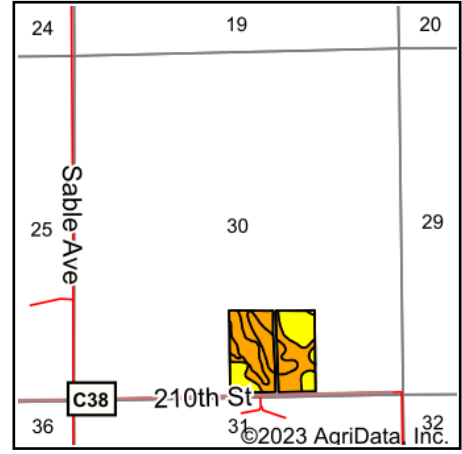

State: **Iowa**  
 County: **Bremer**  
 Location: **30-92N-11W**  
 Township: **Dayton**  
 Acres: **36.91**  
 Date: **8/16/2023**



Maps Provided By:



© AgriData, Inc. 2023

www.AgriDataInc.com



Area Symbol: IA017, Soil Area Version: 27

Code	Soil Description	Acres	Percent of field	CSR2 Legend	Non-Irr Class *c	CSR2**	*n NCCPI Overall	
1152	Marshan clay loam, 0 to 2 percent slopes, rarely flooded	13.67	37.0%		llw	54	81	
626	Hayfield loam, 0 to 2 percent slopes, rarely flooded	10.80	29.3%		lls	53	81	
173	Hoopeston sandy loam, terrace, 0 to 2 percent slopes, rarely flooded	5.89	16.0%		lls	60	67	
178	Waukee loam, 0 to 2 percent slopes, rarely flooded	5.68	15.4%		lls	69	82	
778	Sattre loam, 0 to 2 percent slopes, rarely flooded	0.87	2.4%		lls	54	70	
<b>Weighted Average</b>						<b>2.00</b>	<b>57</b>	<b>*n 78.7</b>

\*\*IA has updated the CSR values for each county to CSR2.

\*n: The aggregation method is "Weighted Average using all components"

\*c: Using Capabilities Class Dominant Condition Aggregation Method

Soils data provided by USDA and NRCS.