

Soils Map - Tillable Acres

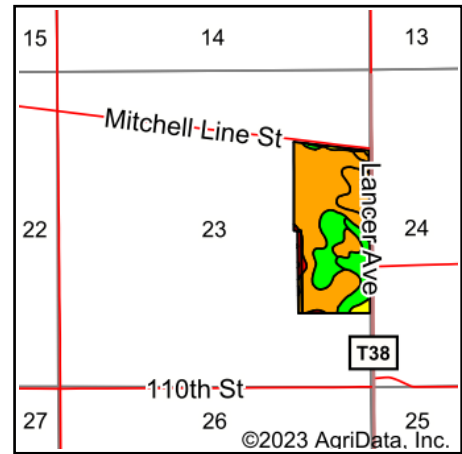

State: **Iowa**
 County: **Floyd**
 Location: **23-97N-17W**
 Township: **Rudd**
 Acres: **79.98**
 Date: **9/27/2023**

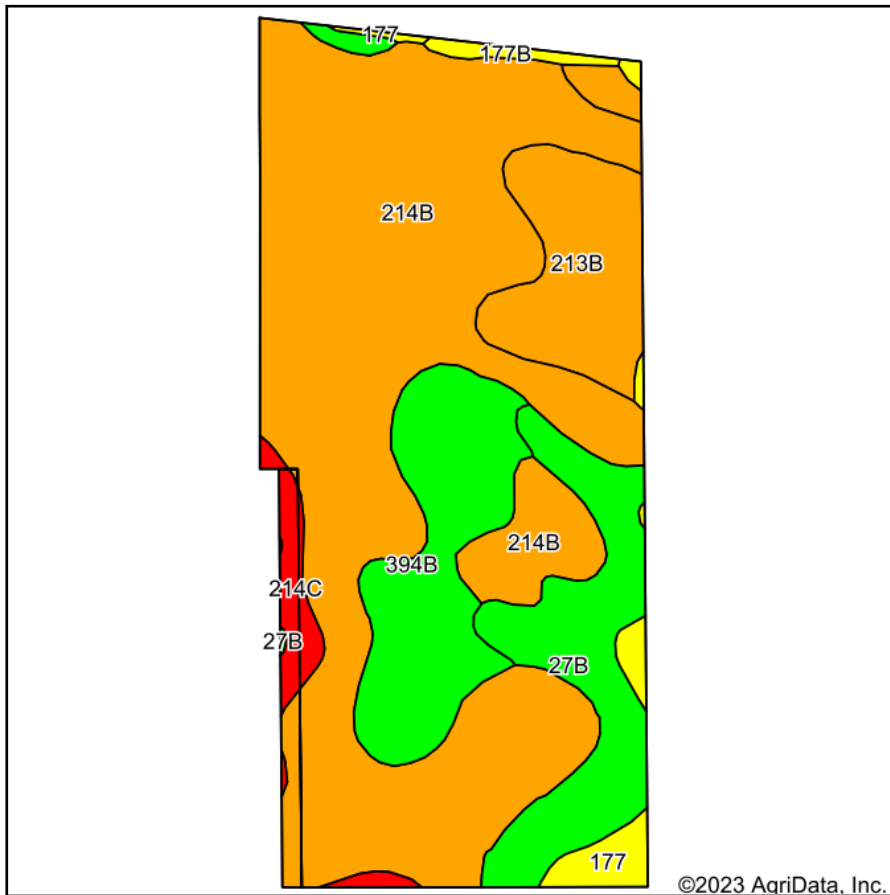

Maps Provided By:



Area Symbol: IA067, Soil Area Version: 28

Code	Soil Description	Acres	Percent of field	CSR2 Legend	Non-Irr Class *c	*i Corn Bu	*i Alfalfa Tons	*i Soybeans Bu	CSR2**	*n NCCPI Overall
214B	Rockton loam, 20 to 30 inches to limestone, till plain, 2 to 5 percent slopes	47.45	59.3%		Ile	80.0		23.2	47	52
394B	Ostrander loam, 2 to 5 percent slopes	10.26	12.8%		Ile	225.6	6.3	65.4	88	75
27B	Terril loam, 2 to 5 percent slopes	9.34	11.7%		Ile	224.0	6.3	65.0	89	96
213B	Rockton loam, 30 to 40 inches to limestone, till plain, 2 to 5 percent slopes	7.94	9.9%		Ile	80.0	2.2	23.2	49	58
177	Saude loam, 0 to 2 percent slopes	2.05	2.6%		Ils	80.0	2.2	23.2	60	78
214C	Rockton loam, 20 to 30 inches to limestone, till plain, 5 to 9 percent slopes	1.99	2.5%		Ille	80.0	2.2	23.2	40	50
177B	Saude loam, 2 to 5 percent slopes	0.59	0.7%		Ils	80.0	2.2	23.2	55	76
482B	Racine loam, 2 to 5 percent slopes	0.36	0.5%		Ile	212.8	6.0	61.7	76	65
Weighted Average					2.02	116.1	3.2	33.7	57.7	*n 61.5

**IA has updated the CSR values for each county to CSR2.

*i Yield data provided by the ISPAID Database version 8.1.1 developed by IA State University.

*n: The aggregation method is "Weighted Average using all components"

*c: Using Capabilities Class Dominant Condition Aggregation Method

Soils data provided by USDA and NRCS.