

Tillable Soils Map

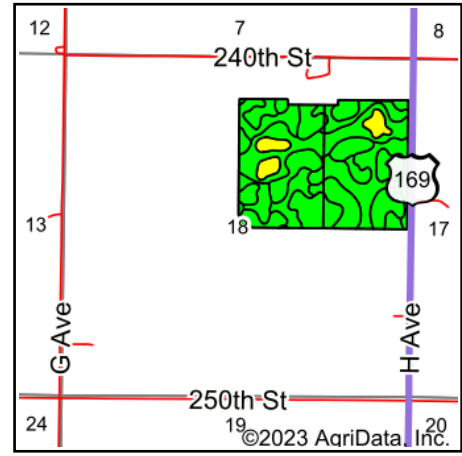

State: **Iowa**
 County: **Boone**
 Location: **18-83N-27W**
 Township: **Marcy**
 Acres: **116.79**
 Date: **5/2/2023**

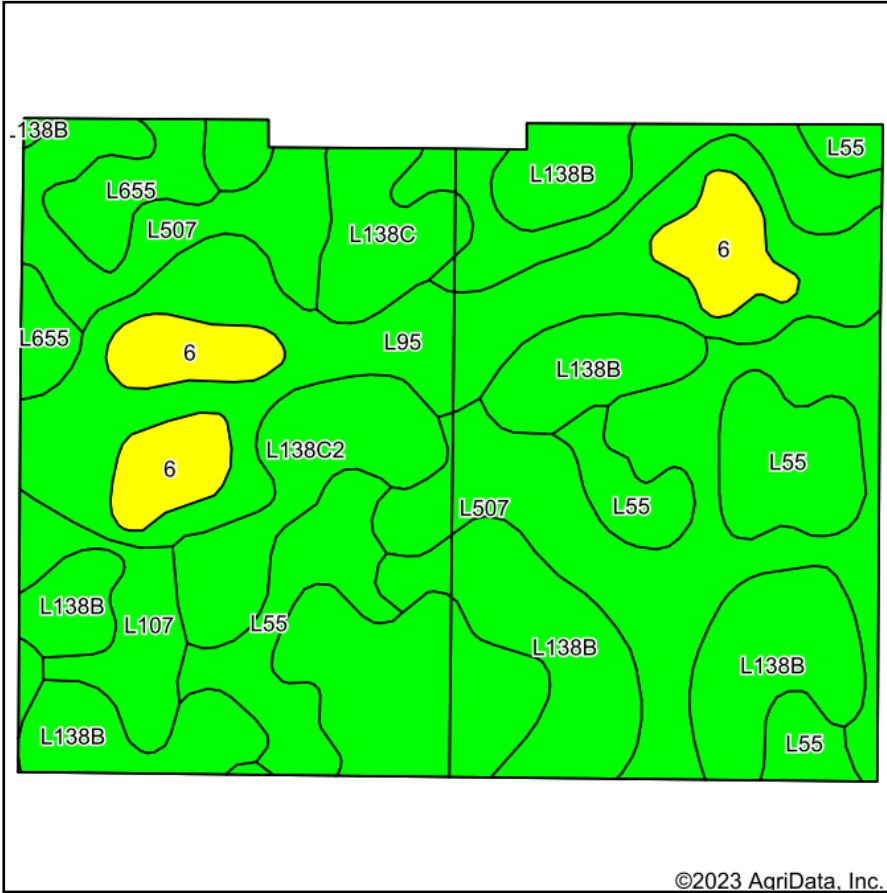

Maps Provided By:



© AgriData, Inc. 2023

www.AgriDataInc.com



Soils data provided by USDA and NRCS.

Area Symbol: IA015, Soil Area Version: 30

Code	Soil Description	Acres	Percent of field	CSR2 Legend	Non-Irr Class *c	*i Corn Bu	*i Soybeans Bu	CSR2**	CSR	*n NCCPI Overall	
L507	Canisteo clay loam, Bemis moraine, 0 to 2 percent slopes	35.96	30.8%		llw	0.0	0.0	87		81	
L138B	Clarion loam, Bemis moraine, 2 to 6 percent slopes	24.14	20.7%		lle	220.8	64.0	88		79	
L95	Harps clay loam, Bemis moraine, 0 to 2 percent slopes	19.06	16.3%		llw	0.0	0.0	75		80	
L55	Nicollet loam, 1 to 3 percent slopes	13.23	11.3%		le	0.0	0.0	91		84	
6	Okoboji silty clay loam, 0 to 1 percent slopes	6.75	5.8%		lllw	164.8	47.8	59	58	76	
L138C2	Clarion loam, Bemis moraine, 6 to 10 percent slopes, moderately eroded	6.08	5.2%		llle	0.0	0.0	83		65	
L107	Webster clay loam, Bemis moraine, 0 to 2 percent slopes	3.97	3.4%		llw	0.0	0.0	88		84	
L138C	Clarion loam, Bemis moraine, 6 to 10 percent slopes	3.82	3.3%		llle	0.0	0.0	84		75	
L655	Crippin loam, Bemis moraine, 1 to 3 percent slopes	3.78	3.2%		le	0.0	0.0	91		84	
Weighted Average						2.00	55.2	16	83.9	*-	*n 79.6

**IA has updated the CSR values for each county to CSR2.

*- CSR weighted average cannot be calculated on the current soils data, use prior data version for csr values.

*i Yield data provided by the ISPAID Database version 8.1.1 developed by IA State University.

*n: The aggregation method is "Weighted Average using all components"

*c: Using Capabilities Class Dominant Condition Aggregation Method

Soils data provided by USDA and NRCS.