

Soils Map

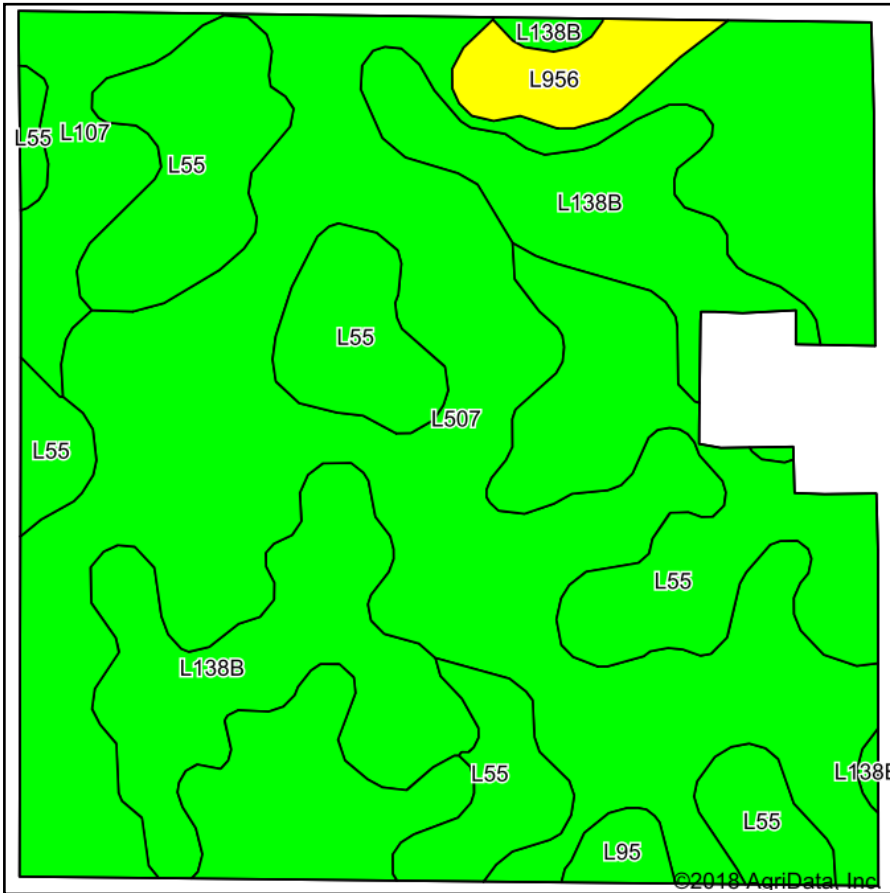

Soils data provided by USDA and NRCS.

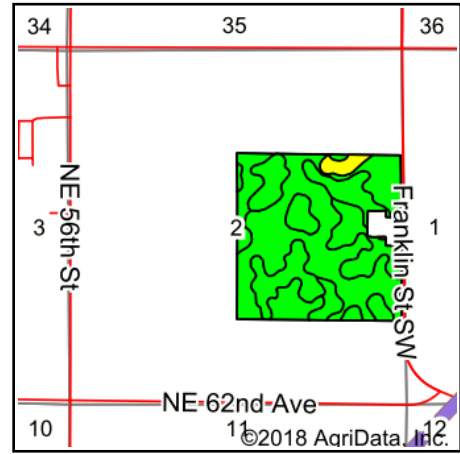

State: **Iowa**
 County: **Polk**
 Location: **2-79N-23W**
 Township: **Clay**
 Acres: **152.97**
 Date: **8/6/2018**

PEOPLES COMPANY
 INNOVATIVE. REAL ESTATE. SOLUTIONS.

Maps Provided By:



Area Symbol: IA153, Soil Area Version: 19

Code	Soil Description	Acres	Percent of field	CSR2 Legend	CSR2**
L507	Canisteo clay loam, Bemis moraine, 0 to 2 percent slopes	78.57	51.4%		87
L55	Nicollet loam, 1 to 3 percent slopes	37.60	24.6%		91
L138B	Clarion loam, Bemis moraine, 2 to 6 percent slopes	24.75	16.2%		88
L107	Webster clay loam, Bemis moraine, 0 to 2 percent slopes	6.83	4.5%		88
L956	Harps-Okoboji complex, Bemis moraine, 0 to 2 percent slopes	3.89	2.5%		69
L95	Harps clay loam, Bemis moraine, 0 to 2 percent slopes	1.33	0.9%		75
Weighted Average					87.6

**IA has updated the CSR values for each county to CSR2.

*c: Using Capabilities Class Dominant Condition Aggregation Method

Soils data provided by USDA and NRCS.