

Soils Map

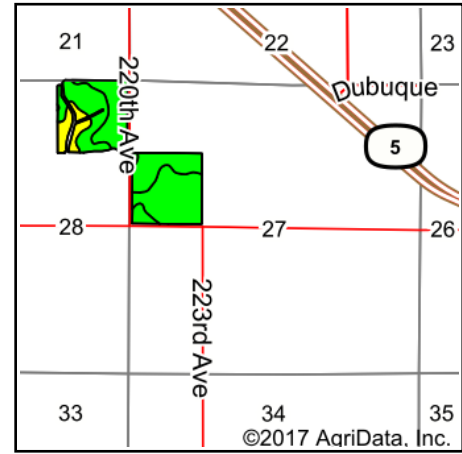

Soils data provided by USDA and NRCS.



State: **Iowa**
 County: **Warren**
 Location: **28-77N-22W**
 Township: **Richland**
 Acres: **72.98**
 Date: **1/4/2018**



Maps Provided By:



© AgriData, Inc. 2017

www.AgriDataInc.com



Area Symbol: IA181, Soil Area Version: 22

Code	Soil Description	Acres	Percent of field	CSR2 Legend	Non-Irr Class *c	*i Corn	*i Soybeans	CSR2**	CSR	NCCPI Overall	NCCPI Corn and Soybeans	NCCPI Small Grains
120C2	Tama silty clay loam, 5 to 9 percent slopes, eroded	27.15	37.2%		Ille	211.2	61.2	87	73	79	79	55
T120B	Tama silty clay loam, terrace, 2 to 5 percent slopes	22.08	30.3%		Ile	232	67.3	95	90	96	96	72
120B	Tama silty clay loam, 2 to 5 percent slopes	14.55	19.9%		Ile	232	67.3	95	90	96	96	72
120D2	Tama silty clay loam, 9 to 14 percent slopes, eroded	6.80	9.3%		Ille	177.6	51.5	62	63	75	75	52
T119	Muscatine silty clay loam, terrace, 0 to 2 percent slopes	2.40	3.3%		Iw	240	69.6	100	95	91	90	33
Weighted Average						219.5	63.6	89.1	81.3	87.6	87.5	62.5

**IA has updated the CSR values for each county to CSR2.

*i Yield data provided by the ISPAID Database version 8.1.1 developed by IA State University.

*c: Using Capabilities Class Dominant Condition Aggregation Method

Soils data provided by USDA and NRCS.