

Tillable Soils Map

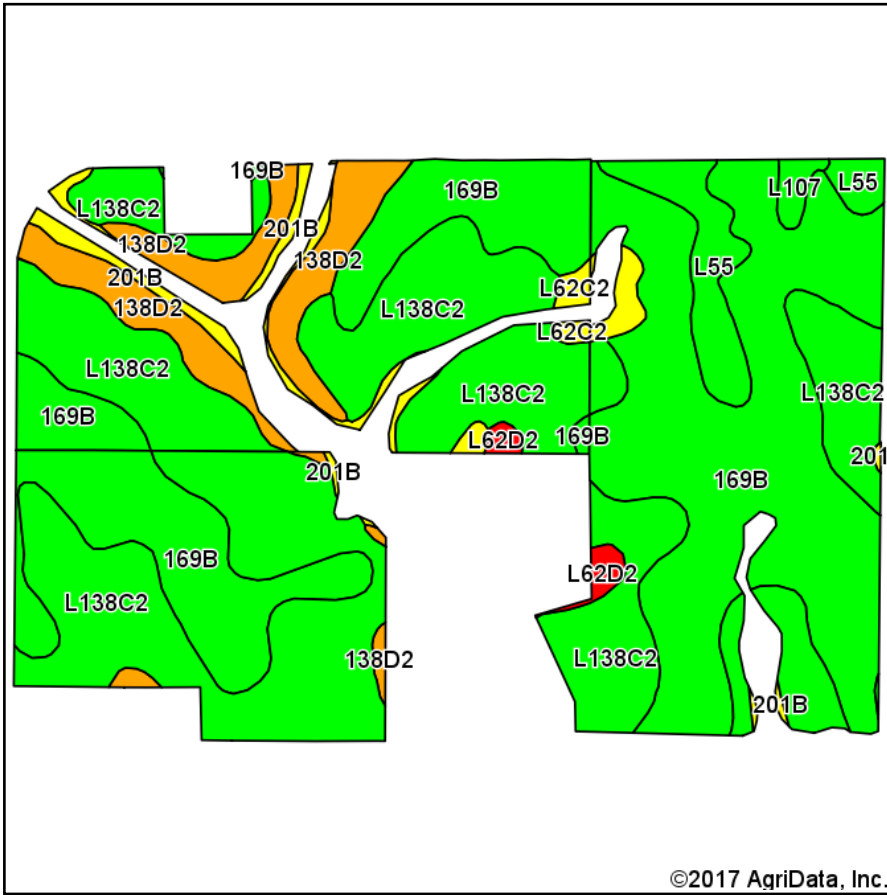

Soils data provided by USDA and NRCS.

©2017 AgriData, Inc.

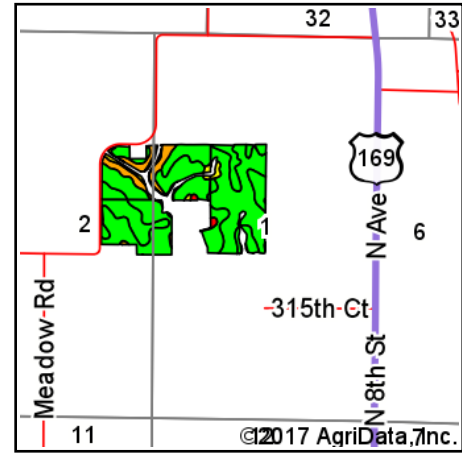

State: **Iowa**
 County: **Dallas**
 Location: **1-78N-28W**
 Township: **Adams**
 Acres: **183.54**
 Date: **4/27/2017**



© AgriData, Inc. 2017 www.AgriDataInc.com



Area Symbol: IA049, Soil Area Version: 22

Code	Soil Description	Acres	Percent of field	CSR2 Legend	Non-Irr Class *c	CSR2**	CS R
L138C2	Clarion loam, Bemis moraine, 6 to 10 percent slopes, moderately eroded	78.88	43.0%		IIIe	83	
169B	Clarion loam, 2 to 5 percent long slopes	75.24	41.0%		Ile	91	92
138D2	Clarion loam, 9 to 14 percent slopes, moderately eroded	14.06	7.7%		IIIe	54	56
L55	Nicollet loam, 1 to 3 percent slopes	6.79	3.7%		Ie	91	
201B	Coland-Terril complex, 2 to 5 percent slopes	4.34	2.4%		IIw	74	68
L62C2	Storden loam, Bemis moraine, 6 to 10 percent slopes, moderately eroded	2.06	1.1%		IIIe	64	
L62D2	Storden loam, Bemis moraine, 10 to 16 percent slopes, moderately eroded	1.19	0.6%		IVe	41	
L107	Webster clay loam, Bemis moraine, 0 to 2 percent slopes	0.98	0.5%		IIw	88	
Weighted Average						83.7	*-

**IA has updated the CSR values for each county to CSR2.

*- CSR weighted average cannot be calculated on the current soils data, use prior data version for csr values.

*c: Using Capabilities Class Dominant Condition Aggregation Method

Soils data provided by USDA and NRCS.