

Soils Map

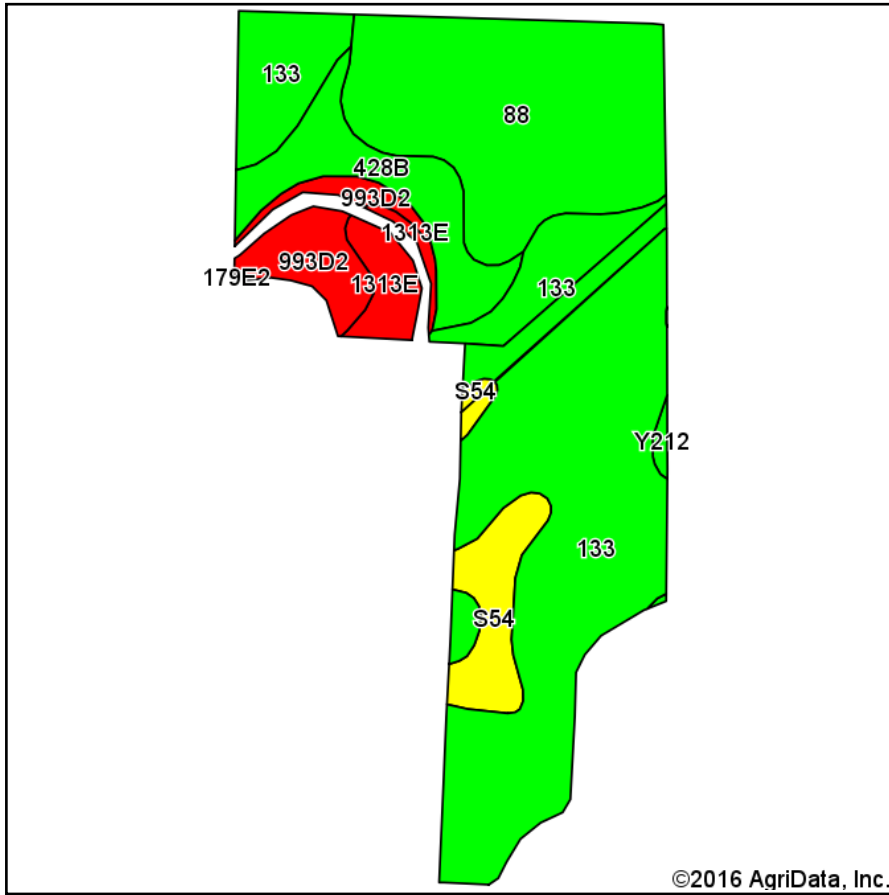

Soils data provided by USDA and NRCS.

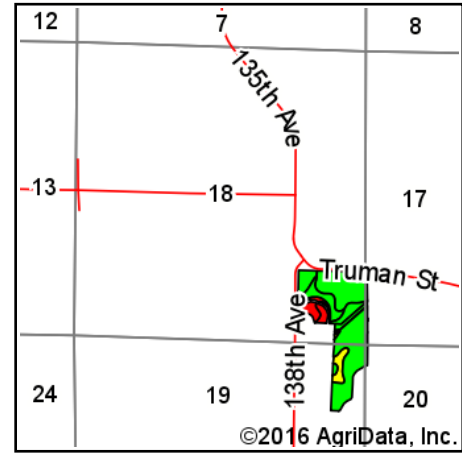

State: **Iowa**
 County: **Warren**
 Location: **18-74N-23W**
 Township: **Liberty**
 Acres: **42.74**
 Date: **1/5/2017**



Maps Provided By:



© AgriData, Inc. 2016

www.AgriDataInc.com



Area Symbol: IA181, Soil Area Version: 21

Code	Soil Description	Acres	Percent of field	CSR2 Legend	CSR2**	CSR
133	Colo silty clay loam, deep loess, 0 to 2 percent slopes, occasionally flooded	21.19	49.6%		78	80
88	Nevin silty clay loam, 0 to 2 percent slopes	11.31	26.5%		93	90
428B	Ely silty clay loam, 2 to 5 percent slopes	3.72	8.7%		87	88
S54	Zook silty clay loam, heavy till, 0 to 2 percent slopes, occasionally flooded	2.54	5.9%		68	
993D2	Armstrong-Gara loams, 9 to 14 percent slopes, moderately eroded	2.36	5.5%		23	20
1313E	Munterville silt loam, 14 to 18 percent slopes	1.44	3.4%		25	10
Y212	Kennebec silt loam, 0 to 2 percent slopes, occasionally flooded	0.18	0.4%		91	
Weighted Average					77.4	*-

Area Symbol: IA181, Soil Area Version: 21

**IA has updated the CSR values for each county to CSR2.

*- CSR weighted average cannot be calculated on the current soils data, use prior data version for csr values.

*c: Using Capabilities Class Dominant Condition Aggregation Method

Soils data provided by USDA and NRCS.