

# Soils Map

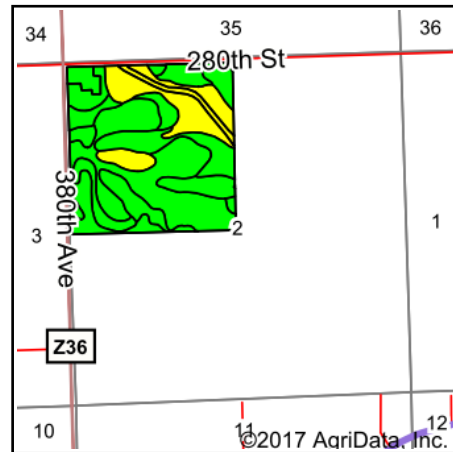

State: **Iowa**  
 County: **Clinton**  
 Location: **2-80N-5E**  
 Township: **Camanche**  
 Acres: **155.69**  
 Date: **11/22/2017**

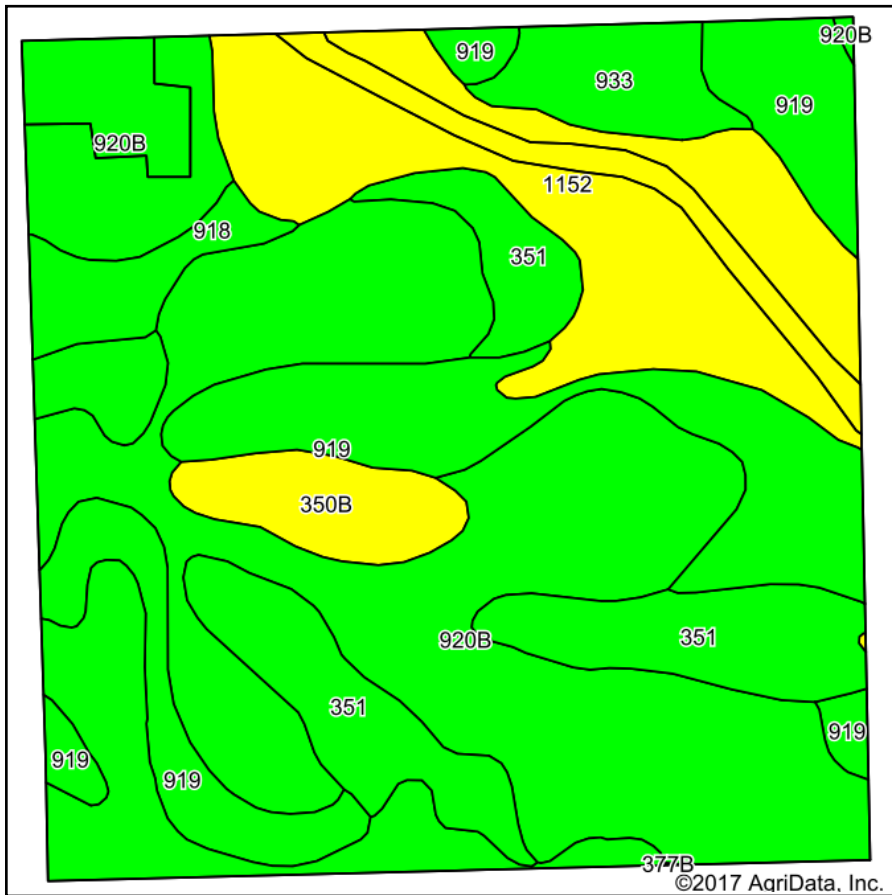
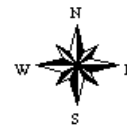

Soils data provided by USDA and NRCS.

Area Symbol: IA045, Soil Area Version: 22

Code	Soil Description	Acres	Percent of field	CSR2 Legend	Non-Irr Class *c	*i Corn	*i Alfalfa	*i Soybeans	*i Bluegrass	*i Tall Grasses	CSR2**	CS R	Cor n	Oat s	Soybeans	NCCPI Overall
920B	Tama silt loam, sandy substratum, 2 to 5 percent slopes	57.56	37.0%		lle	232	6.5	67.3	4.2	7	92	82				96
919	Muscatine silt loam, sandy substratum, 0 to 2 percent slopes	30.00	19.3%		lw	240	6.2	69.6	4.3	7.2	100	90				90
1152	Marshan clay loam, 0 to 2 percent slopes, rarely flooded	26.53	17.0%		llw	166.4	3.5	48.3	3	5	54	70	90	57	30	84
351	Atterberry silt loam, sandy substratum, 0 to 2 percent slopes	18.14	11.7%		lw	224	5.8	65	4	6.7	78	73				97
918	Garwin silty clay loam, sandy substratum, 0 to 2 percent slopes	13.32	8.6%		llw	230.4	4.8	66.8	4.1	6.9	84	87				95
350B	Waukegan silt loam, 2 to 5 percent slopes	5.18	3.3%		lle	177.6	5	51.5	3.2	5.3	55	69				82
933	Sawmill silty clay loam, 0 to 2 percent slopes	4.96	3.2%		llw	204.8	4.3	59.4	3.7	6.1	74	80				85
<b>Weighted Average</b>						<b>218.6</b>	<b>5.6</b>	<b>63.4</b>	<b>3.9</b>	<b>6.6</b>	<b>82.9</b>	<b>80.4</b>	<b>15.3</b>	<b>9.7</b>	<b>5.1</b>	<b>92</b>

\*\*IA has updated the CSR values for each county to CSR2.

\*i Yield data provided by the ISPAID Database version 8.1 developed by IA State University.

\*c: Using Capabilities Class Dominant Condition Aggregation Method

Soils data provided by USDA and NRCS.