

Soils Map

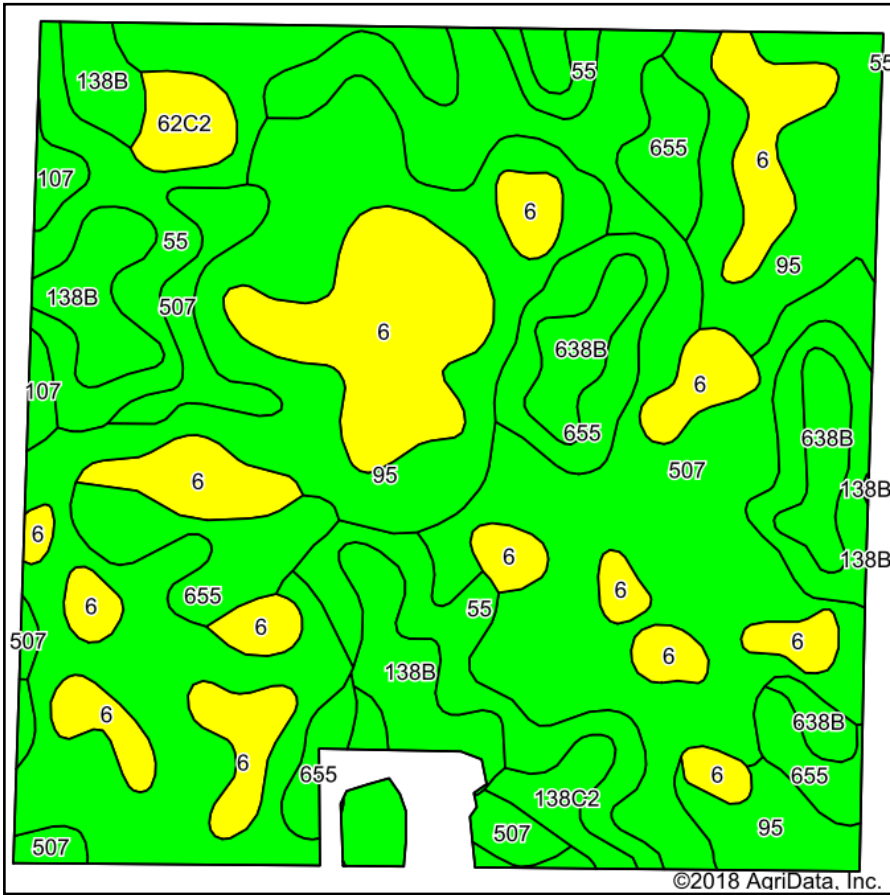

Soils data provided by USDA and NRCS.

©2018 AgriData, Inc.

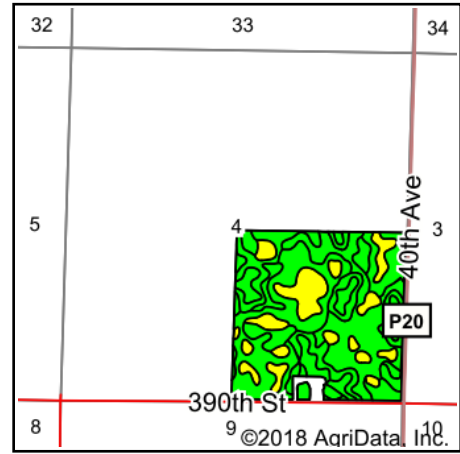

State: **Iowa**
 County: **Kossuth**
 Location: **4-98N-30W**
 Township: **Seneca**
 Acres: **151.31**
 Date: **3/19/2018**

PEOPLES COMPANY
 INNOVATIVE. REAL ESTATE. SOLUTIONS.

Maps Provided By:



Area Symbol: IA109, Soil Area Version: 23

Code	Soil Description	Acres	Percent of field	CSR2 Legend	Non-Irr Class *c	CSR2**	CSR
95	Harps clay loam, 0 to 2 percent slopes	41.05	27.1%		IIw	72	60
507	Canisteo clay loam, 0 to 2 percent slopes	34.26	22.6%		IIw	84	75
6	Okoboji silty clay loam, 0 to 1 percent slopes	24.83	16.4%		IIIw	59	54
55	Nicollet clay loam, 1 to 3 percent slopes	20.84	13.8%		Iw	89	85
655	Crippin loam, 1 to 3 percent slopes	12.24	8.1%		Ie	91	80
138B	Clarion loam, 2 to 6 percent slopes	8.31	5.5%		IIe	89	77
638B	Clarion-Swanlake complex, 2 to 6 percent slopes	4.98	3.3%		IIe	85	71
62C2	Storden loam, 6 to 10 percent slopes, moderately eroded	1.82	1.2%		IIIe	64	49
138C2	Clarion loam, 6 to 10 percent slopes, moderately eroded	1.72	1.1%		IIIe	83	62
107	Webster clay loam, 0 to 2 percent slopes	1.26	0.8%		IIw	86	80
Weighted Average						78	68.8

**IA has updated the CSR values for each county to CSR2.

*c: Using Capabilities Class Dominant Condition Aggregation Method

Soils data provided by USDA and NRCS.