

# Soils Map

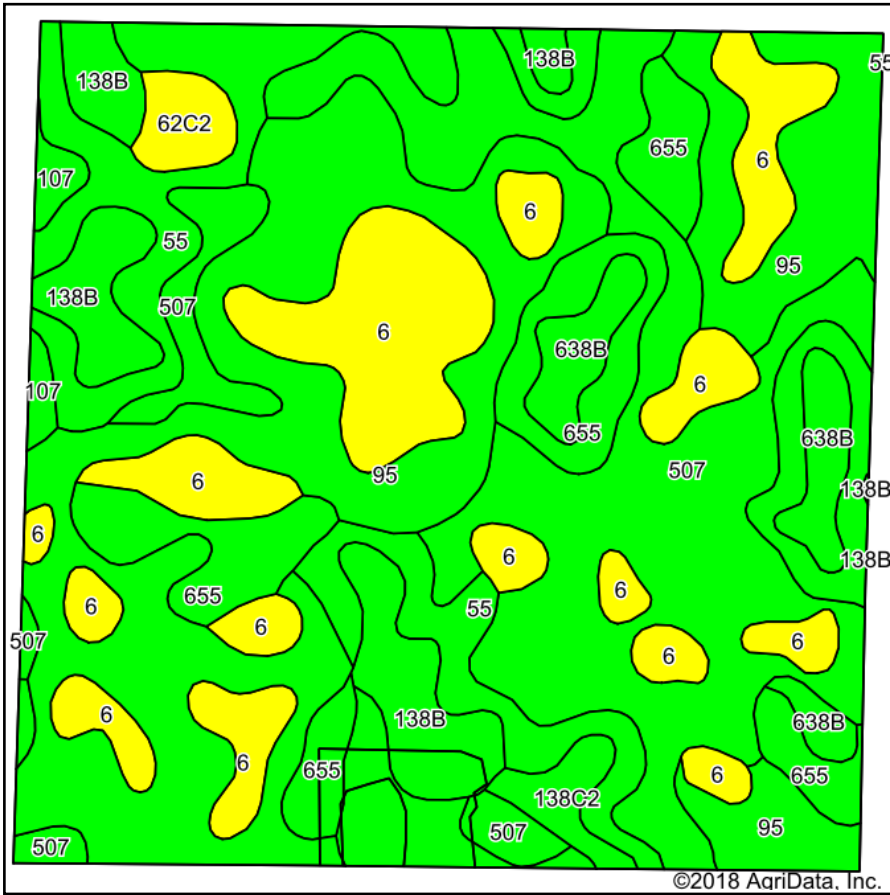

Soils data provided by USDA and NRCS.

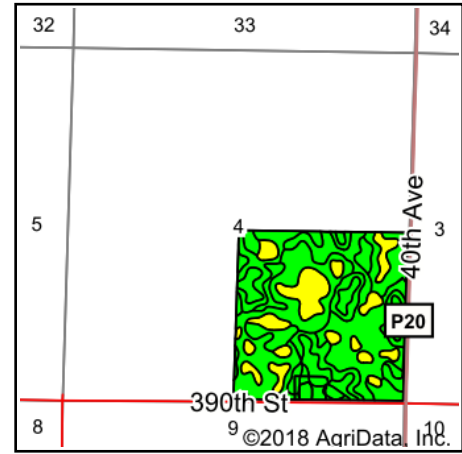

State: **Iowa**  
 County: **Kossuth**  
 Location: **4-98N-30W**  
 Township: **Seneca**  
 Acres: **154.18**  
 Date: **3/19/2018**



Maps Provided By:



## Area Symbol: IA109, Soil Area Version: 23

| Code                    | Soil Description  | Acres | Percent of field | CSR2 Legend | Non-Irr Class *c | CSR2**      | CSR       |
|-------------------------|---|-------|------------------|-------------|------------------|-------------|-----------|
| 95                      | Harps clay loam, 0 to 2 percent slopes                  | 41.17 | 26.7%            |             | IIw              | 72          | 60        |
| 507                     | Canisteo clay loam, 0 to 2 percent slopes               | 34.35 | 22.3%            |             | IIw              | 84          | 75        |
| 6                       | Okoboji silty clay loam, 0 to 1 percent slopes          | 24.83 | 16.1%            |             | IIIw             | 59          | 54        |
| 55                      | Nicollet clay loam, 1 to 3 percent slopes               | 22.18 | 14.4%            |             | Iw               | 89          | 85        |
| 655                     | Crippin loam, 1 to 3 percent slopes                     | 12.68 | 8.2%             |             | Ie               | 91          | 80        |
| 138B                    | Clarion loam, 2 to 6 percent slopes                     | 9.19  | 6.0%             |             | IIe              | 89          | 77        |
| 638B                    | Clarion-Swanlake complex, 2 to 6 percent slopes         | 4.98  | 3.2%             |             | IIe              | 85          | 71        |
| 62C2                    | Storden loam, 6 to 10 percent slopes, moderately eroded | 1.82  | 1.2%             |             | IIIe             | 64          | 49        |
| 138C2                   | Clarion loam, 6 to 10 percent slopes, moderately eroded | 1.72  | 1.1%             |             | IIIe             | 83          | 62        |
| 107                     | Webster clay loam, 0 to 2 percent slopes                | 1.26  | 0.8%             |             | IIw              | 86          | 80        |
| <b>Weighted Average</b> |   |       |                  |             |                  | <b>78.2</b> | <b>69</b> |

\*\*IA has updated the CSR values for each county to CSR2.

\*c: Using Capabilities Class Dominant Condition Aggregation Method

Soils data provided by USDA and NRCS.