

Soils Map

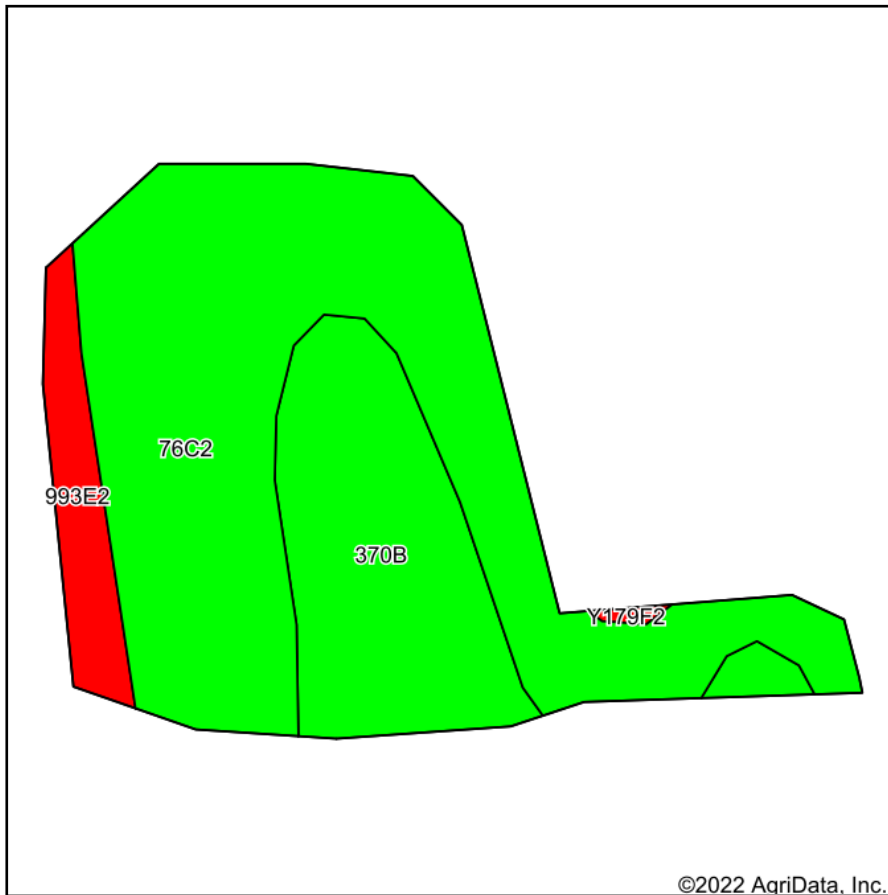

Soils data provided by USDA and NRCS.

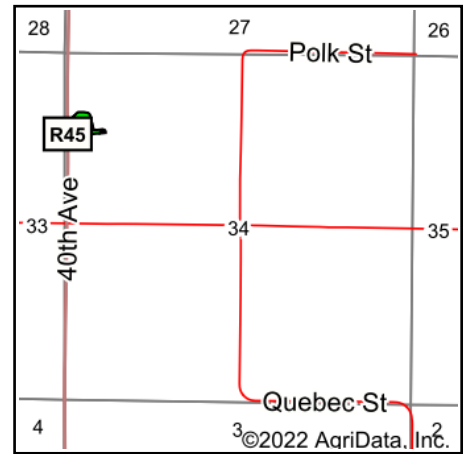

State: **Iowa**
 County: **Warren**
 Location: **34-75N-25W**
 Township: **Jackson**
 Acres: **2.37**
 Date: **5/9/2022**



Maps Provided By:



Area Symbol: IA181, Soil Area Version: 26

Code	Soil Description	Acres	Percent of field	CSR2 Legend	Non-Irr Class *c	CSR2**	CSR	*n NCCPI Overall	*n NCCPI Corn	*n NCCPI Small Grains	*n NCCPI Soybeans
76C2	Ladoga silt loam, dissected till plain, 5 to 9 percent slopes, eroded	1.53	64.6%		IIle	75	65	78	78	69	66
370B	Sharpsburg silty clay loam, 2 to 5 percent slopes	0.66	27.8%		Ile	91	87	93	93	78	80
993E2	Armstrong-Gara loams, 14 to 18 percent slopes, moderately eroded	0.18	7.6%		Vle	17	5	63	63	45	43
Weighted Average					2.95	75.1	66.6	*n 81	*n 81	*n 69.7	*n 68.2

**IA has updated the CSR values for each county to CSR2.

*n: The aggregation method is "Weighted Average using all components"

*c: Using Capabilities Class Dominant Condition Aggregation Method

Soils data provided by USDA and NRCS.