

Soils Map

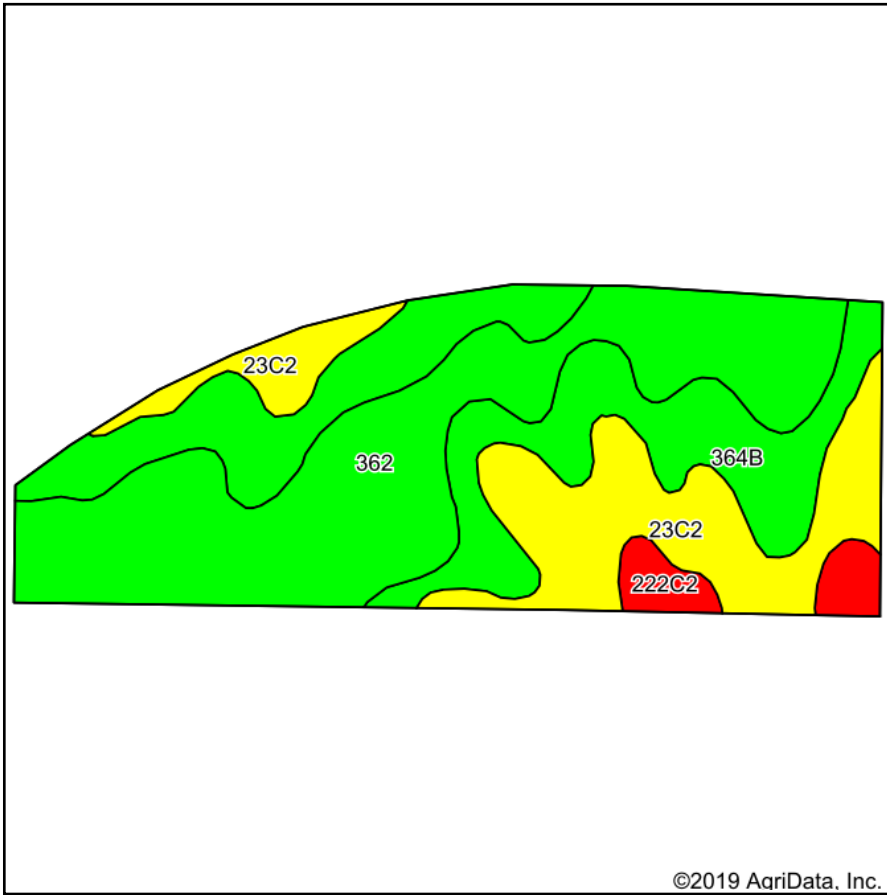

Soils data provided by USDA and NRCS.

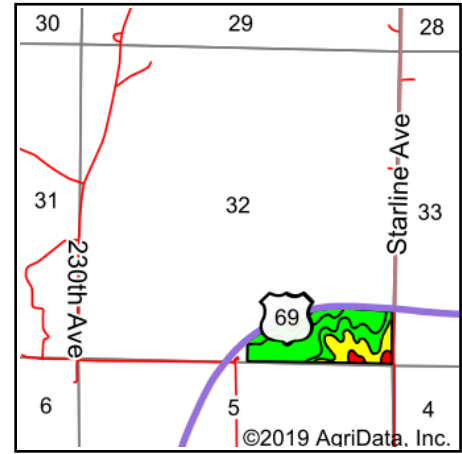

State: **Iowa**
 County: **Clarke**
 Location: **32-73N-25W**
 Township: **Fremont**
 Acres: **43.68**
 Date: **1/14/2019**



Maps Provided By:



© AgriData, Inc. 2019

www.AgriDataInc.com



Area Symbol: IA039, Soil Area Version: 24

Code	Soil Description	Acres	Percent of field	CSR2 Legend	Non-Irr Class *c	*i Corn	*i Soybeans	CSR2**	CSR	*n NCCPI Overall	*n NCCPI Corn	*n NCCPI Small Grains
362	Haig silt loam, 0 to 2 percent slopes	17.66	40.4%		IIw	80	23.2	83	70	75	75	16
364B	Grundy silty clay loam, 2 to 5 percent slopes	14.16	32.4%		Ile	80	23.2	72	75	78	78	44
23C2	Arispe silty clay loam, 5 to 9 percent slopes, moderately eroded	10.14	23.2%		IIIe	80	23.2	62	50	82	82	49
222C2	Clarinda silty clay loam, 5 to 9 percent slopes, moderately eroded	1.72	3.9%		IVw	140.8	40.8	28	25	45	45	14
Weighted Average						82.4	23.9	72.4	65.2	*n 76.4	*n 76.4	*n 32.7

**IA has updated the CSR values for each county to CSR2.

*i Yield data provided by the ISPAID Database version 8.1.1 developed by IA State University.

*n: The aggregation method is "Weighted Average using major components"

*c: Using Capabilities Class Dominant Condition Aggregation Method

Soils data provided by USDA and NRCS.