

# Soils Map

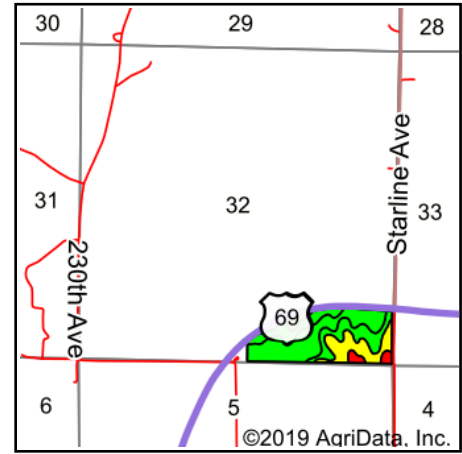

State: **Iowa**  
 County: **Clarke**  
 Location: **32-73N-25W**  
 Township: **Fremont**  
 Acres: **44**  
 Date: **1/29/2019**

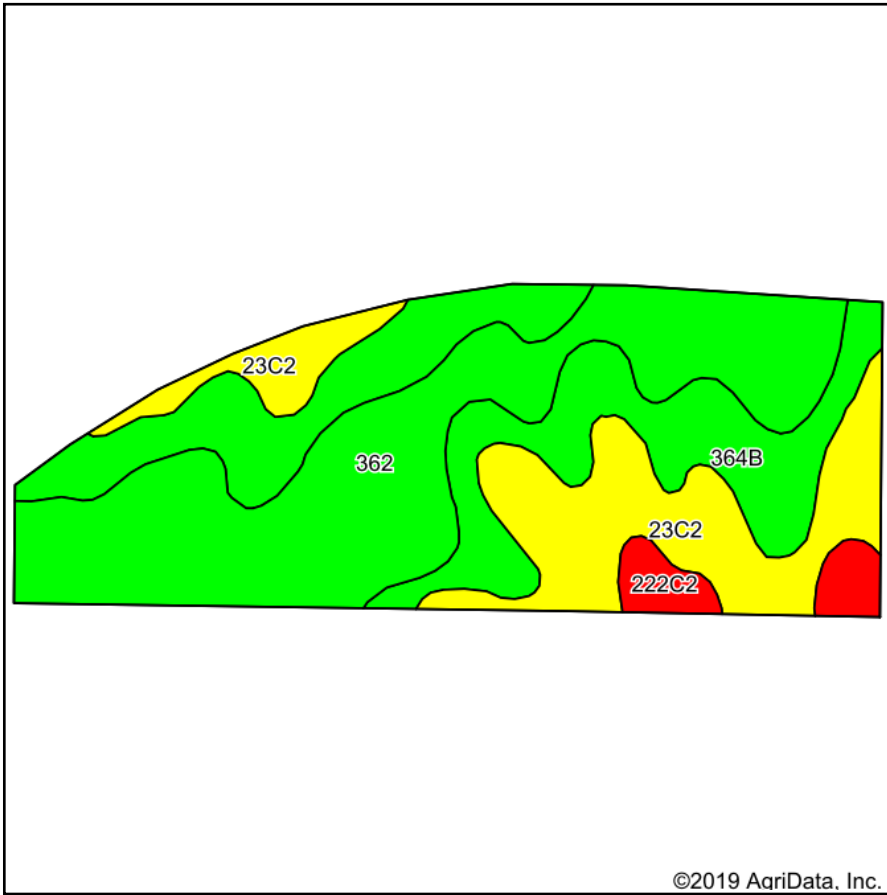

Maps Provided By:



© AgriData, Inc. 2019

www.AgriDataInc.com



Soils data provided by USDA and NRCS.

©2019 AgriData, Inc.

Area Symbol: IA039, Soil Area Version: 24

Code	Soil Description	Acres	Percent of field	CSR2 Legend	Non-Irr Class *c	*i Corn	*i Soybeans	CSR2**	CSR	*n NCCPI Overall	*n NCCPI Corn	*n NCCPI Soybeans
362	Haig silt loam, 0 to 2 percent slopes	17.77	40.4%	Green	IIw	80	23.2	83	70	75	75	66
364B	Grundy silty clay loam, 2 to 5 percent slopes	14.23	32.3%	Light Green	IIe	80	23.2	72	75	78	78	70
23C2	Arispe silty clay loam, 5 to 9 percent slopes, moderately eroded	10.26	23.3%	Yellow	IIIe	80	23.2	62	50	82	82	74
222C2	Clarinda silty clay loam, 5 to 9 percent slopes, moderately eroded	1.74	4.0%	Red	IVw	140.8	40.8	28	25	45	45	38
<b>Weighted Average</b>						<b>82.4</b>	<b>23.9</b>	<b>72.4</b>	<b>65.2</b>	<b>*n 76.4</b>	<b>*n 76.4</b>	<b>*n 68.1</b>

\*\*IA has updated the CSR values for each county to CSR2.

\*i Yield data provided by the ISPAID Database version 8.1.1 developed by IA State University.

\*n: The aggregation method is "Weighted Average using major components"

\*c: Using Capabilities Class Dominant Condition Aggregation Method

Soils data provided by USDA and NRCS.