

Total Soils Map

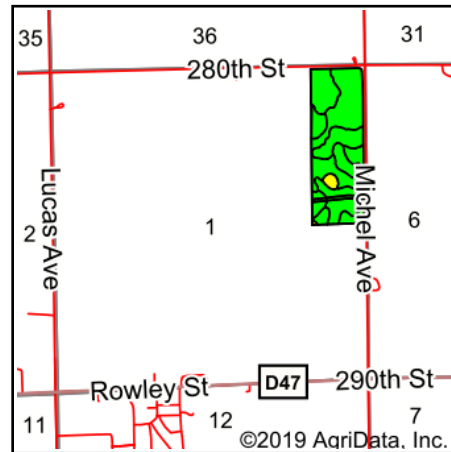

State: **Iowa**
 County: **Buchanan**
 Location: **1-87N-9W**
 Township: **Homer**
 Acres: **52.7**
 Date: **1/30/2019**

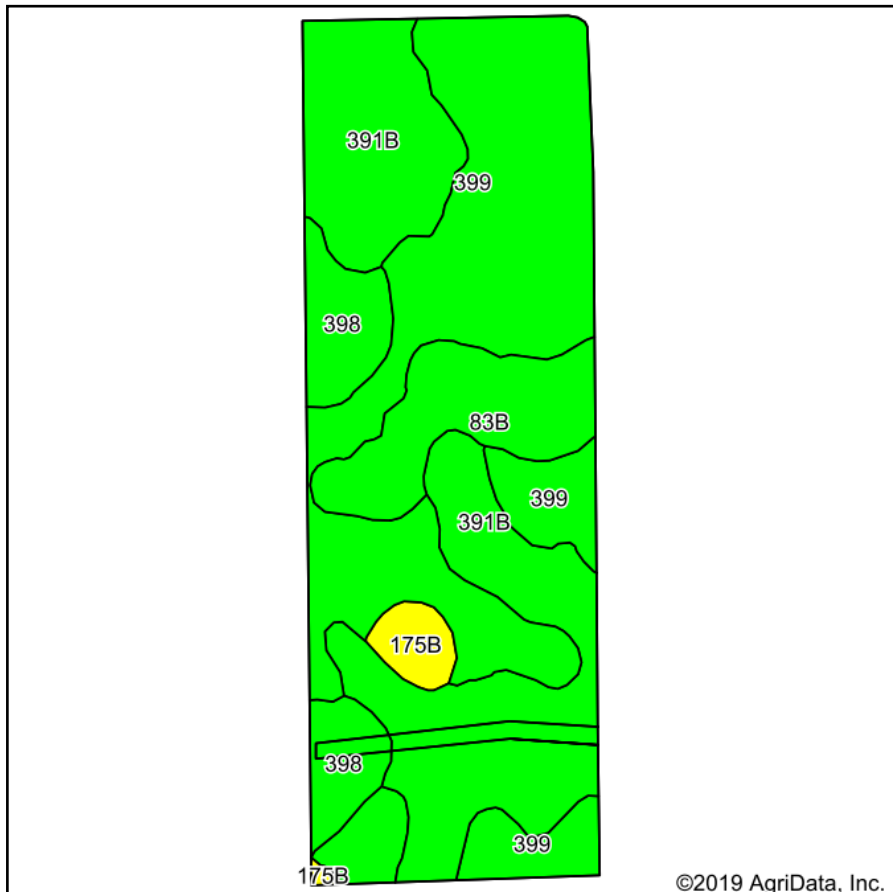

Area Symbol: IA019, Soil Area Version: 24

Code	Soil Description	Acres	Percent of field	CSR2 Legend	Non-Irr Class *c	CSR2**	CSR
399	Readlyn silt loam, 1 to 3 percent slopes	23.52	44.6%		lw	91	91
391B	Clyde-Floyd complex, 1 to 4 percent slopes	17.96	34.1%		llw	87	76
83B	Kenyon loam, 2 to 5 percent slopes	5.63	10.7%		lle	90	86
398	Tripoli clay loam, 0 to 2 percent slopes	4.30	8.2%		llw	90	81
175B	Dickinson fine sandy loam, 2 to 5 percent slopes	1.29	2.4%		llle	50	55
Weighted Average						88.4	83.7

**IA has updated the CSR values for each county to CSR2.

*c: Using Capabilities Class Dominant Condition Aggregation Method

Soils data provided by USDA and NRCS.