

Tillable Soils Map

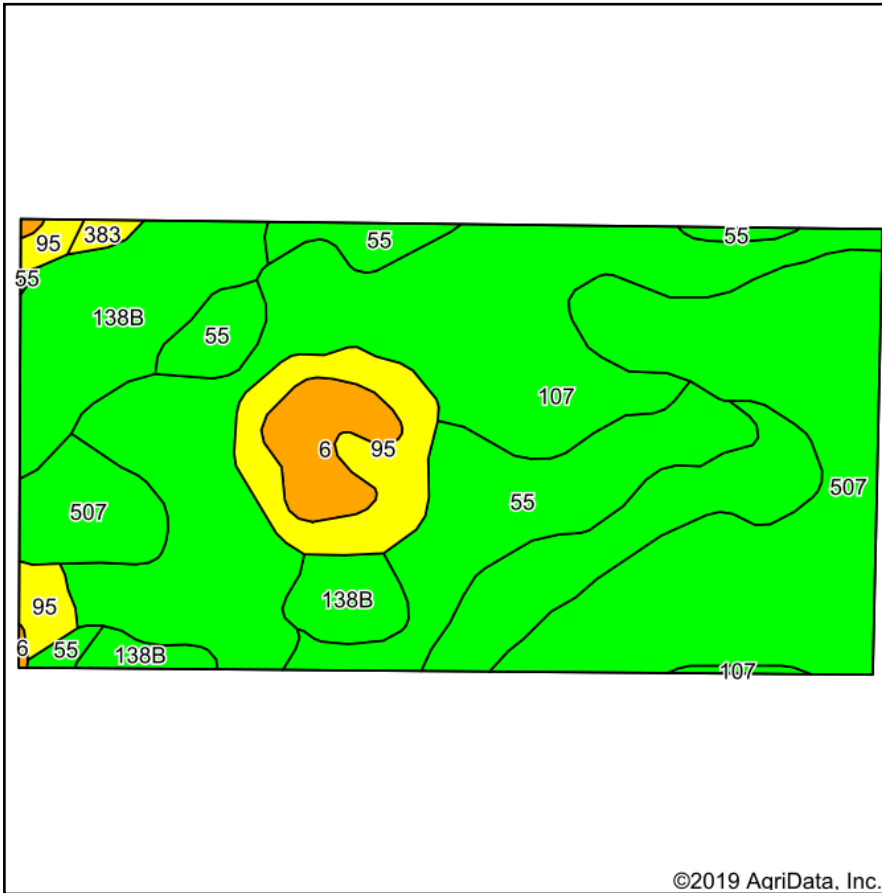

Soils data provided by USDA and NRCS.

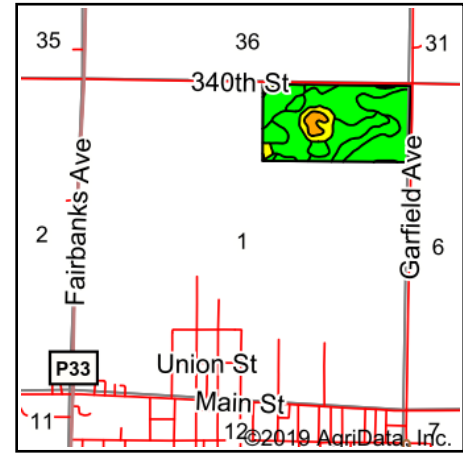

State: **Iowa**
 County: **Webster**
 Location: **1-86N-30W**
 Township: **Gowrie**
 Acres: **65.58**
 Date: **5/16/2019**

PEOPLES™
 COMPANY
 INNOVATIVE. REAL ESTATE. SOLUTIONS.

Maps Provided By:

surety®
 CUSTOMIZED ONLINE MAPPING

© AgriData, Inc. 2019

www.AgriDataInc.com

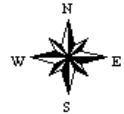

Area Symbol: IA187, Soil Area Version: 35

Code	Soil Description	Acres	Percent of field	CSR2 Legend	Non-Irr Class *c	CSR2**	CSR
107	Webster clay loam, 0 to 2 percent slopes	24.09	36.7%		IIw	86	82
507	Canisteo clay loam, 0 to 2 percent slopes	17.33	26.4%		IIw	84	77
55	Nicollet clay loam, 1 to 3 percent slopes	9.25	14.1%		Iw	89	90
138B	Clarion loam, 2 to 6 percent slopes	7.70	11.7%		Ile	89	82
95	Harps clay loam, 0 to 2 percent slopes	4.69	7.2%		IIw	72	67
6	Okoboji silty clay loam, 0 to 1 percent slopes	2.25	3.4%		IIlw	59	62
383	Marna silty clay loam, 0 to 2 percent slopes	0.27	0.4%		IIw	69	73
Weighted Average						84.2	80

**IA has updated the CSR values for each county to CSR2.

*c: Using Capabilities Class Dominant Condition Aggregation Method

Soils data provided by USDA and NRCS.