

# Soils Map

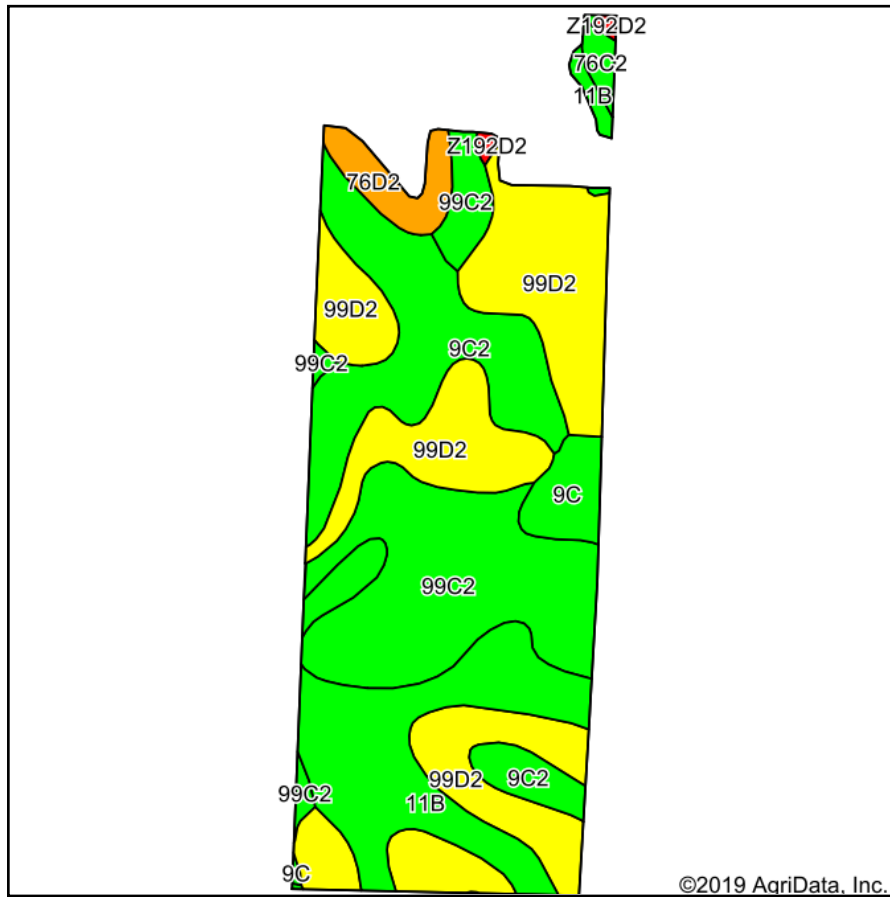

Soils data provided by USDA and NRCS.

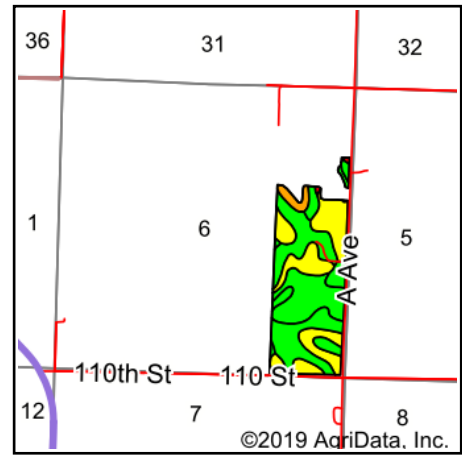

State: **Iowa**  
 County: **Page**  
 Location: **6-70N-39W**  
 Township: **Pierce**  
 Acres: **98.37**  
 Date: **9/18/2019**

**PC PEOPLES**  
 COMPANY  
 INNOVATIVE. REAL ESTATE. SOLUTIONS.

Maps Provided By:  
**surety**  
 CUSTOMIZED ONLINE MAPPING  
 © AgriData, Inc. 2019 www.AgriDataInc.com



Area Symbol: IA145. Soil Area Version: 21

| Code             | Soil Description  | Acres | Percent of field | CSR2 Legend | Non-Irr Class *c | CSR2** | CSR |
|------------------|---|-------|------------------|-------------|------------------|--------|-----|
| 99D2             | Exira silty clay loam, 9 to 14 percent slopes, eroded                     | 33.13 | 33.7%            |             | IIIe             | 59     | 55  |
| 99C2             | Exira silty clay loam, 5 to 9 percent slopes, eroded                      | 22.66 | 23.0%            |             | IIIe             | 87     | 65  |
| 11B              | Colo-Judson silty clay loams, 0 to 5 percent slopes, occasionally flooded | 17.85 | 18.1%            |             | IIw              | 80     | 65  |
| 9C2              | Marshall silty clay loam, 5 to 9 percent slopes, eroded                   | 17.28 | 17.6%            |             | IIIe             | 87     | 68  |
| 76D2             | Ladoga silt loam, 9 to 14 percent slopes, eroded                          | 3.14  | 3.2%             |             | IIIe             | 49     | 50  |
| 9C               | Marshall silty clay loam, 5 to 9 percent slopes                           | 3.06  | 3.1%             |             | IIIe             | 89     | 70  |
| 76C2             | Ladoga silt loam, dissected till plain, 5 to 9 percent slopes, eroded     | 0.85  | 0.9%             |             | IIIe             | 75     | 60  |
| Z192D2           | Adair clay loam, deep loess, 9 to 14 percent slopes, eroded               | 0.40  | 0.4%             |             | IVe              | 14     |     |
| Weighted Average |   |       |                  |             |                  | 74.7   | *-  |

\*\*IA has updated the CSR values for each county to CSR2.

\*- CSR weighted average cannot be calculated on the current soils data, use prior data version for csr values.

\*c: Using Capabilities Class Dominant Condition Aggregation Method

Soils data provided by USDA and NRCS.