

Soils Map

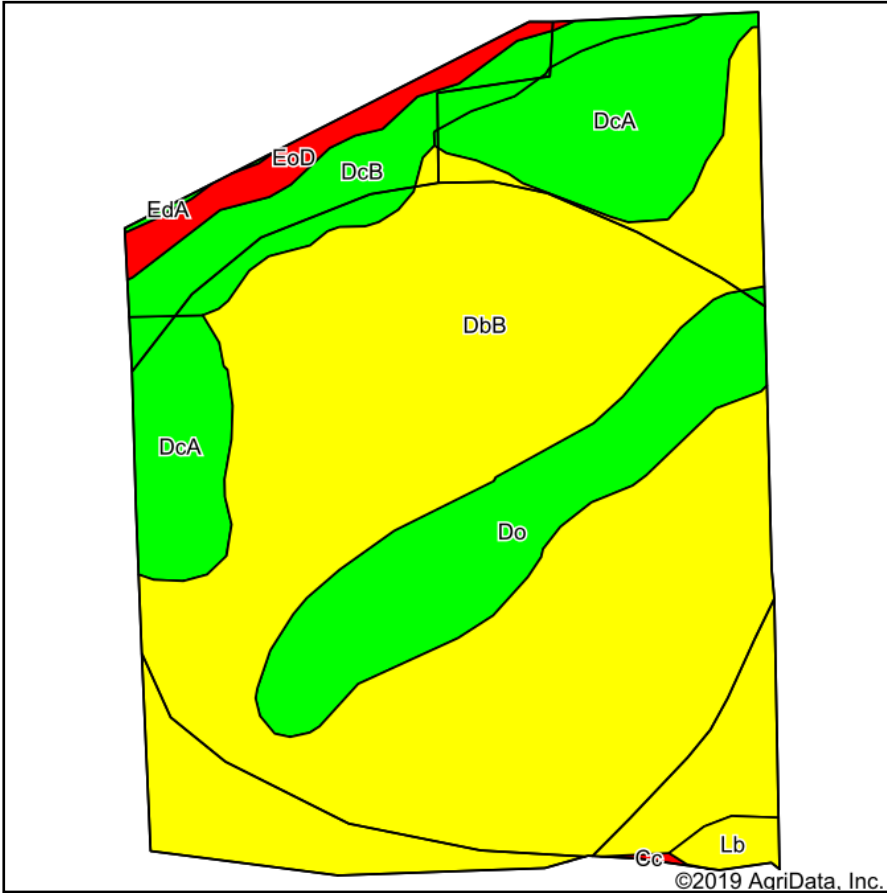

Soils data provided by USDA and NRCS.

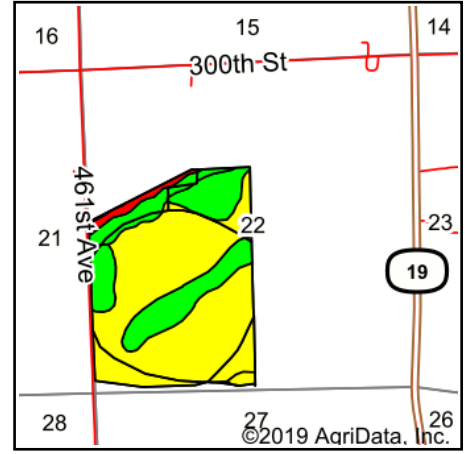

State: **South Dakota**
 County: **Clay**
 Location: **22-95N-52W**
 Township: **Riverside**
 Acres: **185.09**
 Date: **9/12/2019**



Maps Provided By:



© AgriData, Inc. 2019

www.AgriDataInc.com



Area Symbol: SD027. Soil Area Version: 21								
Code	Soil Description	Acres	Percent of field	PI Legend	Non-Irr Class *c	Irr Class *c	Productivity Index	
DbB	Dalesburg-Dimo complex, 1 to 4 percent slopes	121.67	65.7%	Yellow	Ile		68	
DcA	Davis loam, 0 to 2 percent slopes	23.13	12.5%	Green	Iw		90	
Do	Dimo clay loam, 0 to 2 percent slopes	21.91	11.8%	Green	Ils		74	
DcB	Davis loam, 2 to 6 percent slopes	11.76	6.4%	Green	Ile		87	
EoD	Ethan-Betts loams, 9 to 15 percent slopes	4.62	2.5%	Red	Vle		30	
Lb	Lamo silty clay loam, cool, 0 to 2 percent slopes, occasionally flooded	1.65	0.9%	Yellow	Ilw	Ilw	70	
EdA	Egan-Clarno-Trent complex, 0 to 2 percent slopes	0.20	0.1%	Green	Iw		90	
Cc	Chaska silt loam, channeled	0.15	0.1%	Red	Vlw		38	
Weighted Average							71.7	

*c: Using Capabilities Class Dominant Condition Aggregation Method
 Soils data provided by USDA and NRCS.