

Soils Map

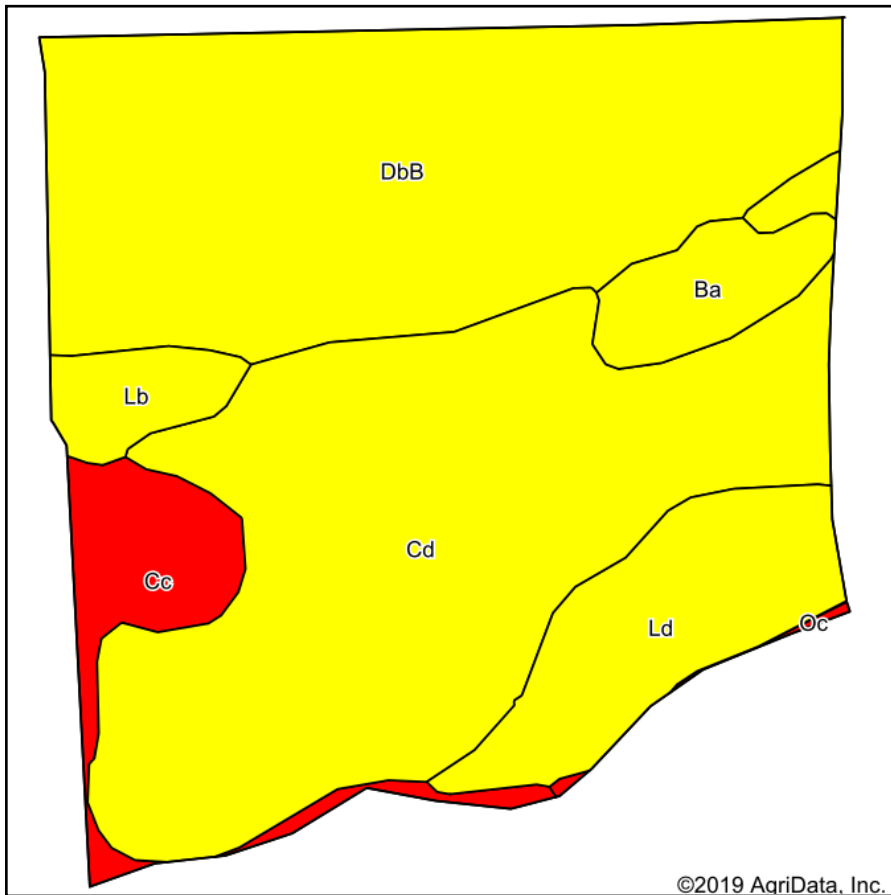

Soils data provided by USDA and NRCS.

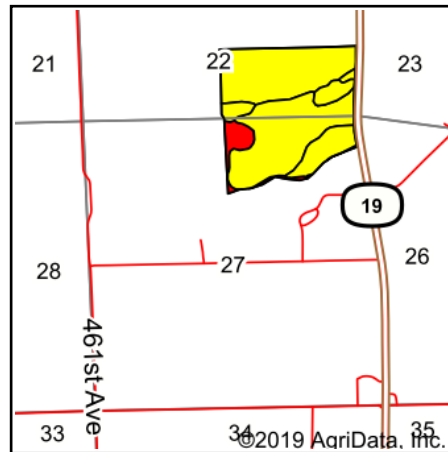

State: **South Dakota**
 County: **Clay**
 Location: **22-95N-52W**
 Township: **Riverside**
 Acres: **130.52**
 Date: **8/22/2019**



Maps Provided By:



© AgriData, Inc. 2019

www.AgriDataInc.com

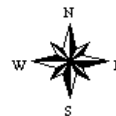

Area Symbol: SD027. Soil Area Version: 21								
Code	Soil Description	Acres	Percent of field	PI Legend	Non-Irr Class *c	Irr Class *c	Productivity Index	
Cd	Clamo silty clay, 0 to 1 percent slopes	52.55	40.3%		IVw		61	
DbB	Dalesburg-Dimo complex, 1 to 4 percent slopes	48.77	37.4%		Ile		68	
Ld	Lamo-Baltic silty clay loams, 0 to 2 percent slopes	12.55	9.6%		IIw		64	
Cc	Chaska silt loam, channeled	7.68	5.9%		VIw		38	
Ba	Baltic silty clay loam, 0 to 1 percent slopes	5.09	3.9%		IIIw		61	
Lb	Lamo silty clay loam, cool, 0 to 2 percent slopes, occasionally flooded	3.64	2.8%		IIw	IIw	70	
Oc	Orthents, channelized	0.24	0.2%		VIII _s		8	
Weighted Average								62.7

*c: Using Capabilities Class Dominant Condition Aggregation Method
 Soils data provided by USDA and NRCS.