

Soils Map

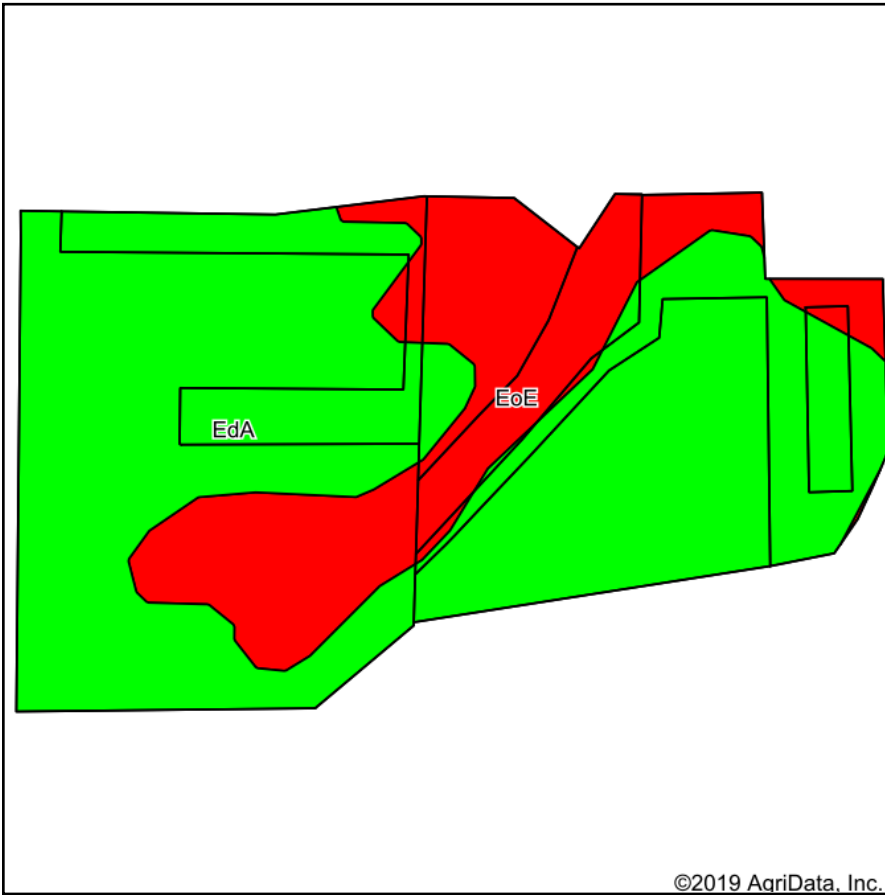

©2019 AgriData, Inc.

Soils data provided by USDA and NRCS.

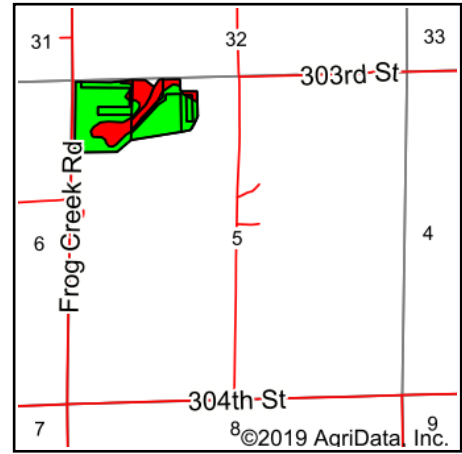

State: **South Dakota**
 County: **Clay**
 Location: **5-94N-52W**
 Township: **Riverside**
 Acres: **41.31**
 Date: **8/22/2019**



Maps Provided By:



© AgriData, Inc. 2019

www.AgriDataInc.com



Area Symbol: SD027. Soil Area Version: 21						
Code	Soil Description	Acres	Percent of field	PI Legend	Non-Irr Class *c	Productivity Index
EdA	Egan-Clarno-Trent complex, 0 to 2 percent slopes	30.38	73.5%		Iw	90
EoE	Betts-Ethan loams, 15 to 40 percent slopes	10.93	26.5%		Vllc	18
Weighted Average						70.9

*c: Using Capabilities Class Dominant Condition Aggregation Method
 Soils data provided by USDA and NRCS.