

Tillable Soils Map

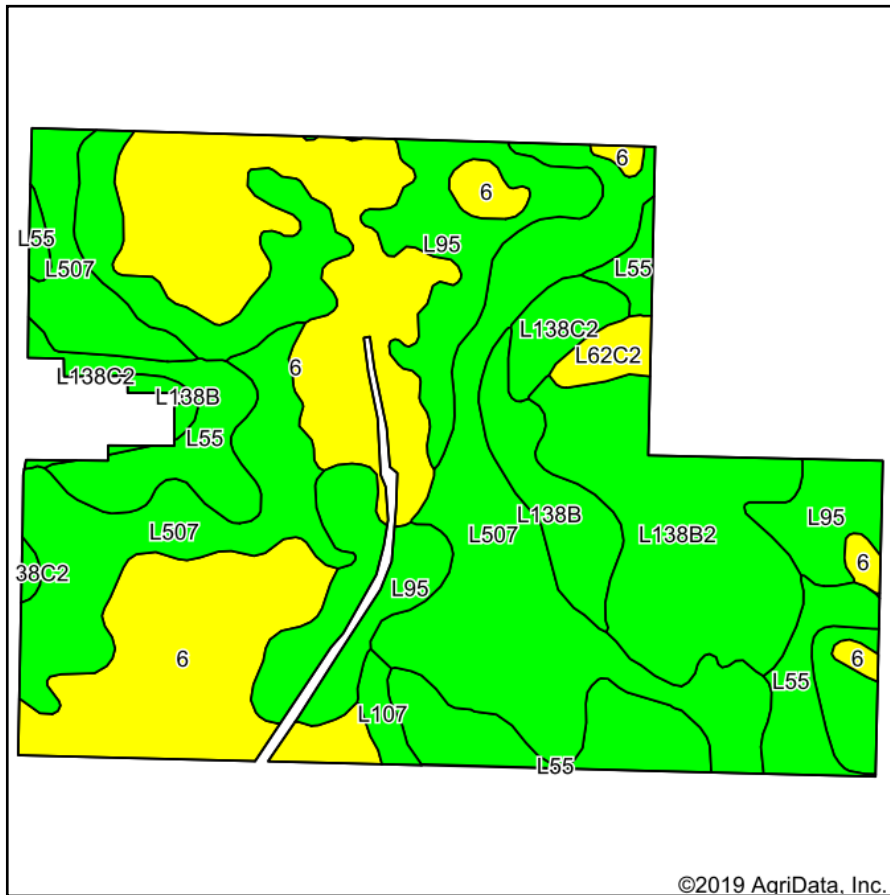

Soils data provided by USDA and NRCS.

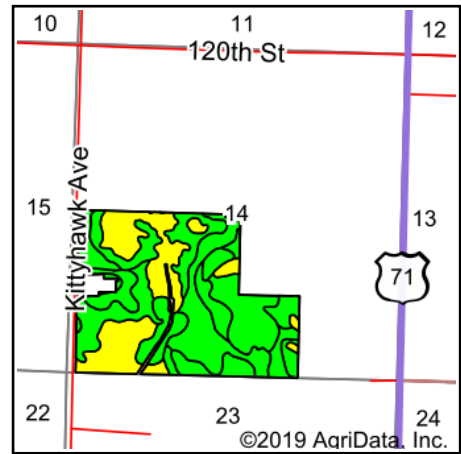

State: **Iowa**
 County: **Carroll**
 Location: **14-85N-35W**
 Township: **Kniest**
 Acres: **179.82**
 Date: **9/5/2019**

PC PEOPLES™
COMPANY
 INNOVATIVE. REAL ESTATE. SOLUTIONS.

Maps Provided By:

surety®
 CUSTOMIZED ONLINE MAPPING
 © AgriData, Inc. 2019 www.AgriDataInc.com



Area Symbol: IA027, Soil Area Version: 23

Code	Soil Description	Acres	Percent of field	CSR2 Legend	Non-Irr Class *c	CSR2**	CSR	*n NCCPI Overall
L507	Canisteo clay loam, Bemis moraine, 0 to 2 percent slopes	50.39	28.0%		IIw	87		79
6	Okoboji silty clay loam, 0 to 1 percent slopes	45.64	25.4%		IIIw	59	57	80
L95	Harps clay loam, Bemis moraine, 0 to 2 percent slopes	30.69	17.1%		IIw	75		76
L55	Nicollet loam, 1 to 3 percent slopes	20.54	11.4%		Ie	91		83
L138B2	Clarion loam, Bemis moraine, 2 to 6 percent slopes, moderately eroded	18.94	10.5%		Ile	85		63
L138B	Clarion loam, Bemis moraine, 2 to 6 percent slopes	6.76	3.8%		Ile	88		79
L138C2	Clarion loam, Bemis moraine, 6 to 10 percent slopes, moderately eroded	3.58	2.0%		IIIe	83		60
L62C2	Storden loam, Bemis moraine, 6 to 10 percent slopes, moderately eroded	1.89	1.1%		IIIe	64		63
L107	Webster clay loam, Bemis moraine, 0 to 2 percent slopes	1.39	0.8%		IIw	88		80
Weighted Average						77.8	*-	*n 77

**IA has updated the CSR values for each county to CSR2.

*- CSR weighted average cannot be calculated on the current soils data, use prior data version for csr values.

*n: The aggregation method is "Weighted Average using major components"

*c: Using Capabilities Class Dominant Condition Aggregation Method

Soils data provided by USDA and NRCS.