

# Soils Map

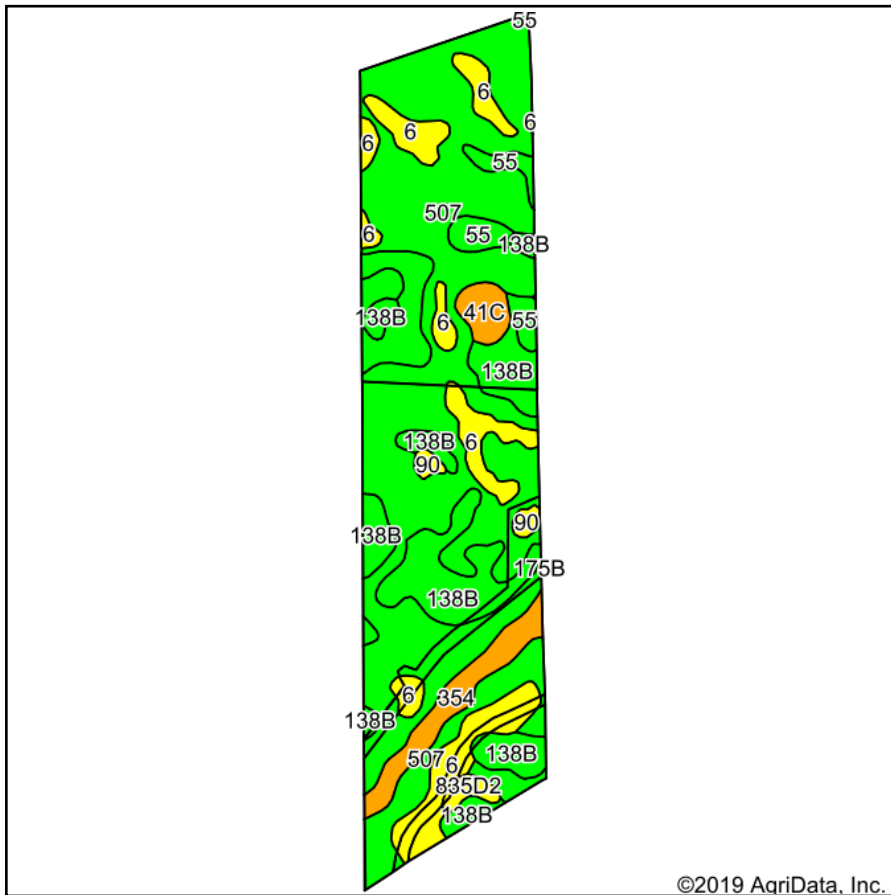

Soils data provided by USDA and NRCS.

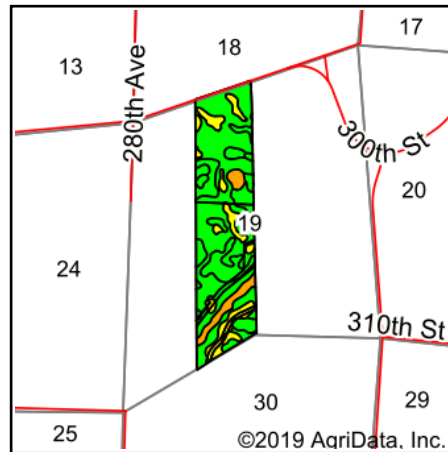

State: **Iowa**  
 County: **Clay**  
 Location: **19-97N-35W**  
 Township: **Lake**  
 Acres: **116.3**  
 Date: **9/6/2019**



Maps Provided By:

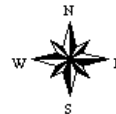

Area Symbol: IA041, Soil Area Version: 28								
Code	Soil Description	Acres	Percent of field	CSR2 Legend	Non-Irr Class *c	CSR2**	CSR	
507	Canisteo clay loam, 0 to 2 percent slopes	65.38	56.2%		IIw	84	73	
138B	Clarion loam, 2 to 6 percent slopes	18.57	16.0%		IIe	89	74	
6	Okoboji silty clay loam, 0 to 1 percent slopes	14.90	12.8%		IIIw	59	55	
55	Nicollet clay loam, 1 to 3 percent slopes	8.00	6.9%		Iw	89	82	
354	Aquolls (marsh), ponded, 0 to 1 percent slopes	5.24	4.5%		VIIIw	9	5	
41C	Sparta loamy sand, 5 to 9 percent slopes	2.11	1.8%		VI s	35	5	
90	Okoboji mucky silty clay loam, 0 to 1 percent slopes	1.08	0.9%		IIIw	56	57	
835D2	Omsrud-Storden complex, 10 to 16 percent slopes, moderately eroded	1.02	0.9%		IVe	53	46	
<b>Weighted Average</b>						<b>77.1</b>	<b>66.8</b>	

\*\*IA has updated the CSR values for each county to CSR2.

\*c: Using Capabilities Class Dominant Condition Aggregation Method

Soils data provided by USDA and NRCS.