

# Soils Map

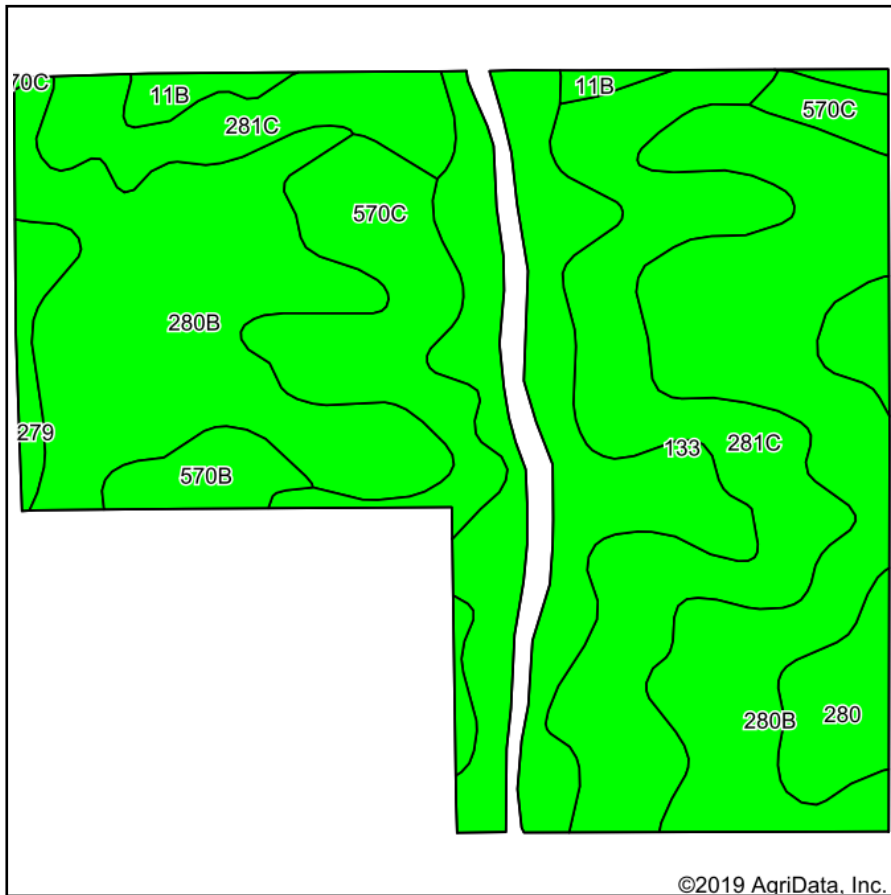

Soils data provided by USDA and NRCS.

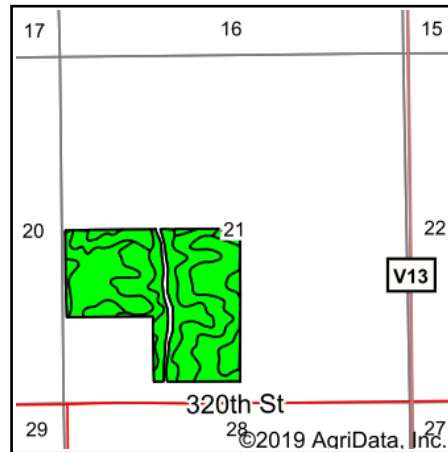

State: **Iowa**  
 County: **Mahaska**  
 Location: **21-74N-14W**  
 Township: **Cedar**  
 Acres: **106.77**  
 Date: **10/1/2019**



Maps Provided By:



| Area Symbol: IA123. Soil Area Version: 24 |   |       |                  |             |                  |             |             |
|---|---|-------|------------------|-------------|------------------|-------------|-------------|
| Code                                      | Soil Description  | Acres | Percent of field | CSR2 Legend | Non-Irr Class *c | CSR2**      | CSR         |
| 280B                                      | Mahaska silty clay loam, 2 to 5 percent slopes                    | 40.86 | 38.3%            |             | Ile              | 89          | 92          |
| 281C                                      | Otley silty clay loam, 5 to 9 percent slopes                      | 25.43 | 23.8%            |             | IIle             | 85          | 77          |
| 133                                       | Colo silty clay loam, 0 to 2 percent slopes, occasionally flooded | 18.15 | 17.0%            |             | IIw              | 78          | 80          |
| 570C                                      | Nira silty clay loam, 5 to 9 percent slopes                       | 11.35 | 10.6%            |             | IIIle            | 76          | 72          |
| 280                                       | Mahaska silty clay loam, 0 to 2 percent slopes                    | 4.95  | 4.6%             |             | Iw               | 94          | 97          |
| 570B                                      | Nira silty clay loam, 2 to 5 percent slopes                       | 2.45  | 2.3%             |             | Ile              | 81          | 87          |
| 11B                                       | Colo-Ely complex, 0 to 5 percent slopes                           | 1.83  | 1.7%             |             | IIw              | 86          | 68          |
| 279                                       | Taintor silty clay loam, 0 to 2 percent slopes                    | 1.75  | 1.6%             |             | IIw              | 83          | 88          |
| <b>Weighted Average</b>                   |   |       |                  |             |                  | <b>84.7</b> | <b>83.9</b> |

\*\*IA has updated the CSR values for each county to CSR2.

\*c: Using Capabilities Class Dominant Condition Aggregation Method

Soils data provided by USDA and NRCS.