

Soils Map

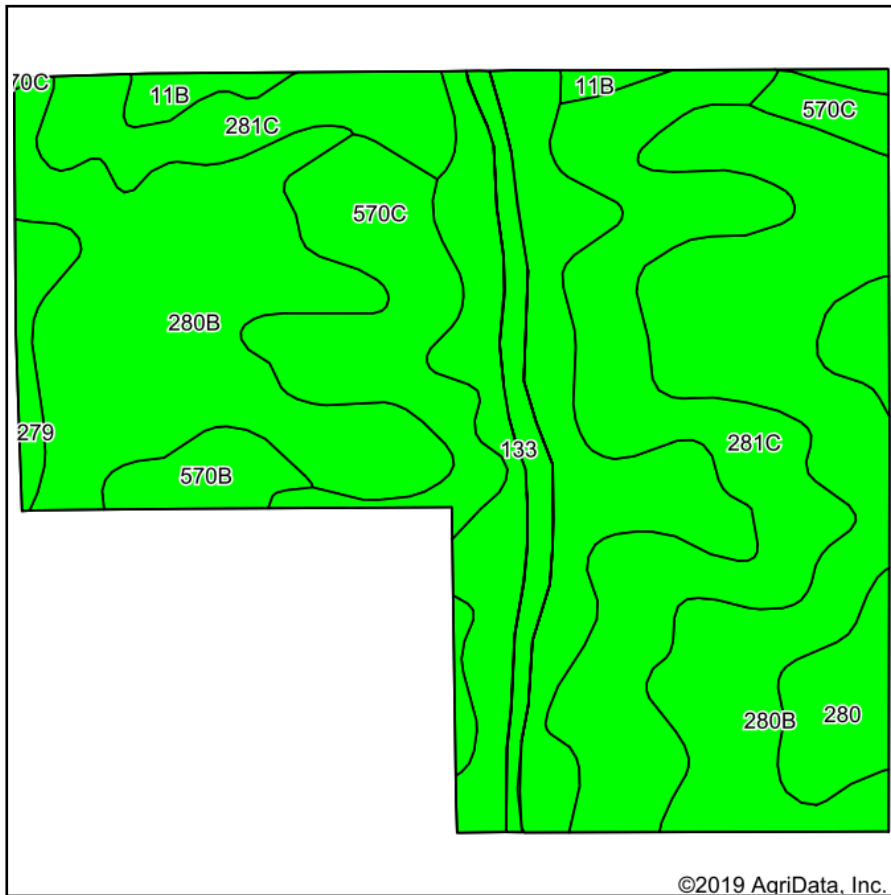

Soils data provided by USDA and NRCS.

©2019 AgriData, Inc.

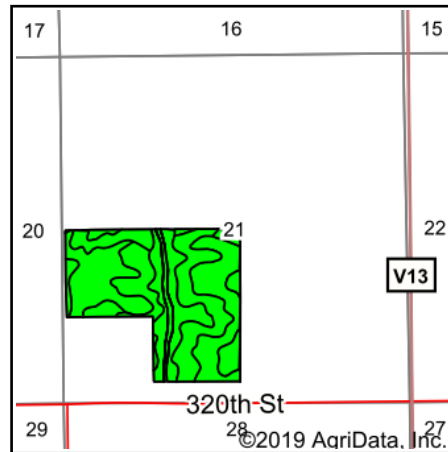

State: **Iowa**
 County: **Mahaska**
 Location: **21-74N-14W**
 Township: **Cedar**
 Acres: **110.18**
 Date: **10/1/2019**



Maps Provided By:



© AgriData, Inc. 2019

www.AgriDataInc.com



Area Symbol: IA123. Soil Area Version: 24							
Code	Soil Description	Acres	Percent of field	CSR2 Legend	Non-Irr Class *c	CSR2**	CSR
280B	Mahaska silty clay loam, 2 to 5 percent slopes	40.89	37.1%		Ile	89	92
281C	Otley silty clay loam, 5 to 9 percent slopes	25.43	23.1%		IIIe	85	77
133	Colo silty clay loam, 0 to 2 percent slopes, occasionally flooded	21.53	19.5%		IIw	78	80
570C	Nira silty clay loam, 5 to 9 percent slopes	11.35	10.3%		IIIe	76	72
280	Mahaska silty clay loam, 0 to 2 percent slopes	4.95	4.5%		Iw	94	97
570B	Nira silty clay loam, 2 to 5 percent slopes	2.45	2.2%		Ile	81	87
11B	Colo-Ely complex, 0 to 5 percent slopes	1.83	1.7%		IIw	86	68
279	Taintor silty clay loam, 0 to 2 percent slopes	1.75	1.6%		IIw	83	88
Weighted Average						84.5	83.8

**IA has updated the CSR values for each county to CSR2.

*c: Using Capabilities Class Dominant Condition Aggregation Method

Soils data provided by USDA and NRCS.