

# Est. Tillable Soils Map

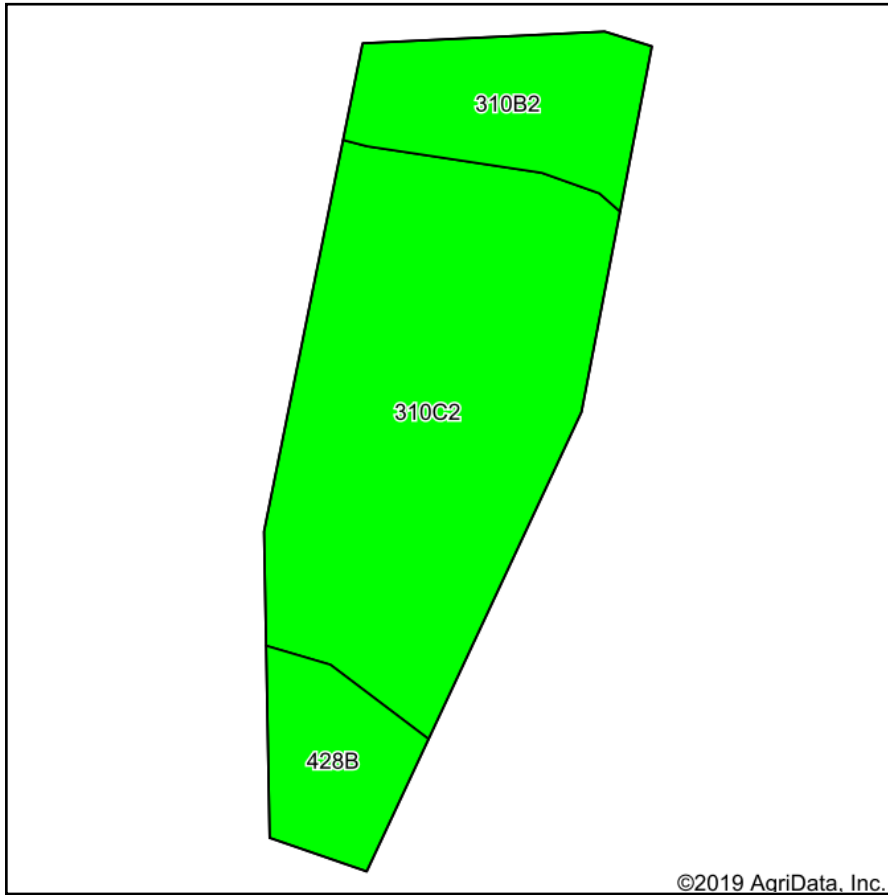

Soils data provided by USDA and NRCS.

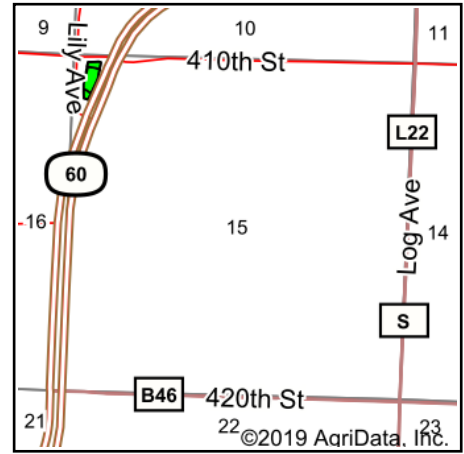

State: **Iowa**  
 County: **Sioux**  
 Location: **15-95N-43W**  
 Township: **Floyd**  
 Acres: **2.31**  
 Date: **2/19/2020**



Maps Provided By:



Area Symbol: IA167. Soil Area Version: 29

Code	Soil Description	Acres	Percent of field	CSR2 Legend	Non-Irr Class *c	CSR2**	CSR	*n NCCPI Overall
310C2	Galva silty clay loam, 5 to 9 percent slopes, eroded	1.60	69.3%		IIIe	84	51	61
310B2	Galva silty clay loam, 2 to 5 percent slopes, eroded	0.43	18.6%		Ile	90	65	63
428B	Ely silty clay loam, shallow loess, 2 to 5 percent slopes	0.28	12.1%		Ile	88	70	92
Weighted Average						85.6	55.9	*n 65.1

\*\*IA has updated the CSR values for each county to CSR2.

\*n: The aggregation method is "Weighted Average using major components"

\*c: Using Capabilities Class Dominant Condition Aggregation Method

Soils data provided by USDA and NRCS.