

Total Soils Map

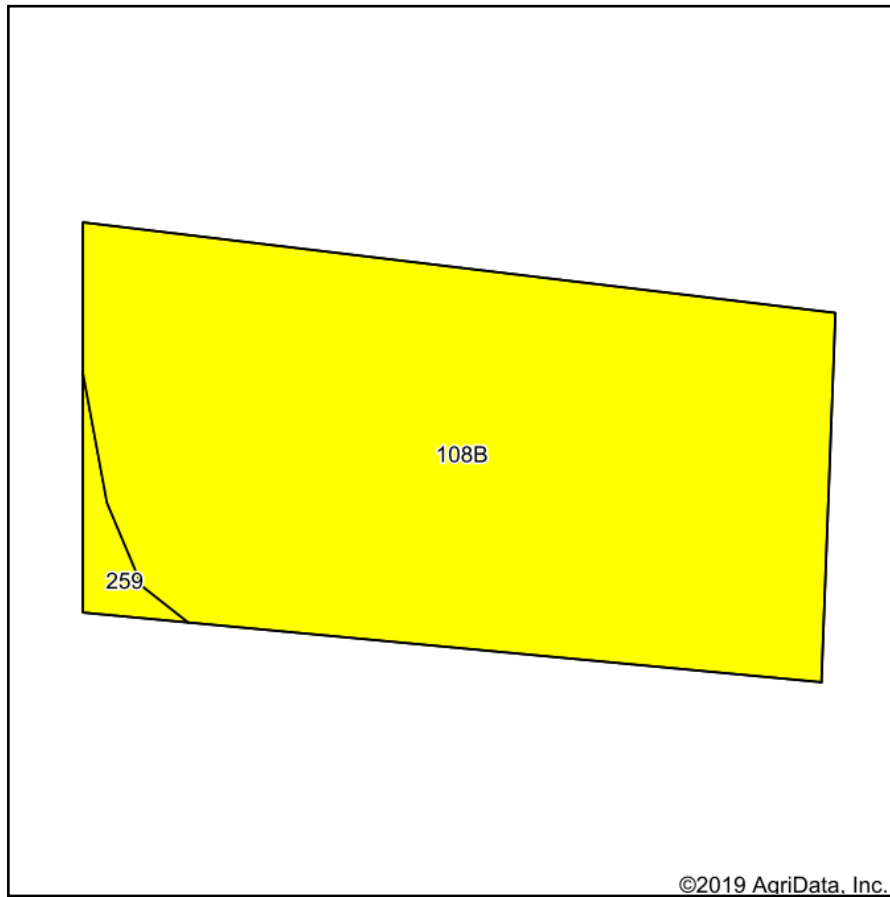

Soils data provided by USDA and NRCS.



State: **Iowa**
 County: **Clay**
 Location: **10-96N-37W**
 Township: **Riverton**
 Acres: **0.53**
 Date: **12/10/2019**



Maps Provided By:



Area Symbol: IA041, Soil Area Version: 29								
Code	Soil Description	Acres	Percent of field	CSR2 Legend	Non-Irr Class *c	CSR2**	CSR	*n NCCPI Overall
108B	Wadena loam, 2 to 6 percent slopes	0.53	100.0%		Ile	52	47	65
Weighted Average						52	47	*n 65

**IA has updated the CSR values for each county to CSR2.

*n: The aggregation method is "Weighted Average using major components"

*c: Using Capabilities Class Dominant Condition Aggregation Method

Soils data provided by USDA and NRCS.