

Soils Map

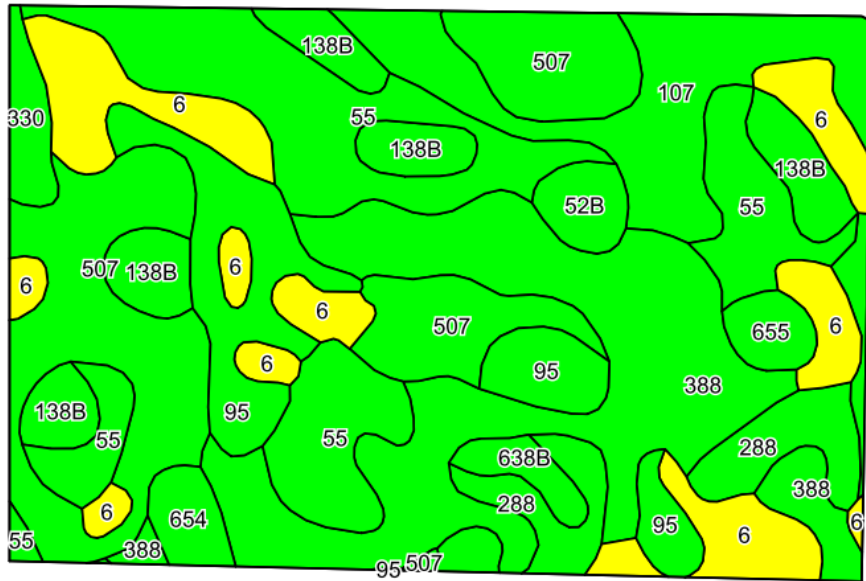

©2018 AgriData, Inc.

Soils data provided by USDA and NRCS.

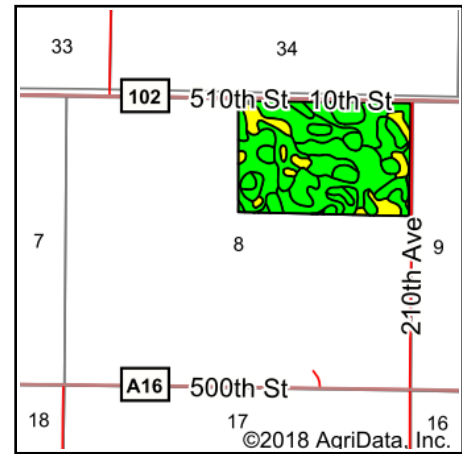

State: **Iowa**
 County: **Kossuth**
 Location: **8-100N-27W**
 Township: **Hebron**
 Acres: **103.44**
 Date: **4/30/2018**

PEOPLES COMPANY
 INNOVATIVE. REAL ESTATE. SOLUTIONS.

Maps Provided By:

surety
 CUSTOMIZED ONLINE MAPPING
 © AgriData, Inc. 2018 www.AgriDataInc.com



Area Symbol: IA109, Soil Area Version: 23

Cod e	Soil Description	Acres	Percent of field	CSR2 Legend	Non-Irr Class *c	CSR2**	CS R	NCCPI Overall
388	Kossuth silty clay loam, 0 to 2 percent slopes	21.07	20.4%		IIw	86	75	90
55	Nicollet clay loam, 1 to 3 percent slopes	17.78	17.2%		Iw	89	85	82
507	Canisteo clay loam, 0 to 2 percent slopes	17.01	16.4%		IIw	84	75	79
6	Okoboji silty clay loam, 0 to 1 percent slopes	11.93	11.5%		IIIw	59	54	80
107	Webster clay loam, 0 to 2 percent slopes	8.85	8.6%		IIw	86	80	80
95	Harps clay loam, 0 to 2 percent slopes	8.37	8.1%		IIw	72	60	77
138B	Clarion loam, 2 to 6 percent slopes	6.64	6.4%		Ile	89	77	83
288	Ottosen clay loam, 1 to 3 percent slopes	5.08	4.9%		Iw	91	78	85
330	Kingston silty clay loam, 1 to 3 percent slopes	1.48	1.4%		Iw	95	81	89
52B	Bode clay loam, 2 to 6 percent slopes	1.46	1.4%		Ile	91	75	80
654	Corwith loam, 1 to 3 percent slopes	1.39	1.3%		Iw	83	74	84
655	Crippin loam, 1 to 3 percent slopes	1.25	1.2%		Ile	91	80	84
638B	Clarion-Swanlake complex, 2 to 6 percent slopes	1.13	1.1%		Ile	85	71	82
Weighted Average						82.6	73.9	82.7

**IA has updated the CSR values for each county to CSR2.

*c: Using Capabilities Class Dominant Condition Aggregation Method

Soils data provided by USDA and NRCS.