

Total Soils Map

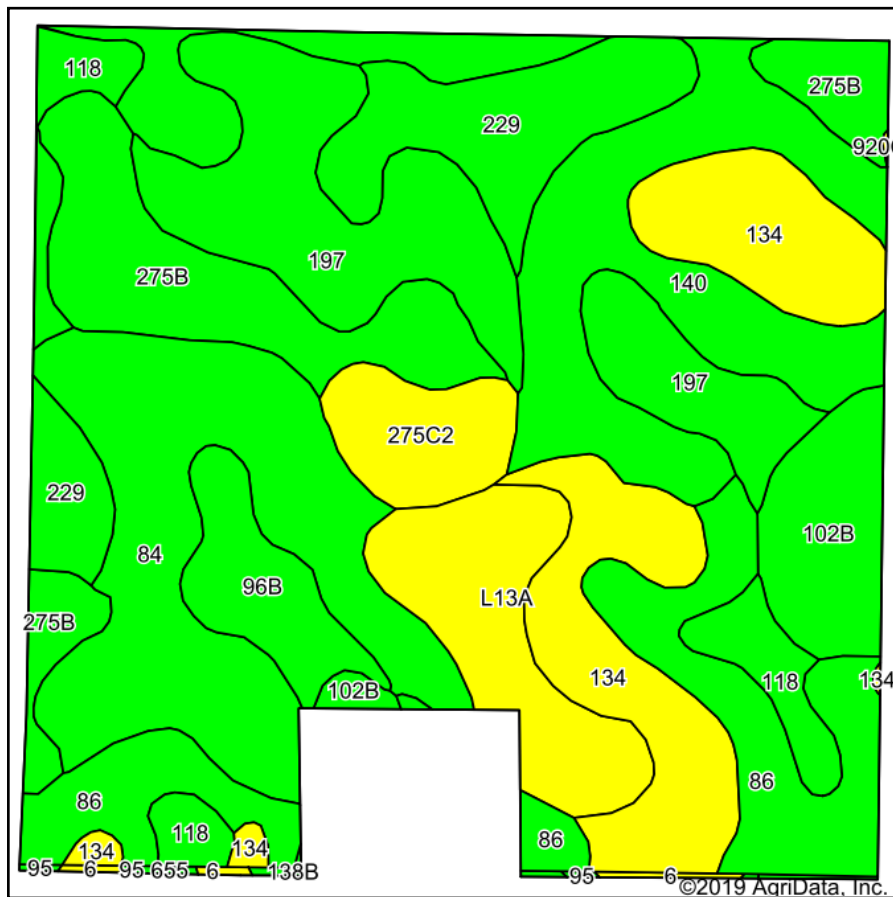

Soils data provided by USDA and NRCS.

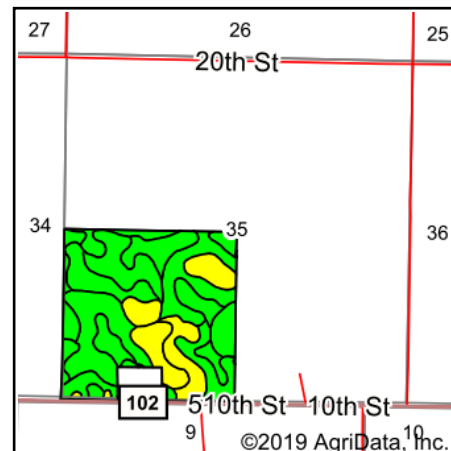

State: **Minnesota**
 County: **Faribault**
 Location: **35-101N-27W**
 Township: **Elmore**
 Acres: **151.43**
 Date: **2/25/2020**

PC PEOPLES
 COMPANY
 INNOVATIVE. REAL ESTATE. SOLUTIONS.

Maps Provided By:
surety
 CUSTOMIZED ONLINE MAPPING
 © AgriData, Inc. 2019 www.AgriDataInc.com

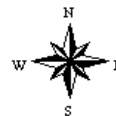

Area Symbol: IA109, Soil Area Version: 26

Area Symbol: MN043, Soil Area Version: 16

Code	Soil Description	Acres	Percent of field	Non-Irr Class Legend	Non-Irr Class *c	Productivity Index	*n NCCPI Overall
84	Brownton silty clay loam, 0 to 2 percent slopes	21.63	14.3%		IIw	81	64
140	Spicer silty clay loam, 0 to 2 percent slopes	21.50	14.2%		IIw	91	85
197	Kingston silty clay loam, 1 to 3 percent slopes	18.07	11.9%		Iw	100	89
134	Okoboji silty clay loam, 0 to 1 percent slopes	17.33	11.4%		IIIw	86	80
275B	Ocheyedan loam, 2 to 6 percent slopes	14.94	9.9%		Ile	93	80
86	Canisteo clay loam, 0 to 2 percent slopes	14.83	9.8%		IIw	93	79
229	Waldorf silty clay loam, 0 to 2 percent slopes	12.01	7.9%		IIw	85	67
L13A	Klossner muck, 0 to 1 percent slopes	9.07	6.0%		IIIw	77	88
102B	Clarion loam, 2 to 6 percent slopes	6.53	4.3%		Ile	95	83
118	Crippin loam, 1 to 3 percent slopes	5.12	3.4%		Ie	100	84
96B	Collinwood silty clay loam, 2 to 6 percent slopes	4.90	3.2%		Ile	86	70
275C2	Ocheyedan loam, 6 to 12 percent slopes, eroded	4.71	3.1%		IIIe	82	63
6	Okoboji silty clay loam, 0 to 1 percent slopes	0.34	0.2%		IIIw		80
507	Canisteo clay loam, 0 to 2 percent slopes	0.21	0.1%		IIw		79
95	Harps clay loam, 0 to 2 percent slopes	0.15	0.1%		IIw		77
655	Crippin loam, 1 to 3 percent slopes	0.09	0.1%		Ie		84
Weighted Average						88.7	*n 78.3

*n: The aggregation method is "Weighted Average using major components"

*c: Using Capabilities Class Dominant Condition Aggregation Method

Soils data provided by USDA and NRCS.