

# Total Soils Map

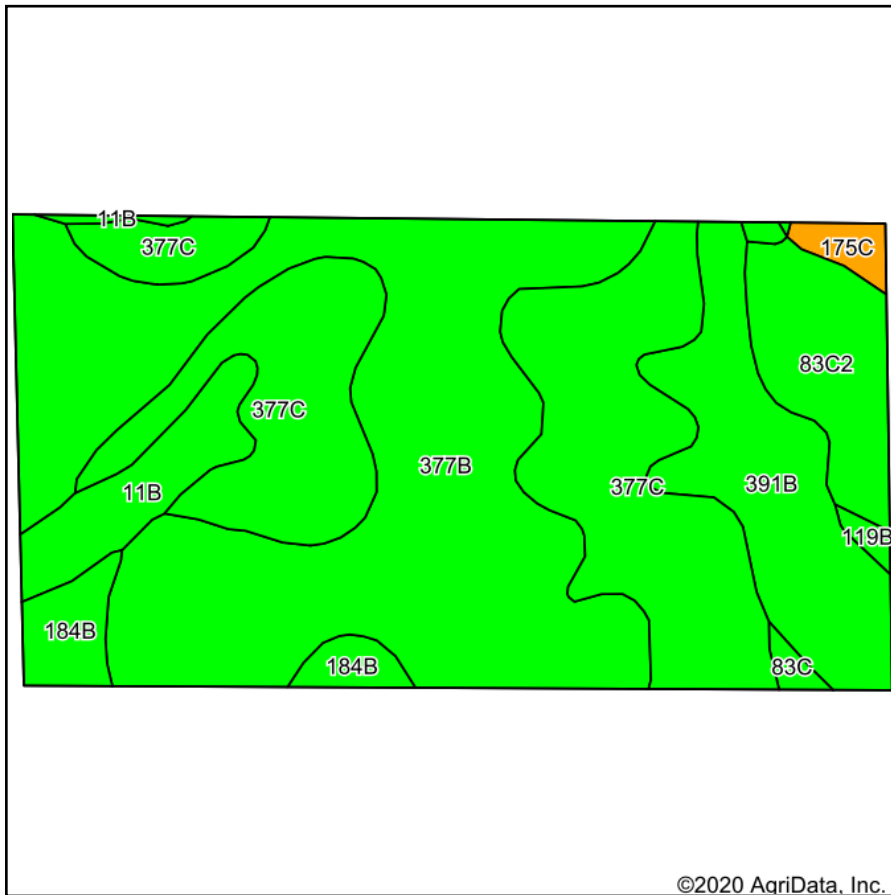

Soils data provided by USDA and NRCS.

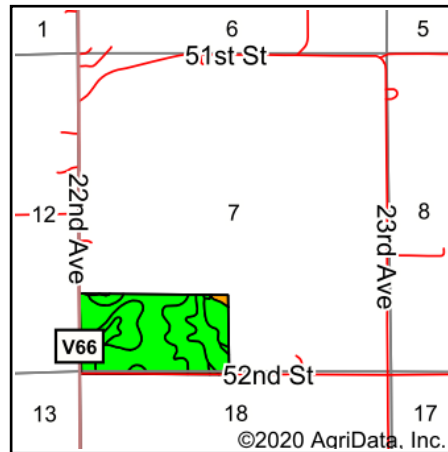

State: **Iowa**  
 County: **Benton**  
 Location: **7-86N-10W**  
 Township: **Cedar**  
 Acres: **74**  
 Date: **7/6/2020**



Maps Provided By:

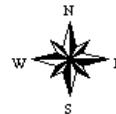

Area Symbol: IA011. Soil Area Version: 22								
Code	Soil Description	Acres	Percent of field	CSR2 Legend	Non-Irr Class *c	CSR2**	CSR	
377B	Dinsdale silty clay loam, 2 to 5 percent slopes	31.46	42.5%		Ile	94	90	
377C	Dinsdale silty clay loam, 5 to 9 percent slopes	21.61	29.2%		IIle	90	75	
391B	Clyde-Floyd complex, 1 to 4 percent slopes	8.51	11.5%		IIw	87	74	
83C2	Kenyon loam, 5 to 9 percent slopes, eroded	4.89	6.6%		IIle	84	70	
11B	Colo-Ely complex, 0 to 5 percent slopes	3.62	4.9%		IIw	86	68	
184B	Klinger silty clay loam, 1 to 4 percent slopes	2.51	3.4%		Iw	95	91	
175C	Dickinson fine sandy loam, 5 to 9 percent slopes	0.75	1.0%		IIle	45	40	
83C	Kenyon loam, 5 to 9 percent slopes	0.35	0.5%		IIle	85	72	
119B	Muscatine silty clay loam, 2 to 5 percent slopes	0.30	0.4%		Ile	95	95	
<b>Weighted Average</b>						<b>90.5</b>	<b>80.8</b>	

\*\*IA has updated the CSR values for each county to CSR2.  
 \*c: Using Capabilities Class Dominant Condition Aggregation Method  
 Soils data provided by USDA and NRCS.