

Tillable Soils Map

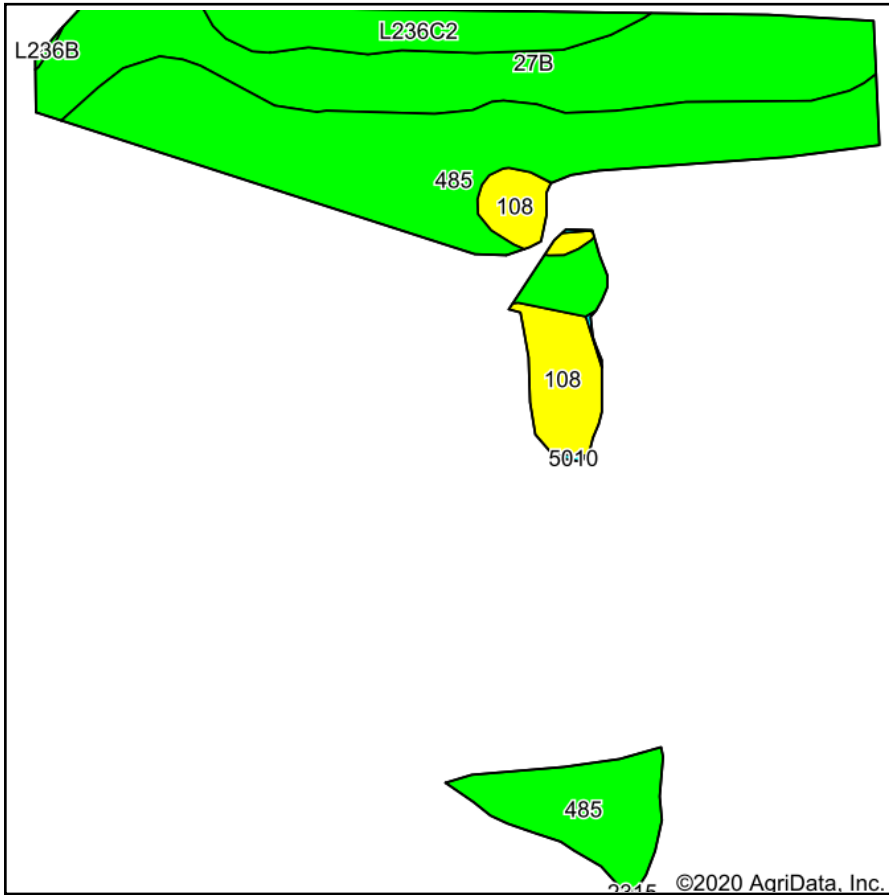

Soils data provided by USDA and NRCS.

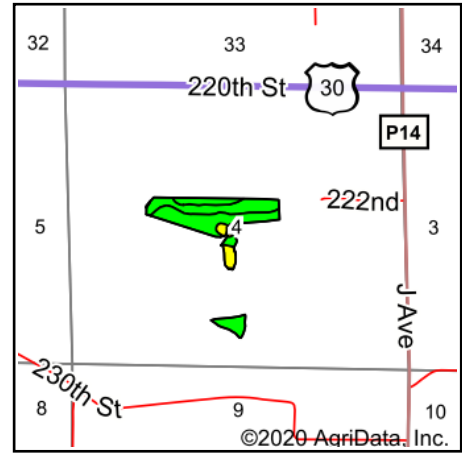

State: **Iowa**
 County: **Greene**
 Location: **4-83N-31W**
 Township: **Jackson**
 Acres: **24.07**
 Date: **7/15/2020**



Maps Provided By:



Area Symbol: IA073. Soil Area Version: 25								
Code	Soil Description	Acres	Percent of field	CSR2 Legend	Non-Irr Class *c	CSR2**	CSR	
485	Spillville loam, 0 to 2 percent slopes, occasionally flooded	11.89	49.4%		Ilw	88	91	
27B	Terril loam, 2 to 6 percent slopes	7.87	32.7%		Ile	87	83	
L236C2	Lester loam, Bemis moraine, 6 to 10 percent slopes, moderately eroded	2.26	9.4%		Ille	77		
108	Wadena loam, 0 to 2 percent slopes	2.05	8.5%		Ils	56	56	
Weighted Average						83.9	*-	

**IA has updated the CSR values for each county to CSR2.

*- CSR weighted average cannot be calculated on the current soils data, use prior data version for csr values.

*c: Using Capabilities Class Dominant Condition Aggregation Method

Soils data provided by USDA and NRCS.