

Tillable Soils Map

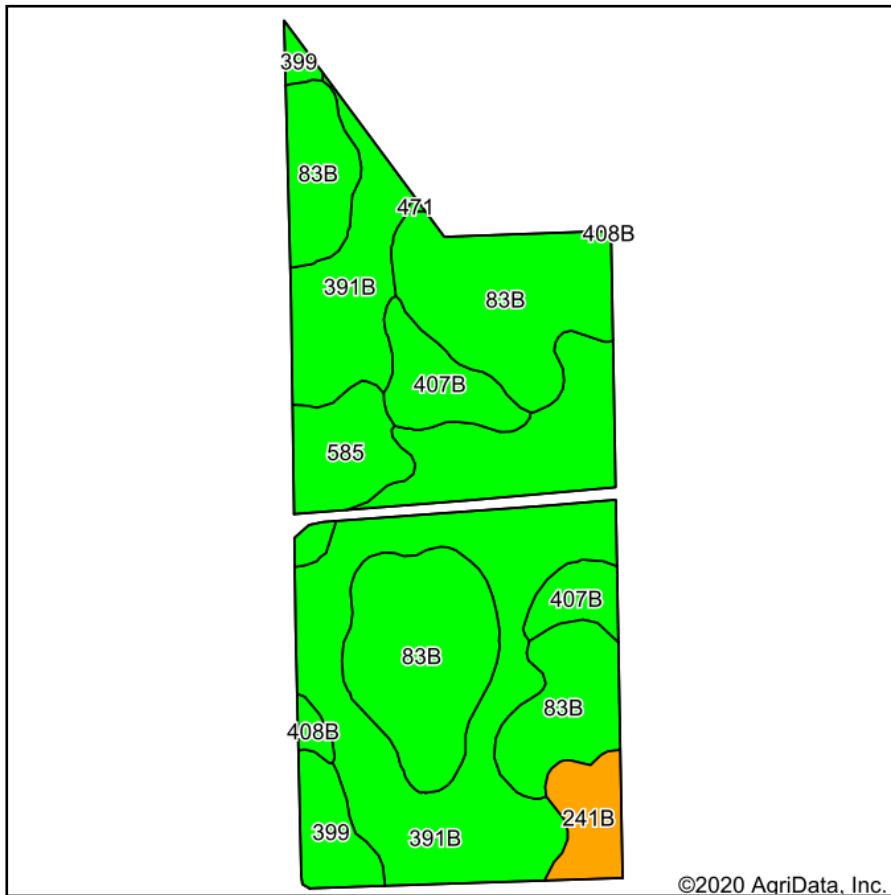

Soils data provided by USDA and NRCS.

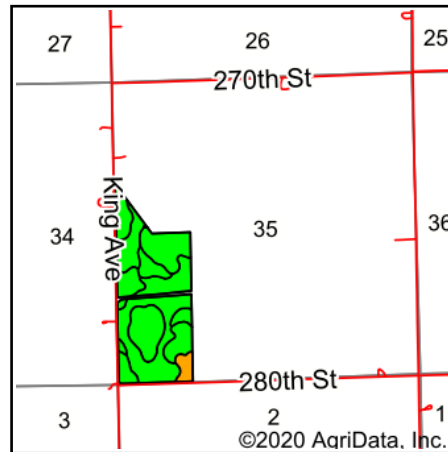

State: **Iowa**
 County: **Buchanan**
 Location: **35-88N-9W**
 Township: **Sumner**
 Acres: **82.85**
 Date: **7/22/2020**



| Area Symbol: IA019. Soil Area Version: 25 | | | | | | | | |
|---|--|-------|------------------|-------------|------------------|--------------|-------------|------------------|
| Code | Soil Description | Acres | Percent of field | CSR2 Legend | Non-Irr Class *c | Irr Class *c | CSR2** | *n NCCPI Overall |
| 391B | Clyde-Floyd complex, 1 to 4 percent slopes | 35.23 | 42.5% | | | IIw | 87 | 88 |
| 83B | Kenyon loam, 2 to 5 percent slopes | 30.38 | 36.7% | | | Ile | 90 | 84 |
| 407B | Schley loam, 1 to 4 percent slopes | 5.63 | 6.8% | | | IIw | 81 | 84 |
| 585 | Spillville-Coland complex, 0 to 2 percent slopes | 4.74 | 5.7% | | | IIw | 76 | 94 |
| 399 | Readlyn silt loam, 1 to 3 percent slopes | 3.33 | 4.0% | | | Iw | 91 | 76 |
| 241B | Burkhardt-Saude complex, 2 to 5 percent slopes | 2.97 | 3.6% | | | IVe | Ile | 33 |
| 408B | Olin fine sandy loam, 2 to 5 percent slopes | 0.57 | 0.7% | | | Ile | 74 | 77 |
| Weighted Average | | | | | | | 85.2 | *n 84.9 |

**IA has updated the CSR values for each county to CSR2.
 *n: The aggregation method is "Weighted Average using major components"
 *c: Using Capabilities Class Dominant Condition Aggregation Method
 Soils data provided by USDA and NRCS.